

For more details on our fares please visit our web site at Broward.org/BCT or call customer service: 954.357.8400.

Reading a Timetable - It's Easy

1. The map shows the exact bus route.
2. Major route intersections are called time points. Time points are shown with the symbol □.
3. The timetable lists major time points for bus route. Listed under time points are scheduled departure times.
4. Reading from left to right, indicates the time for each bus trip.
5. The bus picks up and drops off riders at all BCT bus stop signs along the route where there is a Broward County bus stop sign.
6. Arrive at the bus stop five minutes early. Buses operate as close to published timetables as traffic conditions allow.

Not paying your fare is a crime per Florida Statute 812.015. Violation constitutes a misdemeanor, punishable by jail time and/or a fine.

Information: 954.357.8400

Hearing-speech impaired/TTY: 954.357.8302

This publication can be made available in alternative formats upon request by contacting 954-357-8400 or TTY 954-357-8302.



This symbol is used on bus stop signs to indicate accessible bus stops.



BROWARD COUNTY

BOARD OF COUNTY COMMISSIONERS

An equal opportunity employer and provider of services.

5,000 copies of this public document were promulgated at a gross cost of \$230.00, or \$.046 per copy to inform the public about the Transit Division's schedule and route information. Reprinted 1/18

ROUTE 88 Weekdays Schedule

Effective 4/29/19

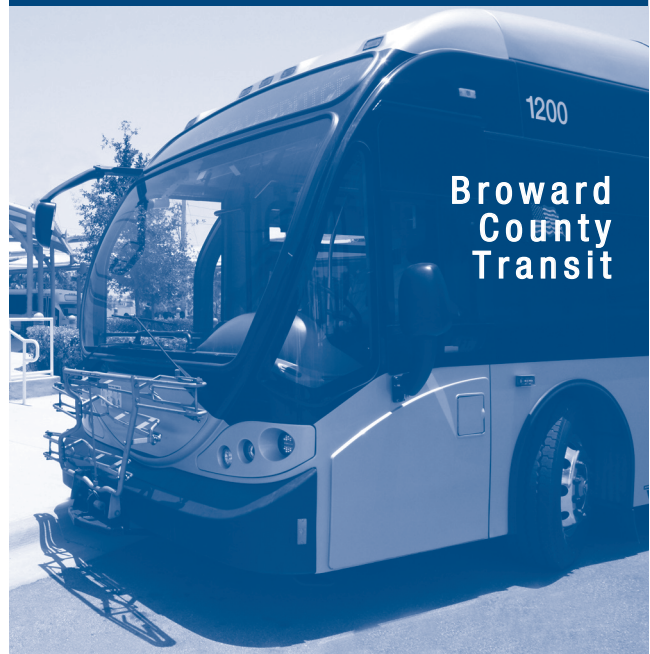

West Regional Terminal to Holmberg Road
and Coral Ridge Drive
via Pine Island Road/
Coral Springs Drive



Real Time Bus Information
MyRide.Broward.org



954-357-8400
Broward.org/BCT

MONDAY - FRIDAY

There are additional bus stops in between those listed.

NORTHBOUND

To Holmberg Road & Coral Ridge Drive

WEST REGIONAL TERMINAL	OAKLAND PARK BLVD & PINE ISLAND RD	McNAB RD & PINE ISLAND RD	SAMPLE RD & CORAL SPRINGS DR	HERON BAY PLAZA
1	2	3	4	5
615a	626a	634a	648a	656a
655a	706a	718a	736a	748a
735a	746a	758a	813a	823a
815a	827a	836a	851a	901a
855a	907a	916a	929a	937aG
930a	940a	950a	1002a	1010a
1020a	1030a	1040a	1052a	1059a
1120a	1130a	1140a	1153a	1200p
1220p	1230p	1240p	1253p	100p
120p	132p	142p	156p	205p
220p	233p	243p	300p	309p
235p	248p	258p	315p	324p
320p	333p	344p	358p	407p
400p	412p	425p	439p	448p
440p	452p	504p	519p	526p
530p	543p	553p	608p	614p
605p	618p	625p	640p	646p
710p	720p	729p	741p	748p
800p	814p	822p	835p	842pG

SOUTHBOUND

To West Regional Terminal

HERON BAY PLAZA	SAMPLE RD & CORAL SPRINGS DR	McNAB RD & PINE ISLAND RD	OAKLAND PARK BLVD & PINE ISLAND RD	WEST REGIONAL TERMINAL
5	4	3	2	1
555a	605a	618a	626a	636a
635a	647a	700a	712a	726a
710a	721a	737a	749a	803a
755a	806a	822a	834a	847a
835a	845a	900a	908a	920a
920a	930a	945a	953a	1005a
1020a	1030a	1044a	1053a	1101a
1120a	1131a	1144a	1153a	1201p
1220p	1228p	1245p	1254p	104p
120p	132p	145p	156p	205p
220p	232p	245p	255p	304p
235p	247p	300p	310p	319p
305p	317p	333p	344p	355p
330p	341p	358p	409p	420p
420p	433p	448p	459p	505p
500p	513p	528p	539p	548p
540p	551p	606p	613p	623pG
620p	631p	645p	653p	702p
700p	712p	725p	733p	742p
800p	810p	823p	831p	838pG

NUMBERS IN BOXES REFER TO TIME POINTS ON MAP

Times with the letter "G" after them indicate bus returns to garage.

ROUTE 88

West Regional Terminal to
Holmberg Road and Coral Ridge Drive
via Pine Island Road/Coral Springs Drive

POINTS OF INTEREST

- Westfield Mall
- West Regional Medical Center
- Heron Bay Plaza
- Social Security Administration

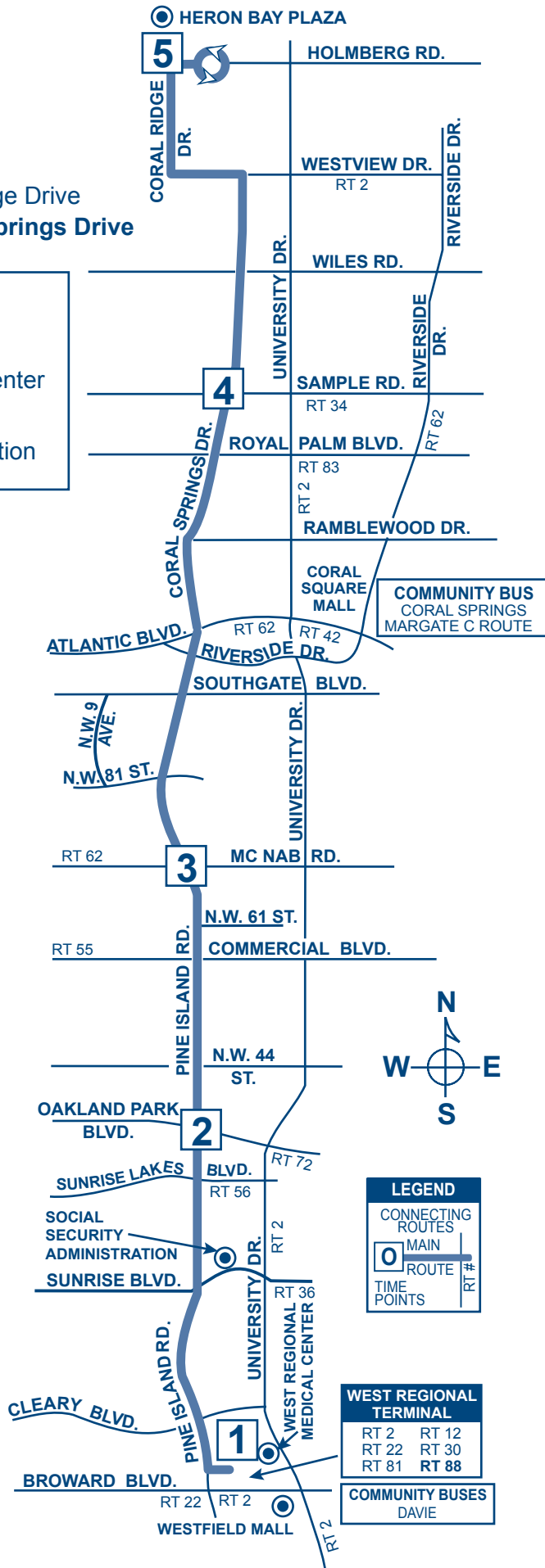

Customer Service

Monday - Friday.....7 am - 7:45 pm

Saturday, Sunday and Holidays.....8:30 am - 4:45 pm

Transit Operations Agents help with:

- Trip planning
- Routes, times and transfer information
- Identifying Bus Pass sales locations
- Special event information

Lost and Found: 954-357-8400, Monday, Tuesday, Thursday and Friday, 9:00 am - 4:00 pm

Holiday Bus Service

Sunday bus service is provided on the following observed holidays:

New Year's Day	Labor Day	Memorial Day
Independence Day	Thanksgiving Day	Christmas Day

Fares

Exact fare, dollar bill or coins required. Operators do not carry change.

Fares are: Regular, Premium Express, Senior/Youth/Disabled/Medicare.* Children (under 40 inches ride FREE)

Fare Deals

All Day Bus Pass offers unlimited rides on all routes. On sale aboard all BCT buses.

NOTE: Other cost saving passes cannot be purchased on BCT buses, but are available at the Central Bus Terminal and at authorized distributors.

10 Ride Pass: 10 Rides any time, any day. Expires after the tenth ride is taken.

7 Day Pass: Unlimited rides for seven consecutive days. Starts on the first day card is used. Expires after the seventh day.

31 Day Adult Pass: Unlimited rides for 31 consecutive days. Starts on the first day card is used.

31 Day Reduced Pass: Youth*, Seniors*, Disabled*, Medicare*, College Student*. Unlimited rides for 31 consecutive days. Starts on the first day card is used.

****Premium Express 10 Ride Pass:** 10 rides any time, any day. Expires after tenth ride is taken.

****Premium Express 31 Day Pass:** Unlimited rides for 31 consecutive days. Starts on the first day card is used.

Bus Passes are not exchangeable, refundable or transferrable. Damaged cards are invalid. Lost, stolen or damaged cards will not be replaced.

*NOTICE: Proof of age is required for Youth fare (18 years or younger) and for Senior fare (65 years or older). For College Student Bus Pass, a college photo ID card is required. For Disabled and Medicare fare, proof of disability (Medicare card) and photo I.D. is required. Eligible Senior fare patrons are encouraged to acquire their BCT Reduced Fare Photo ID cards.

** Premium Bus Pass can be purchased online at Broward.org/BCT and at select Broward County library locations.

PROTECTIONS OF TITLE VI OF THE CIVIL RIGHTS ACT OF 1964 AS AMENDED

Any person(s) or group(s) who believes that they have been subjected to discrimination because of race, color, or national origin, under any transit program or activity provided by Broward County Transit (BCT), may call 954-357-8481 to file a Title VI discrimination complaint or write to Broward County Transit Division, Compliance Manager, 1 N. University Drive, Suite 3100A, Plantation, FL 33324



TRANSIT WATCH

**WHEN IT COMES TO OUR SAFETY,
WE CAN ALWAYS USE AN EXTRA PAIR OF
EYES AND EARS. BE ALERT.
CALL 954-357-LOOK (5665). TELL US.**

TRANSFER POLICY - EFFECTIVE 7/10/11

TRANSFERS BETWEEN REGULAR BCT BUS SERVICE AND BCT EXPRESS BUS SERVICE

Passengers using any BCT bus pass and transferring from a regular BCT route, to an Express bus route, must pay a \$1.00 upgrade fee. Passengers with a Premium bus pass do not have to pay the \$1.00 upgrade fee.

Passengers paying with cash, on a regular BCT bus route, will not be able to transfer to an Express bus route without paying the full premium fare when boarding the Express bus.

Passengers using an All-Day bus pass will be required to pay the \$1.00 upgrade fee when boarding Express buses.

PREMIUM BUS PASS CUSTOMERS

The BCT 31-Day Premium Bus Pass is acceptable on all BCT regular bus routes.

TRANSFERS FROM BCT TO OTHER SOUTH FLORIDA TRANSIT SYSTEMS

When boarding a BCT bus, passenger pays the appropriate BCT fare and may request a transfer from the bus operator if transferring to Miami-Dade Transit (MDT), Palm Tran or Tri-Rail.

TRANSFERS TO BCT FROM OTHER SOUTH FLORIDA TRANSIT SYSTEMS

When transferring from MDT, Palm Tran and Tri-Rail to BCT regular fixed-route bus service, passenger pays \$.50 with a transfer issued by MDT or Palm Tran and proof of fare payment such as Easy Card and receipt issued by Tri-Rail. Tri-Rail passengers boarding BCT at any locations other than at a Tri-Rail station will be required to pay the full fare.

TRANSFERS BETWEEN OTHER SOUTH FLORIDA TRANSIT SYSTEMS AND PREMIUM EXPRESS BUS SERVICE

Transfers to MDT or Tri-Rail from Premium Express Service, a transfer is issued and passenger must pay appropriate MDT or Tri-Rail fare.

Transfer from MDT or Tri-Rail to Premium Express Service, a \$.50 transfer fee is required with the appropriate transfer from MDT or Tri-Rail.

The Premium Express Service does not connect with Palm Tran.

The Easy Card issued by MDT and Tri-Rail is not accepted as payment on any BCT bus.