

For more details on our fares please visit our web site at [Broward.org/BCT](http://Broward.org/BCT) or call customer service: 954.357.8400.

### Reading A Timetable - It's Easy

1. The map shows the exact bus route.
2. Major route intersections are called time points. Time points are shown with the symbol □.
3. The timetable lists major time points for bus route. Listed under time points are scheduled departure times.
4. Reading from left to right, indicates the time for each bus trip.
5. The bus picks up and drops off riders at all BCT bus stop signs along the route where there is a Broward County bus stop sign.
6. Arrive at the bus stop five minutes early. Buses operate as close to published timetables as traffic conditions allow.

**Not paying your fare is a crime per Florida Statute 812.015.**

**Violation constitutes a misdemeanor, punishable by jail time and/or a fine.**

Information: 954.357.8400

Hearing-speech impaired/TTY:  
954.357.8302

This publication can be made available in alternative formats upon request by contacting 954-357-8400 or TTY 954-357-8302.



This symbol is used on bus stop signs to indicate accessible bus stops.



BROWARD COUNTY  
BOARD OF COUNTY COMMISSIONERS

*An equal opportunity employer and provider of services.*

5,000 copies of this public document were promulgated at a gross cost of \$230.00, or \$.046 per copy to inform the public about the Transit Division's schedule and route information. Reprinted 5/18

# ROUTE 16 Monday - Saturday Schedule

Effective 8/27/17



Pembroke Lakes Mall to Dania Beach City Hall  
via Stirling Road



Real Time Bus Information  
[MyRide.Broward.org](http://MyRide.Broward.org)



954-357-8400  
[Broward.org/BCT](http://Broward.org/BCT)

**There are additional bus stops  
in between those listed.**

## MONDAY - FRIDAY

### EASTBOUND

To Dania Beach City Hall

PEMBROKE LAKES MALL	STIRLING RD & FLAMINGO RD	STIRLING RD & UNIVERSITY DR	STIRLING RD & US 441	FLL AIRPORT TRI-RAIL STATION	DANIA CITY HALL
1	2	3	4	5	6
5:45a	5:52a	6:01a	6:08a	6:20a	6:30a
6:15a	6:22a	6:31a	6:39a	6:52a	7:03a
6:45a	6:53a	7:03a	7:12a	7:26a	7:39a
7:15a	7:24a	7:35a	7:45a	8:00a	8:13a
7:50a	8:00a	8:12a	8:22a	8:37a	8:49a
8:25a	8:35a	8:46a	8:55a	9:08a	9:19a G
9:00a	9:08a	9:18a	9:26a	9:39a	9:50a
10:00a	10:08a	10:18a	10:26a	10:39a	10:50a
11:00a	11:08a	11:18a	11:26a	11:39a	11:50a
12:00p	12:08p	12:18p	12:26p	12:39p	12:50p
1:00p	1:08p	1:18p	1:26p	1:39p	1:50p
2:00p	2:08p	2:18p	2:26p	2:39p	2:50p
3:00p	3:09p	3:20p	3:29p	3:43p	3:55p
3:35p	3:44p	3:55p	4:04p	4:19p	4:32p
4:10p	4:20p	4:32p	4:42p	4:57p	5:10p
4:45p	4:55p	5:07p	5:17p	5:32p	5:45p
5:20p	5:30p	5:42p	5:52p	6:07p	6:19p G
6:00p	6:09p	6:20p	6:29p	6:42p	6:53p
7:00p	7:08p	7:18p	7:26p	7:39p	7:50p
8:00p	8:07p	8:16p	8:23p	8:35p	8:45p G

### WESTBOUND

To Pembroke Lakes Mall

DANIA CITY HALL	FLL AIRPORT TRI-RAIL STATION	STIRLING RD & US 441	STIRLING RD & UNIVERSITY DR	STIRLING RD & FLAMINGO RD	PEMBROKE LAKES MALL
6	5	4	3	2	1
5:45a	5:56a	6:06a	6:14a	6:22a	6:30a
6:15a	6:26a	6:37a	6:46a	6:55a	7:04a
6:45a	6:57a	7:09a	7:19a	7:29a	7:40a
7:15a	7:28a	7:41a	7:52a	8:03a	8:14a
7:50a	8:04a	8:17a	8:28a	8:38a	8:48a
8:25a	8:38a	8:50a	9:00a	9:09a	9:18a G
9:00a	9:12a	9:23a	9:32a	9:41a	9:50a
10:00a	10:12a	10:23a	10:32a	10:41a	10:50a
11:00a	11:12a	11:23a	11:32a	11:41a	11:50a
12:00p	12:12p	12:23p	12:32p	12:41p	12:50p
1:00p	1:12p	1:23p	1:32p	1:41p	1:50p
2:00p	2:12p	2:23p	2:32p	2:41p	2:50p
3:00p	3:13p	3:25p	3:35p	3:45p	3:55p
3:35p	3:48p	4:00p	4:11p	4:22p	4:33p
4:10p	4:24p	4:37p	4:48p	4:59p	5:10p
4:45p	4:59p	5:12p	5:23p	5:34p	5:45p
5:20p	5:34p	5:47p	5:58p	6:08p	6:18p G
6:00p	6:13p	6:25p	6:35p	6:44p	6:53p
7:00p	7:12p	7:23p	7:32p	7:41p	7:50p
8:00p	8:11p	8:21p	8:29p	8:37p	8:45p G

NUMBERS IN BOXES REFER TO TIME POINTS ON MAP  
Times with the letter "G" after them indicate bus returns to garage.

**There are additional bus stops  
in between those listed.**

## SATURDAY

### EASTBOUND

To Dania Beach City Hall

PEMBROKE LAKES MALL	STIRLING RD & FLAMINGO RD	STIRLING RD & UNIVERSITY DR	STIRLING RD & US 441	FLL AIRPORT TRI-RAIL STATION	DANIA CITY HALL
1	2	3	4	5	6
6:00a	6:07a	6:16a	6:23a	6:35a	6:45a
7:00a	7:08a	7:18a	7:26a	7:39a	7:50a
8:00a	8:08a	8:18a	8:26a	8:39a	8:50a
9:00a	9:08a	9:18a	9:26a	9:39a	9:50a
10:00a	10:08a	10:18a	10:26a	10:39a	10:50a
11:00a	11:08a	11:18a	11:26a	11:39a	11:50a
12:00p	12:08p	12:18p	12:26p	12:39p	12:50p
1:00p	1:08p	1:18p	1:26p	1:39p	1:50p
2:00p	2:08p	2:18p	2:26p	2:39p	2:50p
3:00p	3:08p	3:18p	3:26p	3:39p	3:50p
4:00p	4:08p	4:18p	4:26p	4:39p	4:50p
5:00p	5:08p	5:18p	5:26p	5:39p	5:50p
6:00p	6:08p	6:18p	6:26p	6:39p	6:50p
7:00p	7:07p	7:16p	7:23p	7:35p	7:45p
8:00p	8:07p	8:16p	8:23p	8:35p	8:45p G

### WESTBOUND

To Pembroke Lakes Mall

DANIA CITY HALL	FLL AIRPORT TRI-RAIL STATION	STIRLING RD & US 441	STIRLING RD & UNIVERSITY DR	STIRLING RD & FLAMINGO RD	PEMBROKE LAKES MAL.
6	5	4	3	2	1
6:00a	6:11a	6:20a	6:30a	6:38a	6:45a
7:00a	7:12a	7:22a	7:33a	7:42a	7:50a
8:00a	8:12a	8:22a	8:33a	8:42a	8:50a
9:00a	9:12a	9:22a	9:33a	9:42a	9:50a
10:00a	10:12a	10:22a	10:33a	10:42a	10:50a
11:00a	11:12a	11:22a	11:33a	11:42a	11:50a
12:00p	12:12p	12:22p	12:33p	12:42p	12:50p
1:00p	1:12p	1:22p	1:33p	1:42p	1:50p
2:00p	2:12p	2:22p	2:33p	2:42p	2:50p
3:00p	3:12p	3:22p	3:33p	3:42p	3:50p
4:00p	4:12p	4:22p	4:33p	4:42p	4:50p
5:00p	5:12p	5:22p	5:33p	5:42p	5:50p
6:00p	6:12p	6:22p	6:33p	6:42p	6:50p
7:00p	7:11p	7:20p	7:30p	7:38p	7:45p
8:00p	8:11p	8:20p	8:30p	8:38p	8:45p G

NUMBERS IN BOXES REFER TO TIME POINTS ON MAP  
Times with the letter "G" after them indicate bus returns to garage.

# ROUTE 16

Pembroke Lakes Mall to  
Dania Beach City Hall  
via Stirling Road

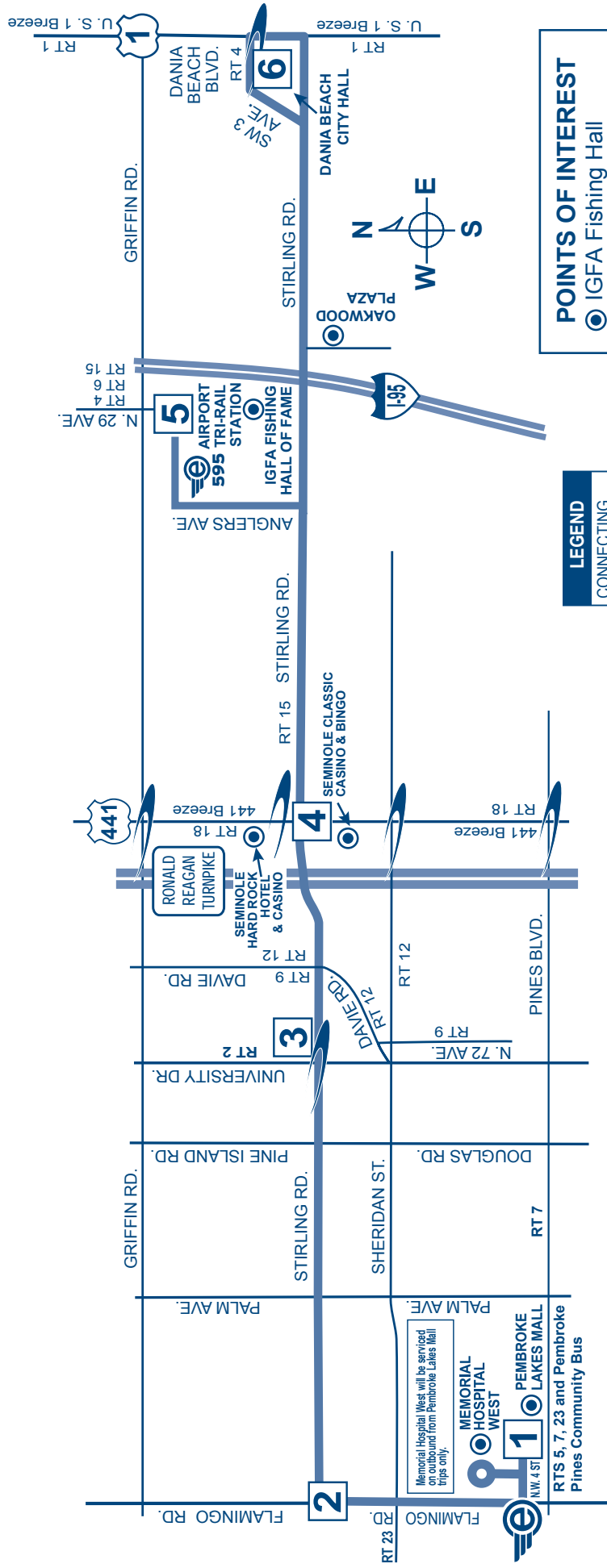

Memorial Hospital West will be serviced on outbound from Pembroke Lakes Mall trips only.

**MEMORIAL HOSPITAL WEST**  
**1**  
 N.W. 4 ST.  
 PEMBROKE LAKES MALL  
 RTS 5, 7, 23 and Pembroke Pines Community Bus

- POINTS OF INTEREST**
- IGFA Fishing Hall of Fame
  - Pembroke Lakes Mall
  - Seminole Hard Rock Hotel & Casino
  - Seminole Classic Casino & Bingo
  - Dania Beach City Hall
  - Oakwood Plaza
  - Memorial Hospital West

**LEGEND**

CONNECTING ROUTES → # RT

○ MAIN ROUTE

← TIMEPOINTS

The Breeze stop location

**95**  
Express



## Customer Service

Monday - Friday.....7 am - 7:45 pm  
Saturday, Sunday and Holidays.....8:30 am - 4:45 pm

Transit Operations Agents help with:

- Trip planning
- Routes, times and transfer information
- Identifying Bus Pass sales locations
- Special event information

Lost and Found: 954-357-8400, Monday, Tuesday, Thursday and Friday, 9:00 am - 4:00 pm

## Holiday Bus Service

Sunday bus service is provided on the following observed holidays:

New Year's Day	Labor Day	Memorial Day
Independence Day	Thanksgiving Day	Christmas Day

## Fares

Exact fare, dollar bill or coins required. Operators do not carry change.

Fares are: Regular, Premium Express, Senior/Youth/Disabled/Medicare.\* Children (under 40 inches ride FREE)

## Fare Deals

All Day Bus Pass offers unlimited rides on all routes. On sale aboard all BCT buses.

NOTE: Other cost saving passes cannot be purchased on BCT buses, but are available at the Central Bus Terminal and at authorized distributors.

**10 Ride Pass:** 10 Rides any time, any day. Expires after the tenth ride is taken.

**7 Day Pass:** Unlimited rides for seven consecutive days. Starts on the first day card is used. Expires after the seventh day.

**31 Day Adult Pass:** Unlimited rides for 31 consecutive days. Starts on the first day card is used.

**31 Day Reduced Pass:** Youth\*, Seniors\*, Disabled\*, Medicare\*, College Student\*. Unlimited rides for 31 consecutive days. Starts on the first day card is used.

**\*\*Premium Express 10 Ride Pass:** 10 rides any time, any day. Expires after tenth ride is taken.

**\*\*Premium Express 31 Day Pass:** Unlimited rides for 31 consecutive days. Starts on the first day card is used.

Bus Passes are not exchangeable, refundable or transferrable. Damaged cards are invalid. Lost, stolen or damaged cards will not be replaced.

\*NOTICE: Proof of age is required for Youth fare (18 years or younger) and for Senior fare (65 years or older). For College Student Bus Pass, a college photo ID card is required. For Disabled and Medicare fare, proof of disability (Medicare card) and photo I.D. is required. Eligible Senior fare patrons are encouraged to acquire their BCT Reduced Fare Photo ID cards.

\*\* Premium Bus Pass can be purchased online at [Broward.org/BCT](http://Broward.org/BCT) and at select Broward County library locations.

## PROTECTIONS OF TITLE VI OF THE CIVIL RIGHTS ACT OF 1964 AS AMENDED

Any person(s) or group(s) who believes that they have been subjected to discrimination because of race, color, or national origin, under any transit program or activity provided by Broward County Transit (BCT), may call 954-357-8481 to file a Title VI discrimination complaint or write to Broward County Transit Division, Compliance Manager, 1 N. University Drive, Suite 3100A, Plantation, FL 33324



## TRANSIT WATCH

**WHEN IT COMES TO OUR SAFETY,  
WE CAN ALWAYS USE AN EXTRA PAIR OF  
EYES AND EARS. BE ALERT.  
CALL 954-357-LOOK (5665). TELL US.**

## TRANSFER POLICY - EFFECTIVE 7/10/11

### TRANSFERS BETWEEN REGULAR BCT BUS SERVICE AND BCT EXPRESS BUS SERVICE

Passengers using any BCT bus pass and transferring from a regular BCT route, to an Express bus route, must pay a \$1.00 upgrade fee. Passengers with a Premium bus pass do not have to pay the \$1.00 upgrade fee.

Passengers paying with cash, on a regular BCT bus route, will not be able to transfer to an Express bus route without paying the full premium fare when boarding the Express bus.

Passengers using an All-Day bus pass will be required to pay the \$1.00 upgrade fee when boarding Express buses.

### PREMIUM BUS PASS CUSTOMERS

The BCT 31-Day Premium Bus Pass is acceptable on all BCT regular bus routes.

### TRANSFERS FROM BCT TO OTHER SOUTH FLORIDA TRANSIT SYSTEMS

When boarding a BCT bus, passenger pays the appropriate BCT fare and may request a transfer from the bus operator if transferring to Miami-Dade Transit (MDT), Palm Tran or Tri-Rail.

### TRANSFERS TO BCT FROM OTHER SOUTH FLORIDA TRANSIT SYSTEMS

When transferring from MDT, Palm Tran and Tri-Rail to BCT regular fixed-route bus service, passenger pays \$.50 with a transfer issued by MDT or Palm Tran and proof of fare payment such as Easy Card and receipt issued by Tri-Rail. Tri-Rail passengers boarding BCT at any locations other than at a Tri-Rail station will be required to pay the full fare.

### TRANSFERS BETWEEN OTHER SOUTH FLORIDA TRANSIT SYSTEMS AND PREMIUM EXPRESS BUS SERVICE

Transfers to MDT or Tri-Rail from Premium Express Service, a transfer is issued and passenger must pay appropriate MDT or Tri-Rail fare.

Transfer from MDT or Tri-Rail to Premium Express Service, a \$.50 transfer fee is required with the appropriate transfer from MDT or Tri-Rail.

The Premium Express Service does not connect with Palm Tran.

The Easy Card issued by MDT and Tri-Rail is not accepted as payment on any BCT bus.