



Public Works Department • Water & Wastewater Services

WATER & WASTEWATER ENGINEERING DIVISION

2555 West Copans Road • Pompano Beach, Florida 33369 • 954-831-0745 • FAX 954-831-0798/0925

GUIDELINE FOR WALLS AND FENCES ACROSS BCWWS EASEMENTS

Date: June 28, 2011

Date Last Issued: August 15, 2008

Date First Issued: August 15, 2008

This document approved by the Broward County Water & Wastewater Services Technical Standards Committee.

Steven W. Uhrick, P.E, Chair

No technical changes were made to this document since its last issuance. Only the letterhead and format were updated.

In no case shall a fence or wall be allowed to run inside and more or less parallel to a BCWWS easement. Chain link fences will be allowed to perpendicularly cross a BCWWS easement. Should the developer request that a wall or fence other than chain link cross a BCWWS easement, a gate will be required according to the following standards:

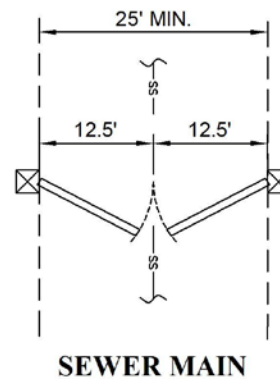
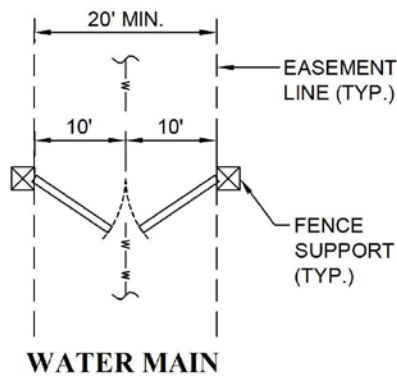

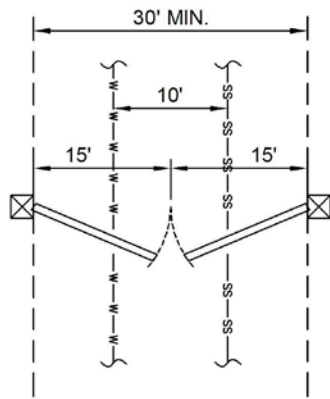

WATER AND SEWER OPTION #1

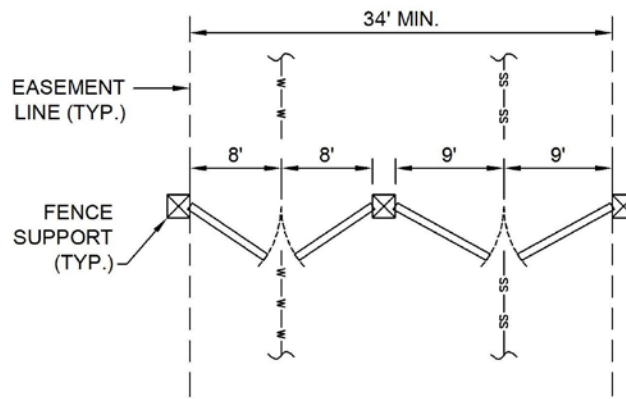

WATER AND SEWER OPTION #2

NOTES:

- 1) Sliding gates may be used in lieu of swinging gates.
- 2) Posts, columns, or other fence supports shall not encroach upon the provided easement.
- 3) Gates may be secured by the "chain and lock" method, BCWWS does not require a key.