



Employee Parking Relocating

On **Monday, May 1, 2017** at 12:01 a.m. the Employee Parking will relocate from the Cypress Garage to the new Employee Parking Lot west of the airport on SW 42nd Street. The Cypress Garage Parking will close to employees at the same time.

Why

- Airport employee parking was relocated from an off-site lot to the Cypress Garage as a temporary measure in 2007 during the peak of a national recession because it was underutilized by passengers at this time but had room for airport employees. Today, that is not the case.
- Passenger growth has created the demand for parking in the existing garages. The number of passengers has increased by over 6.5 million from 22.7 million in 2007 to 29.2 million in 2016.
- To accommodate the increase in passengers, more airport employees are needed. There is now a shortage of parking spaces in the Cypress Garage. At peak times, from 14 – 17 hours per day, nearly 4,000 employees attempt to park in 3,143 spaces.

Busing

- Buses run 24 hours a day, 7 days a week, with a five to ten minute headway.
- Bus ride takes about 20 minutes, and could potentially take more time if there is heavy traffic.
- The Employee Parking Lot is divided into Lots 1 and Lots 2.
- The buses are identified as Lot 1 or Lot 2 and will only go to one lot. You can park in either Lot 1 or Lot 2.
- Board a bus from one of the 14 bus stations in the two lots.
- There are two employee bus stops on the upper level roadway. One stop is located between Terminals 1 and 2 and the second stop is located between Terminals 3 and 4. The stops will be clearly identified.

Security

- A security fence surrounds the entire Employee Parking Lot and the area is well lit.
- A dedicated security officer, a shuttle bus supervisor, and parking staff will patrol the lot.
- Each bus has interior and exterior cameras.
- The lot will be under surveillance by CCTV cameras.

Real Time Information

To see the bus locations and arrival times, download the free FLL Airport App.

More Information

Go to Broward.org/Airport/Parking/EmployeeParking

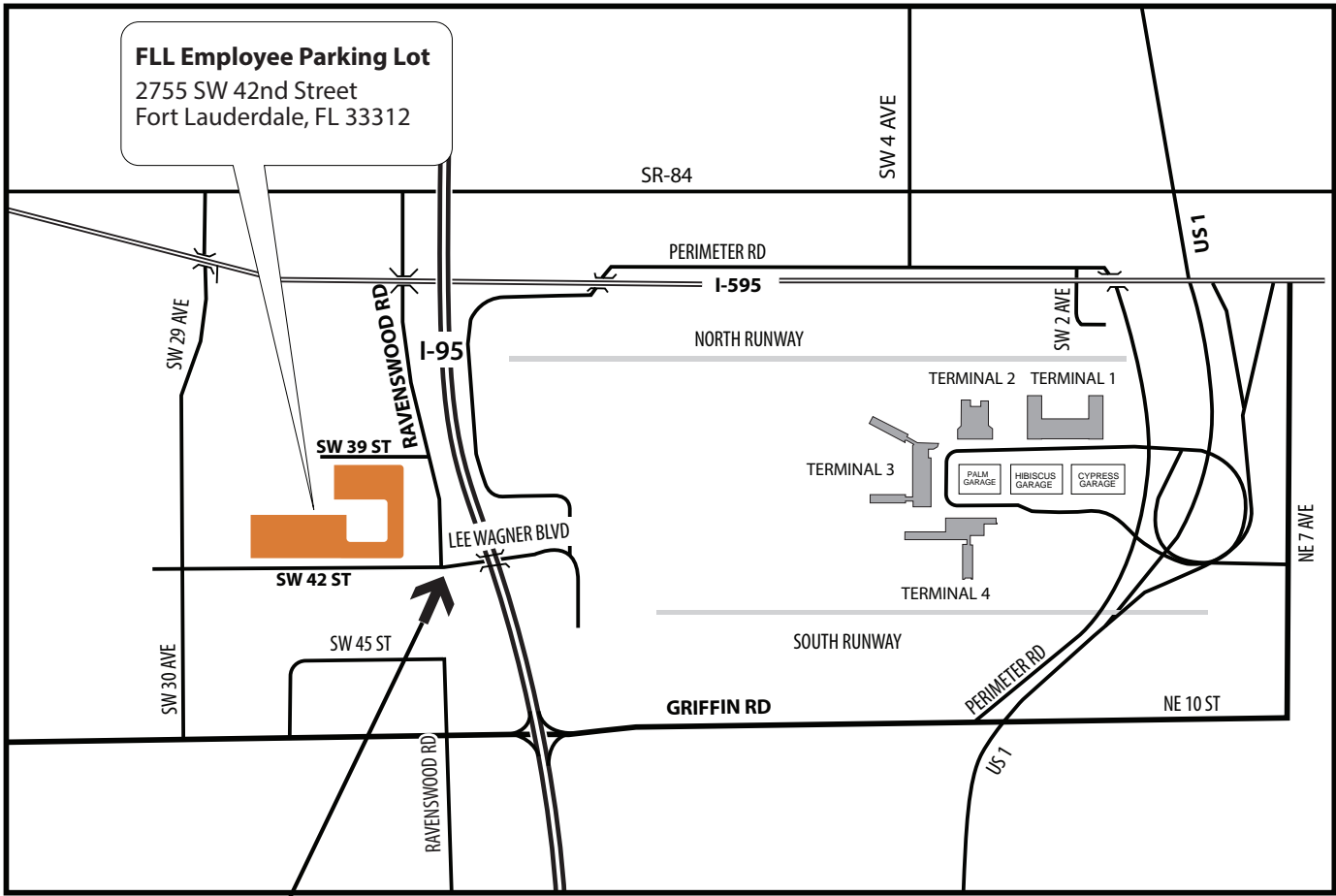

* Construction notice. The bridge over the Dania Cut-Off Canal is under construction and closed. Ravenswood Road is closed to traffic from SW 45th Street to SW 42nd Street.

AIRPORT EMPLOYEE PARKING

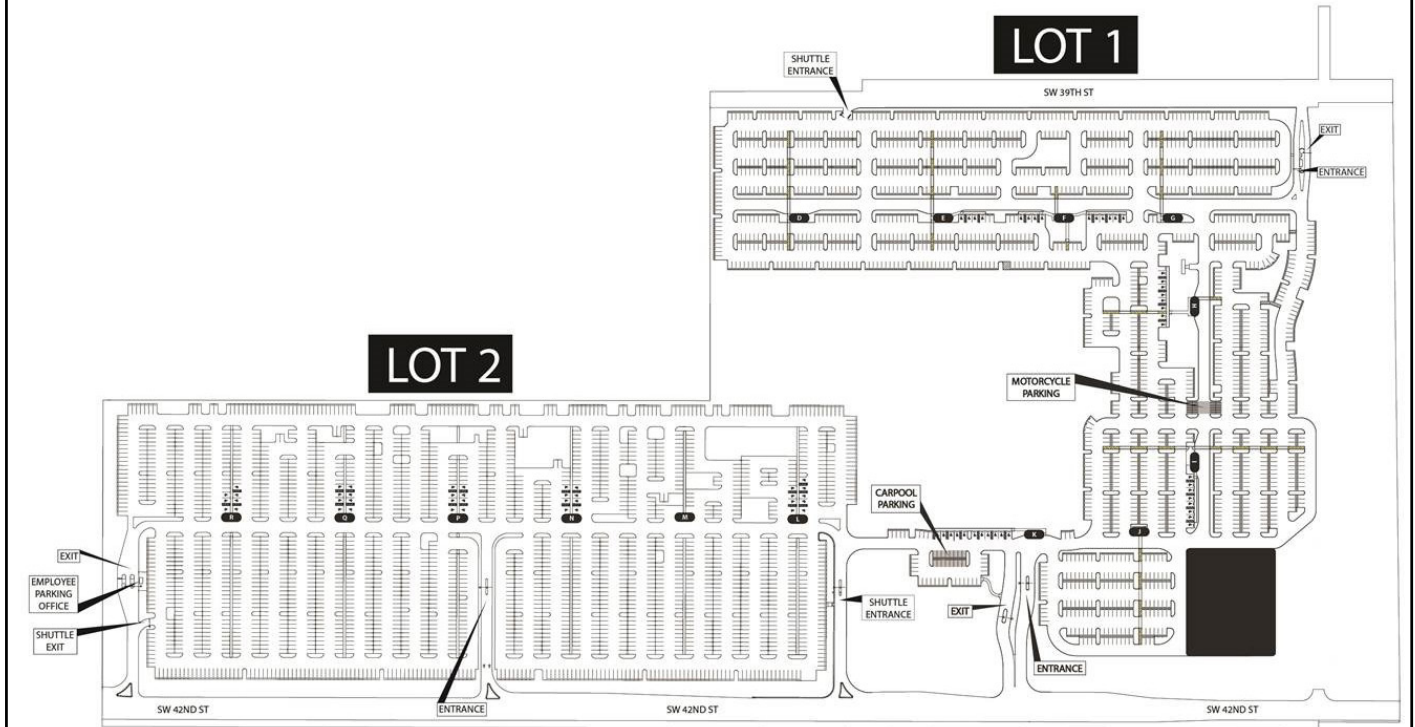

10,000 copies of this document were promulgated at a cost of \$1,750, or \$0.175 per copy, to inform airport employees about parking changes at the airport.