

BROWARD COUNTY

Unincorporated Neighborhood Data

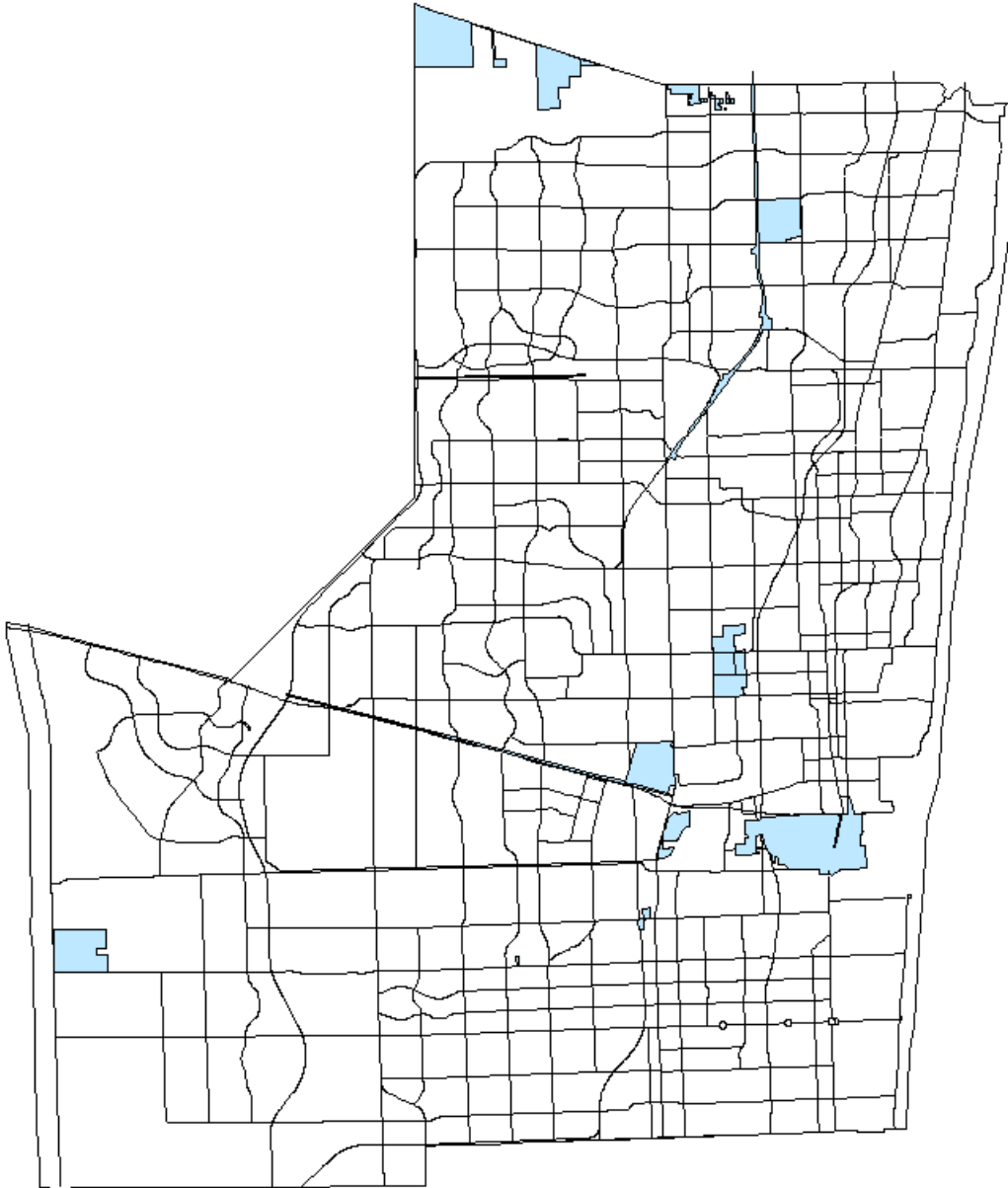

Broward County Board of County Commissioners
October 2011



Broward County Board of County Commissioners

Ilene Lieberman

Commissioner, District 1

Kristin Jacobs

Commissioner, District 2

Stacy Ritter

Commissioner, District 3

Chip LaMarca

Commissioner, District 4

Lois Wexler

Commissioner, District 5

Sue Gunzburger

Commissioner, District 6

John E. Rodstrom, Jr.

Commissioner, District 7

Barbara Sharief

Commissioner, District 8

Dale V.C. Holness

Commissioner, District 9

Broward County Administration

Bertha Henry, County Administrator

Cynthia Chambers, Director, Environmental Protection and Growth Management Department

Irena Householder, GIS Principal Planner, Planning and Redevelopment Division

BROWARD REPORT – Unincorporated Neighborhoods

Contents

I.	Introduction	2
II.	Neighborhood Map	3
III.	Neighborhood Profiles	
	Hillsboro Pines	5
	Roosevelt Gardens	8
	Washington Park	11
	Franklin Park	14
	Boulevard Gardens	17
	Broadview Park	20
IV.	Parcel Profiles	
	Hillsboro Ranches	24
	Northwest County Parcels	26
	Sunrise Six	28
	APPENDIX	31

INTRODUCTION

The purpose of the Broward Report on Unincorporated Neighborhood Data is to provide a profile of the remaining unincorporated neighborhoods in Broward County, as of October 2011.

Data tables and maps provide information about the geography, population, housing, schools, service providers and property taxes within each unincorporated neighborhood. Demographic and housing data have been tabulated from the recent release of Census 2010 data, along with the American Community Survey 5-year averages (2005-2009).

For additional information please contact the Planning and Redevelopment Division of the Environmental Protection and Growth Management Department at 954-357-6634, or visit our website at <http://www.broward.org/PlanningAndRedevelopment/Pages/Default.aspx>.

* Note: *The report was updated in March 2012 to reflect the new Commission District boundaries*

BROWARD COUNTY UNINCORPORATED AREA NEIGHBORHOODS

1. **Northwest County Parcels**
2. **Hillsboro Pines**
3. Hillsboro Ranches
4. **Monarch Hill Renewable Energy Park**
5. **Roosevelt Gardens**
6. **Washington Park**
7. **Franklin Park**
8. **Boulevard Gardens**
9. **Broadview Park**
10. Water Treatment Facility
11. Landfill
12. Fort Lauderdale/Hollywood International Airport
13. Landfill & Correctional Facility
14. **Sunrise Six**

** Profiles of neighborhoods shown in bold type are included in this report*

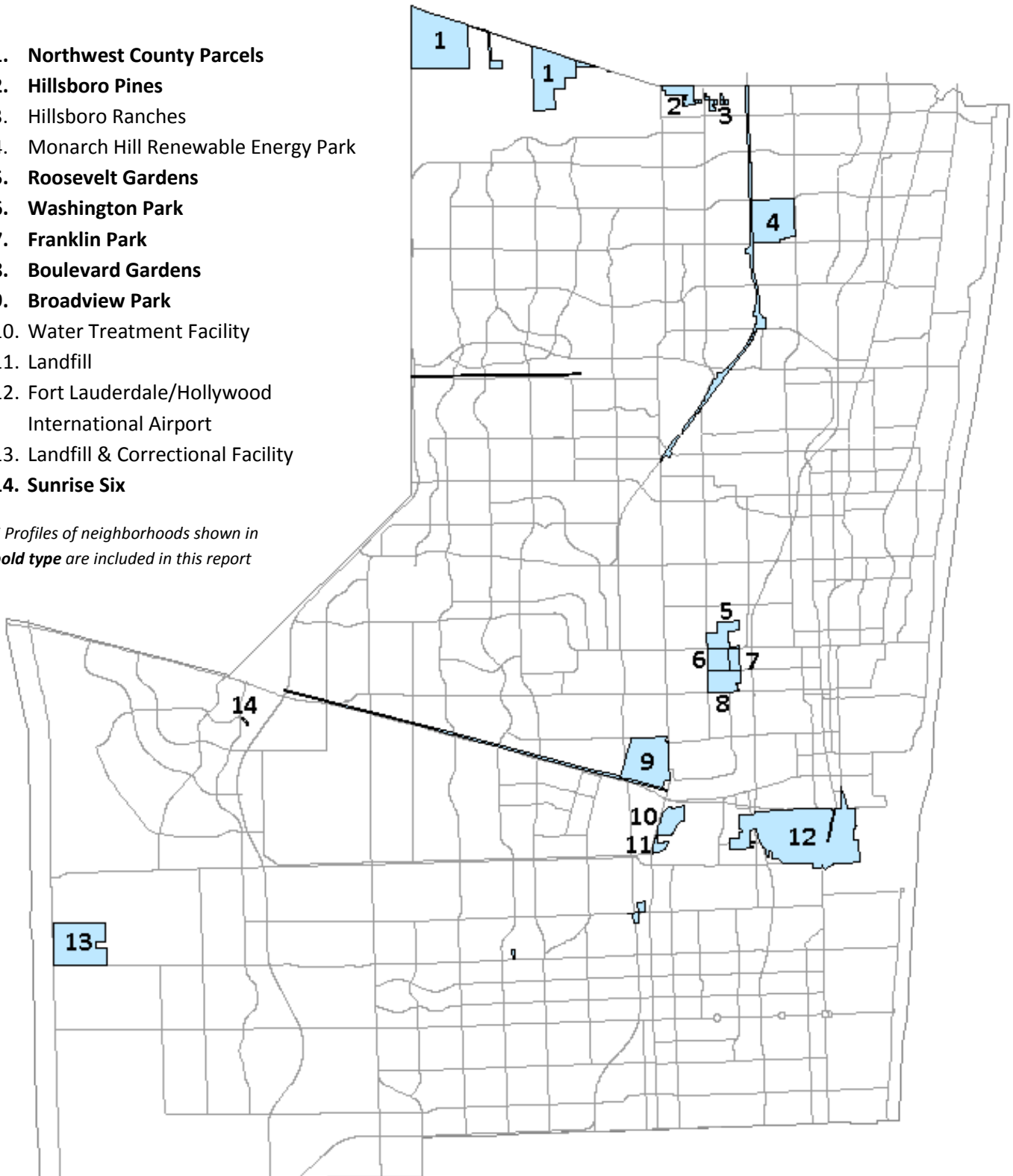

Neighborhood Profiles

NEIGHBORHOOD PROFILE
Hillsboro Pines

Adjacent Municipalities:
Coconut Creek

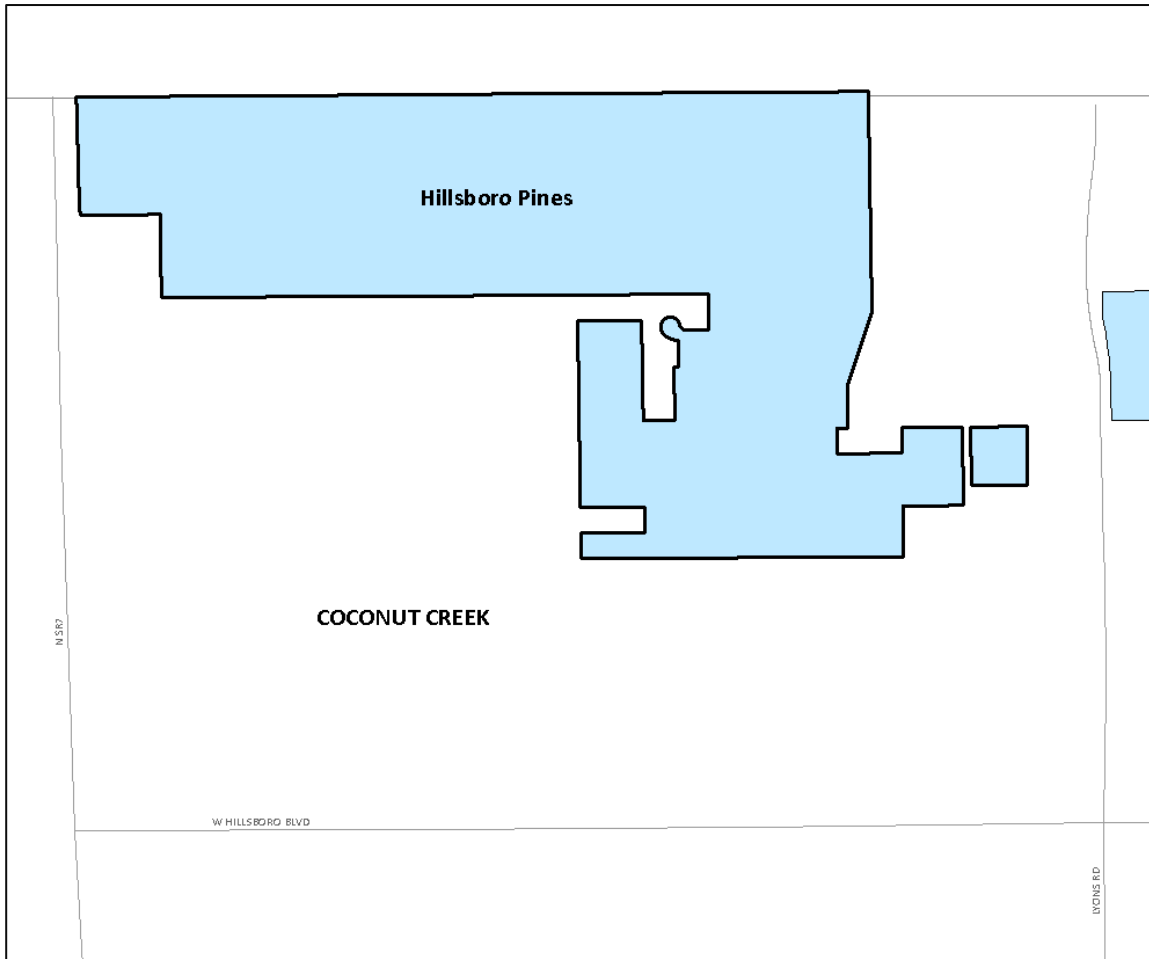

U.S. Congressional District	19
State Senate District	30
State House District	90
Broward Commission District	2

Zip Code
33073

Voting Precinct
F014

NEIGHBORHOOD PROFILE

Hillsboro Pines (2)

Land Area	
Acres	138
Square Miles	0.2

	2000	2010	Change
Population	406	446	9.9%
Housing Units	147	153	4.1%

Race & Ethnicity (2010)	Persons	Percent
Total Persons	446	
Not-Hispanic:	400	89.7%
White	373	83.6%
Black	23	5.2%
Other Race	4	0.4%
Two or more Races	0	0%
Hispanic (any race)	46	10.3%

Registered Voters (2011)			
Democrat	36.1%	White	72.6%
Republican	35.3%	Black	7.5%
Other	28.7%	Other Race	10.0%

Housing Type	2005-2009 (ACS*)
Single Family	100.0%
Multi-Family	0.0%
Mobile Homes & Other	0.0%

*American Community Survey (2005-2009 averages) – This survey has replaced the Decennial Census "long form". The Decennial Census does not report this data anymore.

Public Schools	Number	Enrollment
Elementary	0	0
Middle	0	0
High	0	0

Property Taxes	
<i>Unincorporated Millage Rate (2011)</i>	<i>0.0048577</i>
<small>*Includes fire rescue millage of 0.0025224</small>	
Taxable Value (1) and Estimated Property Tax (2)	
(1)	\$25,000 \$50,000 \$75,000 \$100,000
(2)	\$121.44 \$242.89 \$364.33 \$485.77

*The taxable value is determined by subtracting deductions such as the \$25,000-\$50,000 homestead exemption from the assessed value of the residence.

Service Providers	
Police	Broward Sheriff's Office
Fire/EMS	Broward County Fire Rescue
Water	No reliable information available
Sanitary Sewer	Coconut Creek
Garbage	Waste Management* (until January 2012)

*Starting in January 2012, City of Coconut Creek

Notes:
* 2010 Census under-counts the population of Hillsboro Pines. Geography for the Hillsboro Pines neighborhood and the Hillsboro Pines CDP do not correspond: Census Blocks 1023, 1025 and 1026 within Census Tract 105.02 were omitted from the Hillsboro Pines CDP. These three blocks have 60 residents. The profile on the following page reflects the actual Census numbers.

Table DP-1. Profile of General Population and Housing Characteristics: 2010

Geographic Area: Hillsboro Pines CDP, Florida

[For more information on confidentiality protection, nonsampling error, and definitions, see <http://www.census.gov/prod/cen2010/profiletd.pdf>]

Subject	Number	Percent	Subject	Number	Percent
Total Population	446	100.0	HISPANIC OR LATINO AND RACE		
SEX AND AGE			Total population	446	100.0
Male	234	52.5	Hispanic or Latino	46	10.3
Female	212	47.5	Not Hispanic or Latino	400	89.7
Under 5 years	21	4.7	White alone	373	83.6
5 to 9 years	33	7.4	Black or African American alone	23	5.2
10 to 14 years	45	10.1	American Indian and Alaska Native alone	0	0.0
15 to 19 years	31	7.0	Asian alone	2	0.4
20 to 24 years	24	5.4	Native Hawaiian and Other Pacific Islander	0	0.0
25 to 29 years	15	3.4	Some Other Race alone	2	0.4
30 to 34 years	24	5.4	Two or More Races	0	0.0
35 to 39 years	25	5.6	RELATIONSHIP		
40 to 44 years	38	8.5	Total population	446	100.0
45 to 49 years	51	11.4	In households	446	100.0
50 to 54 years	43	9.6	Householder	149	33.4
55 to 59 years	33	7.4	Spouse	87	19.5
60 to 64 years	20	4.5	Child	149	33.4
65 to 69 years	16	3.6	Own child under 18 years	105	23.5
70 to 74 years	12	2.7	Other relatives	42	9.4
75 to 79 years	7	1.6	Under 18 years	13	2.9
80 to 84 years	3	0.7	65 years and over	9	2.0
85 years and over	5	1.1	Nonrelatives	19	4.3
Median age (years)	41.3	(X)	Unmarried partner	9	2.0
18 years and over	328	73.5	In group quarters	0	0.0
Male	165	37.0	Institutionalized population	0	0.0
Female	163	36.5	Noninstitutionalized population	0	0.0
21 years and over	313	70.2	HOUSEHOLDS BY TYPE		
62 years and over	53	11.9	Total households	149	100.0
65 years and over	43	9.6	Family households (families)	114	76.5
Male	19	4.3	With own children under 18 years	58	38.9
Female	24	5.4	Husband-wife family	87	58.4
RACE			With own children under 18 years	45	30.2
One Race	446	100.0	Male householder, no wife present	8	5.4
White	419	93.9	With own children under 18 years	3	2.0
Black or African American	23	5.2	Female householder, no husband present	19	12.8
American Indian and Alaska Native	0	0.0	With own children under 18 years	10	6.7
Asian	2	0.4	Nonfamily households	35	23.5
Asian Indian	0	0	Householder living alone	23	15.4
Chinese	0	0	65 years and over	6	4.0
Filipino	1	0.2	Households with individuals under 18 years	65	43.6
Japanese	0	0	Households with individuals 65 years and over	32	21.5
Korean	0	0	Average household size	2.99	(X)
Vietnamese	0	0	Average family size	3.44	(X)
Other Asian	1	0.2	HOUSING OCCUPANCY		
Native Hawaiian and Other Pacific Islander	0	0	Total housing units	153	100.0
Native Hawaiian	0	0	Occupied housing units	149	97.4
Guamanian or Chamorro	0	0	Vacant housing units	4	2.6
Samoan	0	0	For seasonal, recreational, or occasional use	0	0.0
Other Pacific Islander	0	0	Homeowner vacancy rate (percent)	0.8	(X)
Some Other Race	2	0.4	Rental vacancy rate (percent)	5.6	(X)
Two or More Races	0	0.0	HOUSING TENURE		
HISPANIC OR LATINO			Occupied housing units	149	
Total Population	446	100.0	Owner-occupied housing units	132	
Hispanic or Latino	46	10.3	Renter-occupied housing units	17	
Mexican	5	1.1	Average household size of owner-occupied	3.00	(X)
Puerto Rican	6	1.3	Average household size of renter-occupied	2.94	(X)
Cuban	13	2.9			
Other Hispanic or Latino	22	4.9			
Not Hispanic or Latino	400	89.7			

NEIGHBORHOOD PROFILE
Roosevelt Gardens

Adjacent Municipalities:
 Fort Lauderdale
 Lauderhill

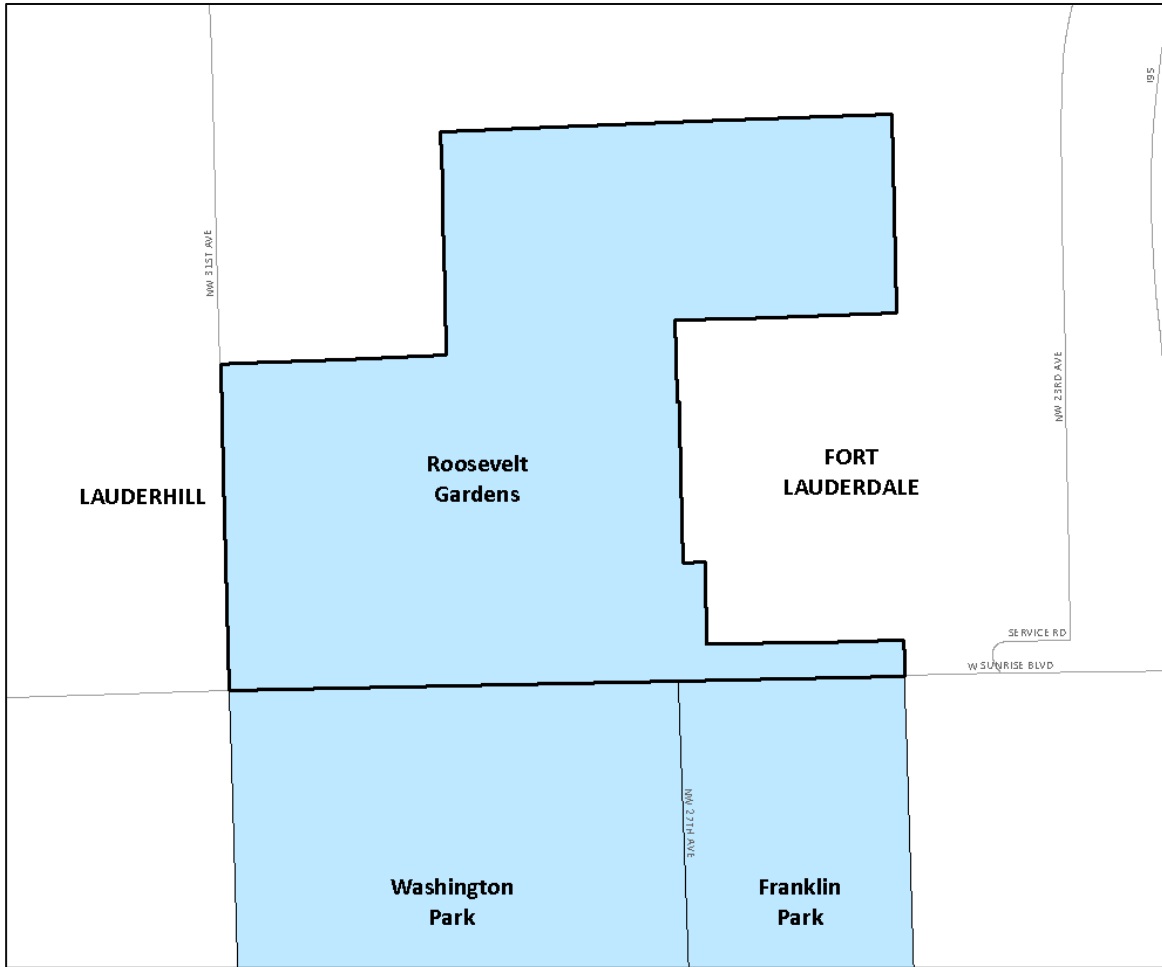

U.S. Congressional District	23
State Senate District	29
State House District	93
Broward Commission District	9

Zip Code
33311

Voting Precinct
Z031

NEIGHBORHOOD PROFILE

Roosevelt Gardens (5)

Land Area	
Acres	207
Square Miles	0.3

	2000	2010	Change
Population	1,923	2,456	27.7%
Housing Units	733	919	25.4%

Race & Ethnicity (2010)	Persons	Percent
Total Persons	2,456	
Not-Hispanic:	2,407	98.0%
White	33	1.3%
Black	2,354	95.8%
Other Race	3	0.1%
Two or more Races	17	0.7%
Hispanic (any race)	49	2.0%

Registered Voters (2011)			
Democrat	84.1%	White	1.6%
Republican	3.5%	Black	90.5%
Other	12.4%	Other Race	7.9%

Public Schools	Number	Enrollment
Elementary	0	0
Middle	0	0
High	0	0

Housing Type	2005-2009 (ACS*)
Single Family	49.5%
Multi-Family	50.5%
Mobile Homes & Other	0.0%

*American Community Survey (2005-2009 averages) – This survey has replaced the Decennial Census "long form". The Decennial Census does not report this data anymore.

Service Providers	
Police	Broward Sheriff's Office
Fire/EMS	Broward County Fire Rescue
Water	Fort Lauderdale
Sanitary Sewer	Fort Lauderdale
Garbage	All Service Refuse* (until January 2012)

*Starting in January 2012, Choice Environmental Services of Broward

Property Taxes	
<i>Unincorporated Millage Rate (2011)</i>	<i>0.0048577</i>
<small>*Includes fire rescue millage of 0.0025224</small>	
Taxable Value (1) and Estimated Property Tax (2)	
(1)	\$25,000 \$50,000 \$75,000 \$100,000
(2)	\$121.44 \$242.89 \$364.33 \$485.77

*The taxable value is determined by subtracting deductions such as the \$25,000-\$50,000 homestead exemption from the assessed value of the residence.

Notes:

Table DP-1. Profile of General Population and Housing Characteristics: 2010

Geographic Area: Roosevelt Gardens CDP, Florida

[For more information on confidentiality protection, nonsampling error, and definitions, see <http://www.census.gov/prod/cen2010/profiletd.pdf>]

Subject	Number	Percent	Subject	Number	Percent
Total Population	2,456	100.0	HISPANIC OR LATINO AND RACE		
SEX AND AGE			Total population	2,456	100.0
Male	1,203	49.0	Hispanic or Latino	49	2.0
Female	1,253	51.0	Not Hispanic or Latino	2,407	98.0
Under 5 years	204	8.3	White alone	33	1.3
5 to 9 years	200	8.1	Black or African American alone	2,354	95.8
10 to 14 years	218	8.9	American Indian and Alaska Native alone	2	0.1
15 to 19 years	256	10.4	Asian alone	1	0.0
20 to 24 years	195	7.9	Native Hawaiian and Other Pacific Islander	0	0.0
25 to 29 years	121	4.9	Some Other Race alone	0	0.0
30 to 34 years	141	5.7	Two or More Races	17	0.7
35 to 39 years	161	6.6	RELATIONSHIP		
40 to 44 years	158	6.4	Total population	2,456	100.0
45 to 49 years	194	7.9	In households	2,438	99.3
50 to 54 years	165	6.7	Householder	774	31.5
55 to 59 years	151	6.1	Spouse	171	7.0
60 to 64 years	91	3.7	Child	878	35.7
65 to 69 years	56	2.3	Own child under 18 years	556	22.6
70 to 74 years	51	2.1	Other relatives	440	17.9
75 to 79 years	43	1.8	Under 18 years	205	8.3
80 to 84 years	30	1.2	65 years and over	41	1.7
85 years and over	21	0.9	Nonrelatives	175	7.1
Median age (years)	31.3	(X)	Unmarried partner	72	2.9
18 years and over	1,675	68.2	In group quarters	18	0.7
Male	786	32.0	Institutionalized population	0	0.0
Female	889	36.2	Noninstitutionalized population	18	0.7
21 years and over	1,536	62.5	HOUSEHOLDS BY TYPE		
62 years and over	262	10.7	Total households	774	100.0
65 years and over	201	8.2	Family households (families)	566	73.1
Male	78	3.2	With own children under 18 years	268	34.6
Female	123	5.0	Husband-wife family	171	22.1
RACE			With own children under 18 years	87	11.2
One Race	2,433	99.1	Male householder, no wife present	83	10.7
White	54	2.2	With own children under 18 years	30	3.9
Black or African American	2,369	96.5	Female householder, no husband present	312	40.3
American Indian and Alaska Native	2	0.1	With own children under 18 years	151	19.5
Asian	1	0	Nonfamily households	208	26.9
Asian Indian	1	0	Householder living alone	160	20.7
Chinese	0	0	65 years and over	38	4.9
Filipino	0	0	Households with individuals under 18 years	366	47.3
Japanese	0	0	Households with individuals 65 years and over	170	22.0
Korean	0	0	Average household size		(X)
Vietnamese	0	0	Average family size		(X)
Other Asian	0	0	HOUSING OCCUPANCY		
Native Hawaiian and Other Pacific Islander	0	0	Total housing units	919	100.0
Native Hawaiian	0	0	Occupied housing units	774	84.2
Guamanian or Chamorro	0	0	Vacant housing units	145	15.8
Samoan	0	0	For seasonal, recreational, or occasional use	0	0.0
Other Pacific Islander	0	0	Homeowner vacancy rate (percent)	5.2	(X)
Some Other Race	7	0.3	Rental vacancy rate (percent)	18.5	(X)
Two or More Races	23	0.9			
HISPANIC OR LATINO			HOUSING TENURE		
Total Population	2,456	100.0	Occupied housing units	774	
Hispanic or Latino	49	2.0	Owner-occupied housing units	330	
Mexican	2	0.1	Renter-occupied housing units	444	
Puerto Rican	23	0.9	Average household size of owner-occupied	3.34	(X)
Cuban	5	0.2	Average household size of renter-occupied	3.01	(X)
Other Hispanic or Latino	19	0.8			
Not Hispanic or Latino	2,407	98			

NEIGHBORHOOD PROFILE
Washington Park

Adjacent Municipalities:
 Lauderhill

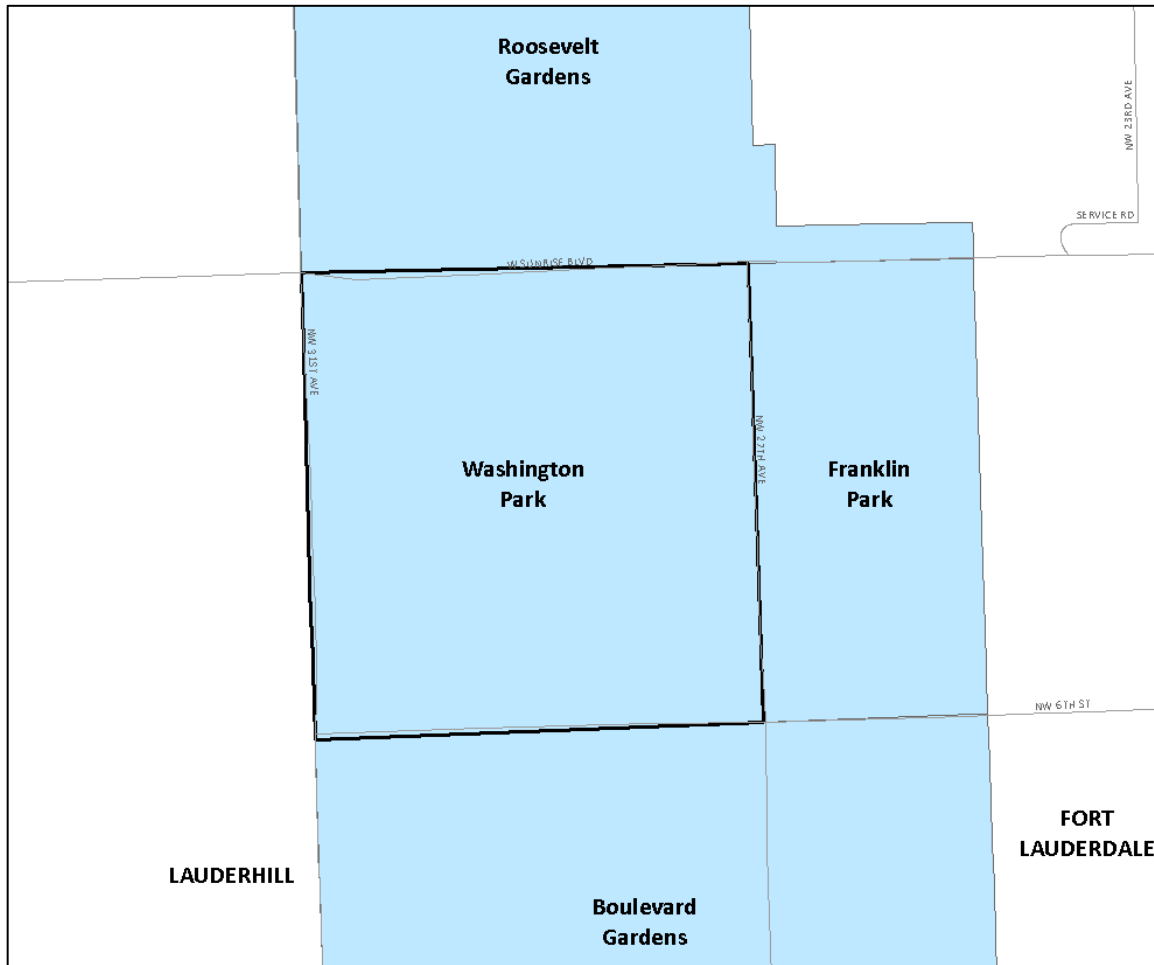

U.S. Congressional District	23
State Senate District	29
State House District	93
Broward Commission District	9

Zip Code
33311

Voting Precinct
Z034

NEIGHBORHOOD PROFILE

Washington Park (6)

Land Area	
Acres	169
Square Miles	0.3

Race & Ethnicity (2010)	Persons	Percent
Total Persons	1,672	
Not-Hispanic:	1,642	98.2%
White	26	1.6%
Black	1,581	94.6%
Other Race	14	0.8%
Two or more Races	21	1.3%
Hispanic (any race)	30	1.8%

Public Schools	Number	Enrollment
Elementary	0	0
Middle	0	0
High	0	0

Service Providers	
Police	Broward Sheriff's Office
Fire/EMS	Broward County Fire Rescue
Water	Fort Lauderdale
Sanitary Sewer	Fort Lauderdale
Garbage	All Service Refuse* (until January 2012)

*Starting in January 2012, Choice Environmental Services of Broward

	2000	2010	Change
Population	1,257	1,672	33.0%
Housing Units	470	530	12.8%

Registered Voters (2011)			
Democrat	86.1%	White	1.2%
Republican	2.6%	Black	91.0%
Other	11.3%	Other Race	7.8%

Housing Type	2005-2009 (ACS*)
Single Family	97.7%
Multi-Family	2.3%
Mobile Homes & Other	0.0%

*American Community Survey (2005-2009 averages) – This survey has replaced the Decennial Census "long form". The Decennial Census does not report this data anymore.

Property Taxes	
<i>Unincorporated Millage Rate (2011)</i>	<i>0.0048577</i>
<i>*Includes fire rescue millage of 0.0025224</i>	
Taxable Value (1) and Estimated Property Tax (2)	
(1)	\$25,000 \$50,000 \$75,000 \$100,000
(2)	\$121.44 \$242.89 \$364.33 \$485.77

*The taxable value is determined by subtracting deductions such as the \$25,000-\$50,000 homestead exemption from the assessed value of the residence.

Notes:
* 2010 Census over-counts the population of Washington Park CDP. Geography for the Washington Park neighborhood and the Washington Park CDP do not correspond: Census Block 2012 within Census Tract 414 is included within the Washington Park CDP, but it is actually located within the Franklin Park CDP. This Census Block has 24 people.

Table DP-1. Profile of General Population and Housing Characteristics: 2010

Geographic Area: Washington Park CDP, Florida

[For more information on confidentiality protection, nonsampling error, and definitions, see <http://www.census.gov/prod/cen2010/profiletd.pdf>]

Subject	Number	Percent	Subject	Number	Percent
Total Population	1,672	100.0	HISPANIC OR LATINO AND RACE		
SEX AND AGE			Total population	1,672	100.0
Male	803	48.0	Hispanic or Latino	30	1.8
Female	869	52.0	Not Hispanic or Latino	1,642	98.2
Under 5 years	125	7.5	White alone	26	1.6
5 to 9 years	110	6.6	Black or African American alone	1,581	94.6
10 to 14 years	134	8.0	American Indian and Alaska Native alone	0	0.0
15 to 19 years	166	9.9	Asian alone	7	0.4
20 to 24 years	132	7.9	Native Hawaiian and Other Pacific Islander	0	0.0
25 to 29 years	94	5.6	Some Other Race alone	7	0.4
30 to 34 years	98	5.9	Two or More Races	21	1.3
35 to 39 years	97	5.8	RELATIONSHIP		
40 to 44 years	118	7.1	Total population	1,672	100.0
45 to 49 years	138	8.3	In households	1,654	98.9
50 to 54 years	140	8.4	Householder	530	31.7
55 to 59 years	94	5.6	Spouse	161	9.6
60 to 64 years	67	4.0	Child	574	34.3
65 to 69 years	54	3.2	Own child under 18 years	324	19.4
70 to 74 years	32	1.9	Other relatives	281	16.8
75 to 79 years	28	1.7	Under 18 years	127	7.6
80 to 84 years	28	1.7	65 years and over	26	1.6
85 years and over	17	1.0	Nonrelatives	108	6.5
Median age (years)	33.7	(X)	Unmarried partner	34	2.0
18 years and over	1,210	72.4	In group quarters	18	1.1
Male	571	47.2	Institutionalized population	0	0.0
Female	639	52.8	Noninstitutionalized population	18	1.1
21 years and over	1,108	66.3	HOUSEHOLDS BY TYPE		
62 years and over	191	11.4	Total households	530	100.0
65 years and over	159	9.5	Family households (families)	375	70.8
Male	59	37.1	With own children under 18 years	160	30.2
Female	100	62.9	Husband-wife family	161	30.4
RACE			With own children under 18 years	75	14.2
One Race	1,650	98.7	Male householder, no wife present	37	7.0
White	47	2.8	With own children under 18 years	11	2.1
Black or African American	1,586	94.9	Female householder, no husband present	177	33.4
American Indian and Alaska Native	0	0.0	With own children under 18 years	74	14.0
Asian	7	0.4	Nonfamily households	155	29.2
Asian Indian	6	0.4	Householder living alone	124	23.4
Chinese	0	0.0	65 years and over	34	2.1
Filipino	0	0.0	Households with individuals under 18 years	215	40.6
Japanese	0	0.0	Households with individuals 65 years and over	131	24.7
Korean	0	0.0	Average household size	3.12	(X)
Vietnamese	0	0.0	Average family size	3.71	(X)
Other Asian	1	0.1	HOUSING OCCUPANCY		
Native Hawaiian and Other Pacific Islander	0	0.0	Total housing units	624	100.0
Native Hawaiian	0	0.0	Occupied housing units	530	84.9
Guamanian or Chamorro	0	0.0	Vacant housing units	94	15.1
Samoan	0	0.0	For seasonal, recreational, or occasional use	2	0.3
Other Pacific Islander	0	0.0	Homeowner vacancy rate (percent)	1.7	(X)
Some Other Race	10	0.6	Rental vacancy rate (percent)	12.8	(X)
Two or More Races	22	1.3			
HISPANIC OR LATINO			HOUSING TENURE		
Total Population	1672	100.0	Occupied housing units	530	100.0
Hispanic or Latino	30	1.8	Owner-occupied housing units	347	65.5
Mexican	17	1.0	Renter-occupied housing units	183	34.5
Puerto Rican	8	0.5	Average household size of owner-occupied	3.15	(X)
Cuban	1	0.1	Average household size of renter-occupied	3.07	(X)
Other Hispanic or Latino	4	0.2			
Not Hispanic or Latino	1,642	98.2			

NEIGHBORHOOD PROFILE
Franklin Park

Adjacent Municipalities:
 Fort Lauderdale

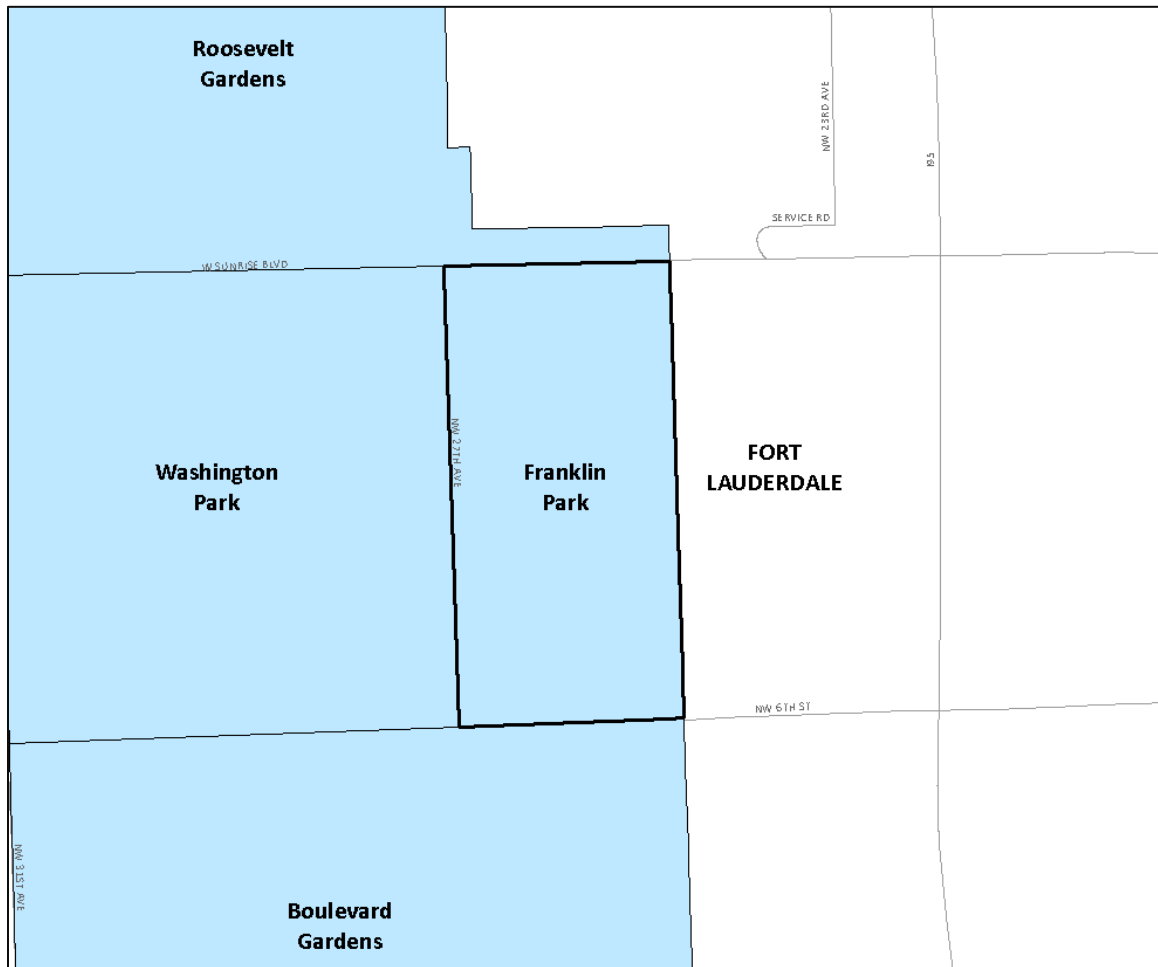

U.S. Congressional District	23
State Senate District	29
State House District	93
Broward Commission District	9

Zip Code
33311

Voting Precinct
Z034

NEIGHBORHOOD PROFILE

Franklin Park (6)

Land Area	
Acres	83
Square Miles	0.1

Race & Ethnicity (2010)	Persons	Percent
Total Persons	860	
Not-Hispanic:	851	99.0%
White	3	0.3%
Black	855	97.1%
Other Race	3	0.3%
Two or more Races	10	1.2%
Hispanic (any race)	9	1.0%

Public Schools	Number	Enrollment
Elementary	0	0
Middle	0	0
High	0	0

Service Providers	
Police	Broward Sheriff's Office
Fire/EMS	Broward County Fire Rescue
Water	Fort Lauderdale
Sanitary Sewer	Fort Lauderdale
Garbage	All Service Refuse* (until January 2012)

*Starting in January 2012, Choice Environmental Services of Broward

	2000	2010	Change
Population	943	860	-8.8%
Housing Units	322	353	9.6%

Registered Voters (2011)			
Democrat	86.1%	White	1.2%
Republican	2.6%	Black	91.0%
Other	11.3%	Other Race	7.8%

Housing Type	2005-2009 (ACS*)
Single Family	22.6%
Multi-Family	77.4%
Mobile Homes & Other	0.0%

*American Community Survey (2005-2009 averages) – This survey has replaced the Decennial Census "long form". The Decennial Census does not report this data anymore.

Property Taxes	
<i>Unincorporated Millage Rate (2011)</i>	<i>0.0048577</i>
<i>*Includes fire rescue millage of 0.0025224</i>	
Taxable Value (1) and Estimated Property Tax (2)	
(1)	\$25,000 \$50,000 \$75,000 \$100,000
(2)	\$121.44 \$242.89 \$364.33 \$485.77

*The taxable value is determined by subtracting deductions such as the \$25,000-\$50,000 homestead exemption from the assessed value of the residence.

Notes:
* 2010 Census under-counts the population of Franklin Park CDP. Geography for the Franklin Park neighborhood and the Franklin Park CDP do not correspond: Census Block 2012 within Census Tract 414 is included within the Washington Park CDP, but it is actually located within the Franklin Park CDP. This Census Block has 24 people.

Table DP-1. Profile of General Population and Housing Characteristics: 2010

Geographic Area: Franklin Park CDP, Florida

[For more information on confidentiality protection, nonsampling error, and definitions, see <http://www.census.gov/prod/cen2010/profiletd.pdf>]

Subject	Number	Percent	Subject	Number	Percent
Total Population	860	100.0	HISPANIC OR LATINO AND RACE		
SEX AND AGE			Total population	860	100.0
Male	400	46.5	Hispanic or Latino	9	1.0
Female	460	53.5	Not Hispanic or Latino	851	99.0
Under 5 years	96	11.2	White alone	3	0.3
5 to 9 years	84	9.8	Black or African American alone	835	97.1
10 to 14 years	69	8.0	American Indian and Alaska Native alone	1	0.1
15 to 19 years	95	11.0	Asian alone	1	0.1
20 to 24 years	64	7.4	Native Hawaiian and Other Pacific Islander	0	0.0
25 to 29 years	73	8.5	Some Other Race alone	1	0.1
30 to 34 years	45	5.2	Two or More Races	10	1.2
35 to 39 years	53	6.2	RELATIONSHIP		
40 to 44 years	54	6.3	Total population	860	100.0
45 to 49 years	61	7.1	In households	860	100.0
50 to 54 years	54	6.3	Householder	287	33.4
55 to 59 years	40	4.7	Spouse	62	7.2
60 to 64 years	34	4.0	Child	347	40.3
65 to 69 years	15	1.7	Own child under 18 years	236	27.4
70 to 74 years	9	1.0	Other relatives	116	13.5
75 to 79 years	6	0.7	Under 18 years	60	7.0
80 to 84 years	4	0.5	65 years and over	7	0.8
85 years and over	4	0.5	Nonrelatives	48	5.6
Median age (years)	26.3	(X)	Unmarried partner	25	2.9
18 years and over	558	64.9	In group quarters	0	0.0
Male	247	28.7	Institutionalized population	0	0.0
Female	311	36.2	Noninstitutionalized population	0	0.0
21 years and over	499	58.0	HOUSEHOLDS BY TYPE		
62 years and over	52	6.0	Total households	287	100.0
65 years and over	38	4.4	Family households (families)	205	71.4
Male			With own children under 18 years	106	36.9
Female			Husband-wife family	62	21.6
21 years and over			With own children under 18 years	24	8.4
62 years and over			Male householder, no wife present	21	7.3
65 years and over			With own children under 18 years	9	3.1
Male			Female householder, no husband present	122	42.5
Female			With own children under 18 years	73	25.4
RACE			Nonfamily households	82	28.6
One Race	849	98.7	Householder living alone	61	21.3
White	4	0.5	65 years and over	9	3.1
Black or African American	842	97.9	Households with individuals under 18 years	140	48.8
American Indian and Alaska Native	1	0.1	Households with individuals 65 years and over	34	11.8
Asian	1	0.1	Average household size	3.0	(X)
Asian Indian	1	0.1	Average family size	3.56	(X)
Chinese	0	0	HOUSING OCCUPANCY		
Filipino	0	0	Total housing units	353	100.0
Japanese	0	0	Occupied housing units	287	81.3
Korean	0	0	Vacant housing units	66	18.7
Vietnamese	0	0	For seasonal, recreational, or occasional use	0	0.0
Other Asian	0	0	Homeowner vacancy rate (percent)	0.0	(X)
Native Hawaiian and Other Pacific Islander	0	0	Rental vacancy rate (percent)	13.8	(X)
Native Hawaiian	0	0	HOUSING TENURE		
Guamanian or Chamorro	0	0	Occupied housing units	287	100.0
Samoan	0	0	Owner-occupied housing units	39	13.6
Other Pacific Islander	0	0	Renter-occupied housing units	248	86.4
Some Other Race	1	0.1	Average household size of owner-occupied	3.10	(X)
Two or More Races	11	1.3	Average household size of renter-occupied	2.98	(X)
HISPANIC OR LATINO					
Total Population	860	100.0			
Hispanic or Latino	9	1.0			
Mexican	2	0.2			
Puerto Rican	3	0.3			
Cuban	0	0.0			
Other Hispanic or Latino	4	0.5			
Not Hispanic or Latino	851	99			

NEIGHBORHOOD PROFILE
Boulevard Gardens

Adjacent Municipalities:
 Fort Lauderdale
 Lauderhill

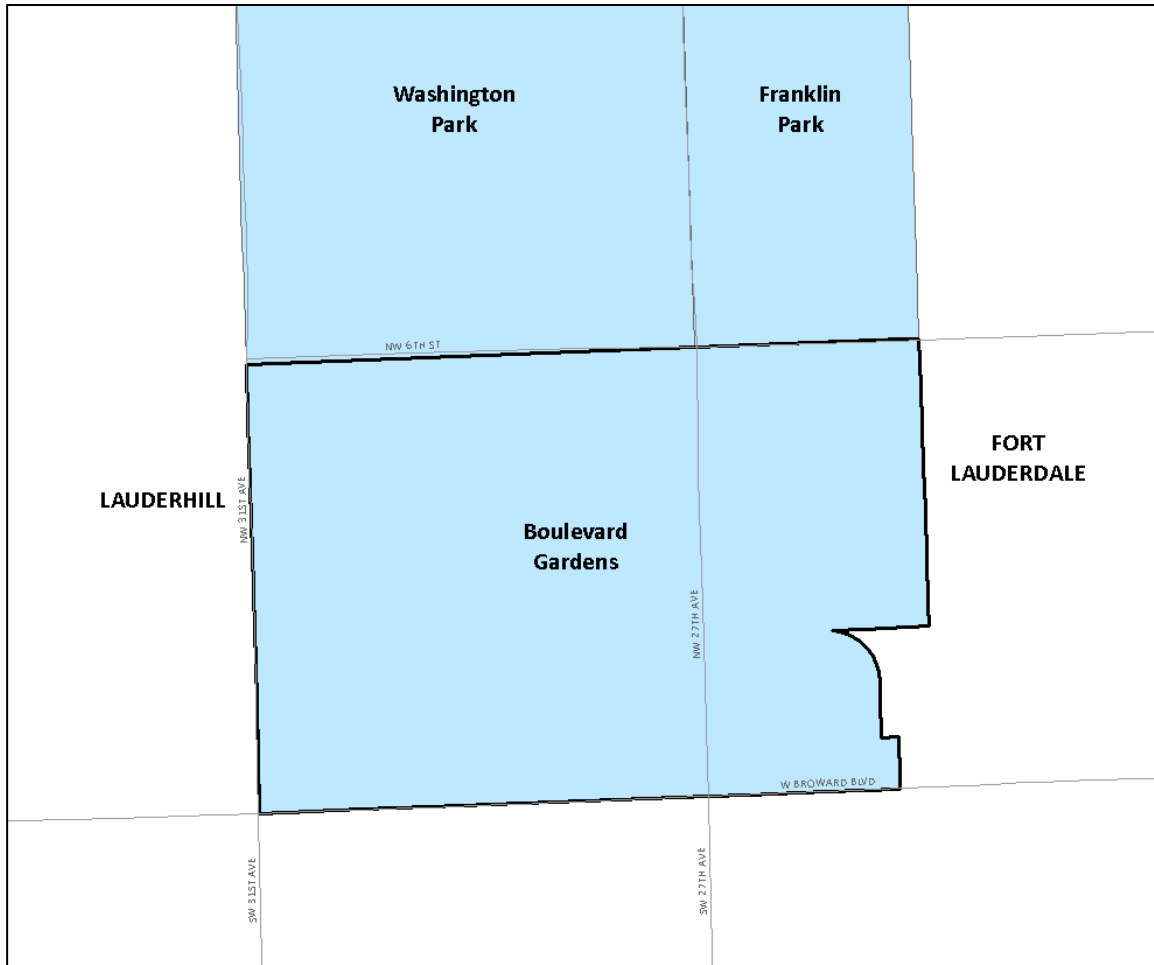

U.S. Congressional District	23
State Senate District	29
State House District	93
Broward Commission District	9

Zip Code	33311
----------	-------

Voting Precinct	Z034
-----------------	------

NEIGHBORHOOD PROFILE

Boulevard Gardens (8)

Land Area	
Acres	239
Square Miles	0.4

Race & Ethnicity (2010)	Persons	Percent
Total Persons	1,274	
Not-Hispanic:	1,241	97.4%
White	27	2.1%
Black	1,189	93.3%
Other Race	4	0.4%
Two or more Races	21	1.6%
Hispanic (any race)	33	2.6%

Public Schools	Number	Enrollment
Elementary	0	0
Middle	0	0
High	0	0

Service Providers	
Police	Broward Sheriff's Office
Fire/EMS	Broward County Fire Rescue
Water	Fort Lauderdale
Sanitary Sewer	Fort Lauderdale
Garbage	All Service Refuse* (until January 2012)

*Starting in January 2012, Choice Environmental Services of Broward

	2000	2010	Change
Population	1,415	1,274	-10.0%
Housing Units	489	475	-2.9%

Registered Voters (2011)			
Democrat	86.1%	White	1.2%
Republican	2.6%	Black	91.0%
Other	11.3%	Other Race	7.8%

Housing Type	2005-2009 (ACS*)
Single Family	93.1%
Multi-Family	6.9%
Mobile Homes & Other	0.0%

*American Community Survey (2005-2009 averages) – This survey has replaced the Decennial Census "long form". The Decennial Census does not report this data anymore.

Property Taxes	
<i>Unincorporated Millage Rate (2011)</i>	<i>0.0048577</i>
<small>*Includes fire rescue millage of 0.0025224</small>	
Taxable Value (1) and Estimated Property Tax (2)	
(1)	\$25,000 \$50,000 \$75,000 \$100,000
(2)	\$121.44 \$242.89 \$364.33 \$485.77

*The taxable value is determined by subtracting deductions such as the \$25,000-\$50,000 homestead exemption from the assessed value of the residence.

Notes:

Table DP-1. Profile of General Population and Housing Characteristics: 2010

Geographic Area: Boulevard Gardens CDP, Florida

[For more information on confidentiality protection, nonsampling error, and definitions, see <http://www.census.gov/prod/cen2010/profiletd.pdf>]

Subject	Number	Percent	Subject	Number	Percent
Total Population	1,274	100.0	HISPANIC OR LATINO AND RACE		
SEX AND AGE			Total population	1,274	100.0
Male	628	49.3	Hispanic or Latino	33	2.6
Female	646	50.7	Not Hispanic or Latino	1,241	97.4
Under 5 years	73	5.7	White alone	27	2.1
5 to 9 years	77	6.0	Black or African American alone	1,189	93.3
10 to 14 years	95	7.5	American Indian and Alaska Native alone	2	0.2
15 to 19 years	104	8.2	Asian alone	0	0.0
20 to 24 years	86	6.8	Native Hawaiian and Other Pacific Islander	0	0.0
25 to 29 years	79	6.2	Some Other Race alone	2	0.2
30 to 34 years	69	5.4	Two or More Races	21	1.6
35 to 39 years	74	5.8	RELATIONSHIP		
40 to 44 years	77	6.0	Total population	1,274	100.0
45 to 49 years	92	7.2	In households	1,274	100.0
50 to 54 years	113	8.9	Householder	419	32.9
55 to 59 years	80	6.3	Spouse	119	9.3
60 to 64 years	64	5.0	Child	395	31.0
65 to 69 years	53	4.2	Own child under 18 years	178	14.0
70 to 74 years	45	3.5	Other relatives	267	21.0
75 to 79 years	44	3.5	Under 18 years	125	9.8
80 to 84 years	29	2.3	65 years and over	24	1.9
85 years and over	20	1.6	Nonrelatives	74	5.8
Median age (years)	39.0	(X)	Unmarried partner	41	3.2
18 years and over	967	75.9	In group quarters	0	0.0
Male	462	47.2	Institutionalized population	0	0.0
Female	505	52.8	Noninstitutionalized population	0	0.0
21 years and over	906	66.3	HOUSEHOLDS BY TYPE		
62 years and over	227	11.4	Total households	419	100.0
65 years and over	191	9.5	Family households (families)	295	70.4
Male	74	37.1	With own children under 18 years	91	21.7
Female	117	62.9	Husband-wife family	119	28.4
RACE			With own children under 18 years	39	9.3
One Race	1,248	98.0	Male householder, no wife present	33	7.9
White	36	2.8	With own children under 18 years	12	2.9
Black or African American	1,202	94.3	Female householder, no husband present	143	34.1
American Indian and Alaska Native	2	0.2	With own children under 18 years	40	9.5
Asian	0	0	Nonfamily households	124	29.6
Asian Indian	0	0	Householder living alone	98	23.4
Chinese	0	0	65 years and over	35	8.3
Filipino	0	0	Households with individuals under 18 years	153	40.6
Japanese	0	0	Households with individuals 65 years and over	152	24.7
Korean	0	0	Average household size	3.04	(X)
Vietnamese	0	0	Average family size	3.65	(X)
Other Asian	0	0	HOUSING OCCUPANCY		
Native Hawaiian and Other Pacific Islander	0	0	Total housing units	475	100.0
Native Hawaiian	0	0	Occupied housing units	419	88.2
Guamanian or Chamorro	0	0	Vacant housing units	56	11.8
Samoan	0	0	For seasonal, recreational, or occasional use	1	0.2
Other Pacific Islander	0	0	Homeowner vacancy rate (percent)	1.7	(X)
Some Other Race	8	0.6	Rental vacancy rate (percent)	12.8	(X)
Two or More Races	26	2.0			
HISPANIC OR LATINO			HOUSING TENURE		
Total Population	1,274	100.0	Occupied housing units	419	100.0
Hispanic or Latino	1,221	95.8	Owner-occupied housing units	231	55.1
Mexican	1	0.1	Renter-occupied housing units	188	44.9
Puerto Rican	12	0.9	Average household size of owner-occupied	3.21	(X)
Cuban	3	0.2	Average household size of renter-occupied	2.84	(X)
Other Hispanic or Latino	17	1.3			
Not Hispanic or Latino	1,241	97.4			

NEIGHBORHOOD PROFILE
Broadview Park

Adjacent Municipalities:
 Fort Lauderdale
 Plantation
 Davie

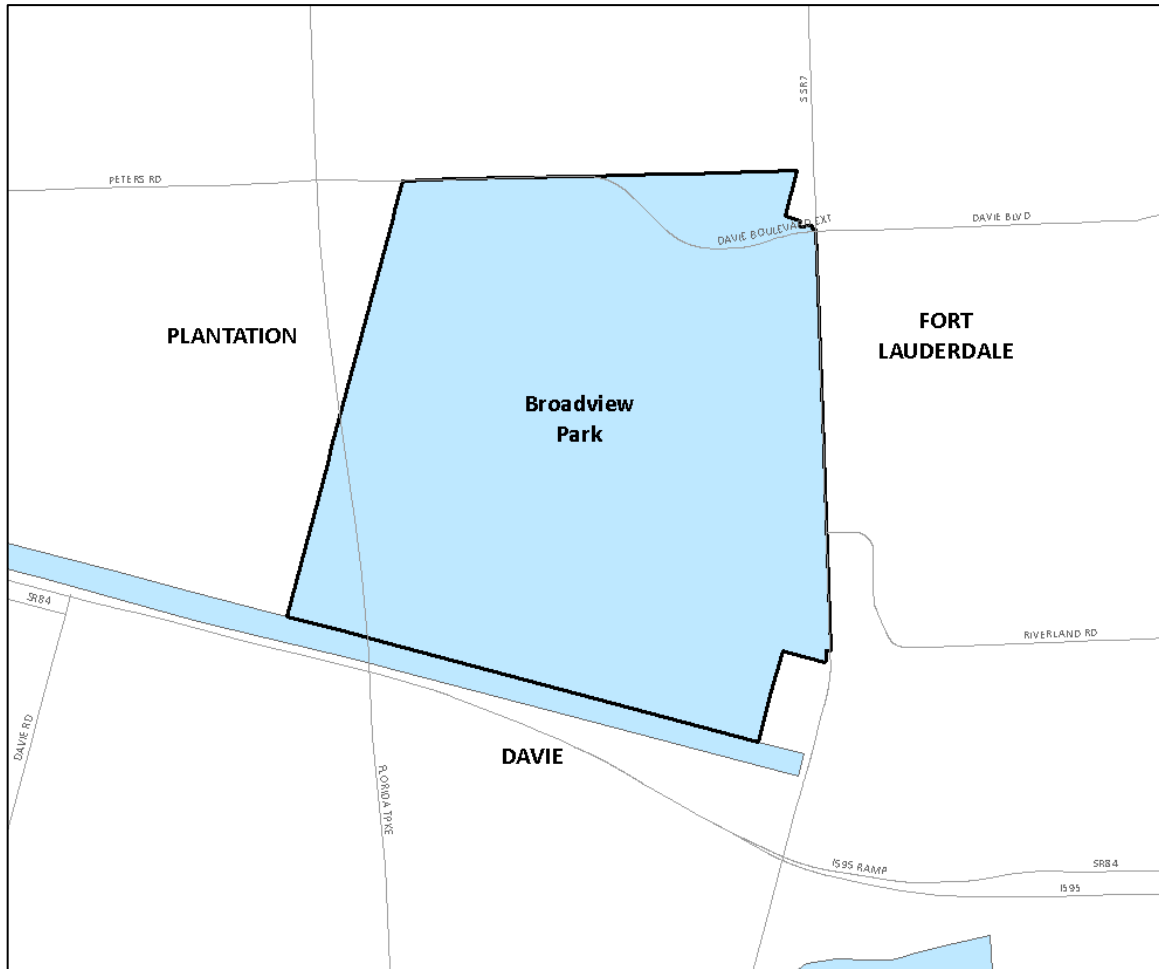

U.S. Congressional Districts	20,22
State Senate District	31
State House Districts	93,100
Broward Commission District	1,7

Zip Code	33311
----------	-------

Voting Precinct	Z034
-----------------	------

NEIGHBORHOOD PROFILE

Broadview Park (9)

Land Area		
Acres	688	
Square Miles	1.1	

	2000	2010	Change
Population	6,798	7,125	4.8%
Housing Units	2,267	2,280	0.6%

Race & Ethnicity (2010)	Persons	Percent
Total Persons	7,125	
Not-Hispanic:	2,882	40.4%
White	1,603	22.5%
Black	1,031	14.5%
Other Race	149	2.1%
Two or more Races	99	1.4%
Hispanic (any race)	4,243	59.6%

Registered Voters (2011)			
Democrat	50.2%	White	47.3%
Republican	23.8%	Black	15.1%
Other	26.0%	Other Race	37.6%

Public Schools	Number	Enrollment
Elementary	1	584
Middle	0	0
High	0	0

Housing Type	2005-2009 (ACS*)
Single Family	61.0%
Multi-Family	34.8%
Mobile Homes & Other	4.2%

*American Community Survey (2005-2009 averages) – This survey has replaced the Decennial Census “long form”. The Decennial Census does not report this data anymore.

Service Providers	
Police	Broward Sheriff's Office
Fire/EMS	Broward County Fire Rescue
Water	Broward County & Fort Lauderdale
Sanitary Sewer	Broadview Park
Garbage	All Service Refuse* (until January 2012)

*Starting in January 2012, Choice Environmental Services of Broward

Property Taxes	
<i>Unincorporated Millage Rate (2011)</i>	<i>0.0048577</i>
<small>*Includes fire rescue millage of 0.0025224</small>	
Taxable Value (1) and Estimated Property Tax (2)	
(1)	\$25,000 \$50,000 \$75,000 \$100,000
(2)	\$121.44 \$242.89 \$364.33 \$485.77

*The taxable value is determined by subtracting deductions such as the \$25,000-\$50,000 homestead exemption from the assessed value of the residence.

Notes:

Table DP-1. Profile of General Population and Housing Characteristics: 2010

Geographic Area: Broadview Park CDP, Florida

[For more information on confidentiality protection, nonsampling error, and definitions, see <http://www.census.gov/prod/cen2010/profiletd.pdf>]

Subject	Number	Percent	Subject	Number	Percent
Total Population	7,125	100.0	HISPANIC OR LATINO AND RACE		
SEX AND AGE			Total population	7,125	100.0
Male	3,756	52.7	Hispanic or Latino	4,243	59.6
Female	3,369	47.3	Not Hispanic or Latino	2,882	40.4
Under 5 years	543	7.6	White alone	1,603	22.5
5 to 9 years	437	6.1	Black or African American alone	1,031	14.5
10 to 14 years	549	7.7	American Indian and Alaska Native alone	10	0.1
15 to 19 years	558	7.8	Asian alone	135	1.9
20 to 24 years	548	7.7	Native Hawaiian and Other Pacific Islander	0	0.0
25 to 29 years	619	8.7	Some Other Race alone	4	0.1
30 to 34 years	583	8.2	Two or More Races	99	1.4
35 to 39 years	586	8.2	RELATIONSHIP		
40 to 44 years	559	7.8	Total population	7,125	100.0
45 to 49 years	590	8.3	In households	7,057	99.0
50 to 54 years	445	6.2	Householder	2,089	29.3
55 to 59 years	380	5.3	Spouse	965	13.5
60 to 64 years	273	3.8	Child	2,211	31.0
65 to 69 years	157	2.2	Own child under 18 years	1,482	20.8
70 to 74 years	96	1.3	Other relatives	915	12.8
75 to 79 years	103	1.4	Under 18 years	323	4.5
80 to 84 years	63	0.9	65 years and over	103	1.4
85 years and over	36	0.5	Nonrelatives	877	12.3
Median age (years)	32.6	(X)	Unmarried partner	244	3.4
18 years and over	5,256	73.8	In group quarters	68	1.0
Male	2,785	39.1	Institutionalized population	4	0.1
Female	2,471	34.7	Noninstitutionalized population	64	0.9
21 years and over	4,931	69.2	HOUSEHOLDS BY TYPE		
62 years and over	611	8.6	Total households	2,089	100.0
65 years and over	455	6.4	Family households (families)	1,589	76.1
Male	208	2.9	With own children under 18 years	857	41.0
Female	247	3.5	Husband-wife family	965	46.2
RACE			With own children under 18 years	508	24.3
One Race	6,850	96.1	Male householder, no wife present	241	11.5
White	4,964	69.7	With own children under 18 years	113	5.4
Black or African American	1,124	15.8	Female householder, no husband present	383	18.3
American Indian and Alaska Native	21	0.3	With own children under 18 years	236	11.3
Asian	138	1.9	Nonfamily households	500	23.9
Asian Indian	55	0.8	Householder living alone	279	13.4
Chinese	6	0.1	65 years and over	81	3.8
Filipino	24	0.3	Households with individuals under 18 years	1,010	48.3
Japanese	0	0	Households with individuals 65 years and over	355	17.0
Korean	1	0	Average household size	3.38	(X)
Vietnamese	37	0.5	Average family size	3.57	(X)
Other Asian	15	0.2	HOUSING OCCUPANCY		
Native Hawaiian and Other Pacific Islander	0	0	Total housing units	2,280	100.0
Native Hawaiian	0	0	Occupied housing units	2,089	91.6
Guamanian or Chamorro	0	0	Vacant housing units	191	8.4
Samoan	0	0	For seasonal, recreational, or occasional use	7	0.3
Other Pacific Islander	0	0	Homeowner vacancy rate (percent)	2.1	(X)
Some Other Race	603	8.5	Rental vacancy rate (percent)	6.9	(X)
Two or More Races	275	3.9	HOUSING TENURE		
HISPANIC OR LATINO			Occupied housing units	2,089	100.0
Total Population	7,125	100.0	Owner-occupied housing units	1,119	53.6
Hispanic or Latino	4,243	59.6	Renter-occupied housing units	970	46.4
Mexican	356	5.0	Average household size of owner-occupied	3.24	(X)
Puerto Rican	441	6.2	Average household size of renter-occupied	3.54	(X)
Cuban	1,219	17.1			
Other Hispanic or Latino	2,227	31.3			
Not Hispanic or Latino	2,882	40.4			

Parcel Profiles

NEIGHBORHOOD PROFILE
Hillsboro Ranches

Adjacent Municipalities:
 Coconut Creek

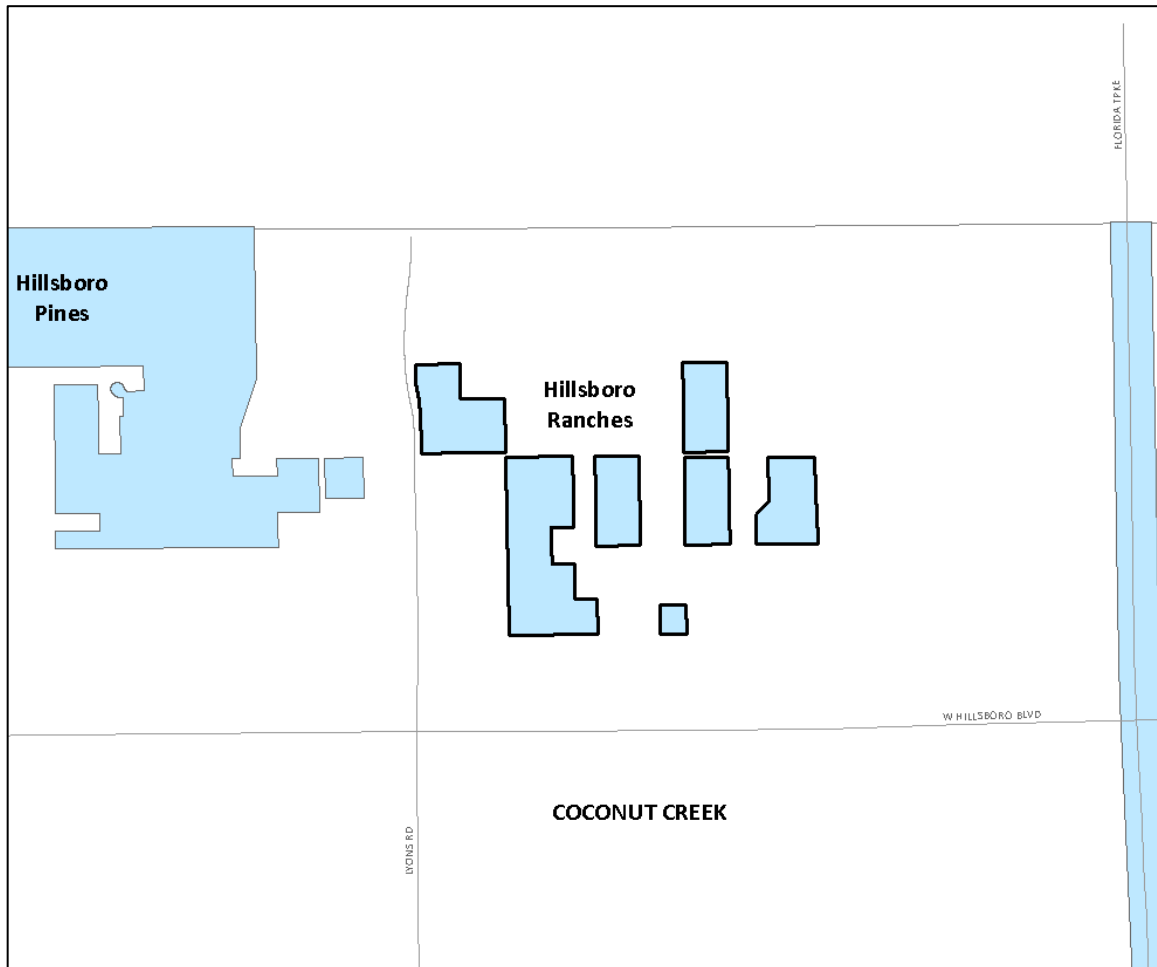

U.S. Congressional District	22
State Senate District	30
State House District	90
Broward Commission District	2

Zip Code
33073

Voting Precinct
F015

NEIGHBORHOOD PROFILE

Hillsboro Ranches (3)

Land Area	
Acres	44
Square Miles	0.1

	2000	2010	Change
Population	47	72	53.2%
Housing Units	19	23	21.1%

Race & Ethnicity (2010)	Persons	Percent
Total Persons	72	
Not-Hispanic:	66	91.7%
White	57	79.2%
Black	1	1.4%
Other Race	3	4.2%
Two or more Races	5	6.9%
Hispanic (any race)	6	8.3%

Property Taxes	
<i>Unincorporated Millage Rate (2011)</i>	<i>0.0048577</i>
<i>*Includes fire rescue millage of 0.0025224</i>	
Taxable Value (1) and Estimated Property Tax (2)	
(1)	\$25,000 \$50,000 \$75,000 \$100,000
(2)	\$121.44 \$242.89 \$364.33 \$485.77
<i>*The taxable value is determined by subtracting deductions such as the \$25,000-\$50,000 homestead exemption from the assessed value of the residence.</i>	

Public Schools	Number	Enrollment
Elementary	0	0
Middle	0	0
High	0	0

Notes:
Data Sources:
<i>U.S. Census, 2000 & 2010</i>
<i>American Community Survey (2005-2009)</i>
<i>Supervisor of Elections, 2010</i>
<i>Planning and Redevelopment Division, 2011</i>

Service Providers	
Police	Broward Sheriff's Office
Fire/EMS	Broward County Fire Rescue
Water	Broward County
Sanitary Sewer	Coconut Creek
Garbage	Waste Management* (until January 2012)
*Starting in January 2012, City of Coconut Creek	

NEIGHBORHOOD PROFILE
Northwest County Parcels

Adjacent Municipalities:
 Parkland

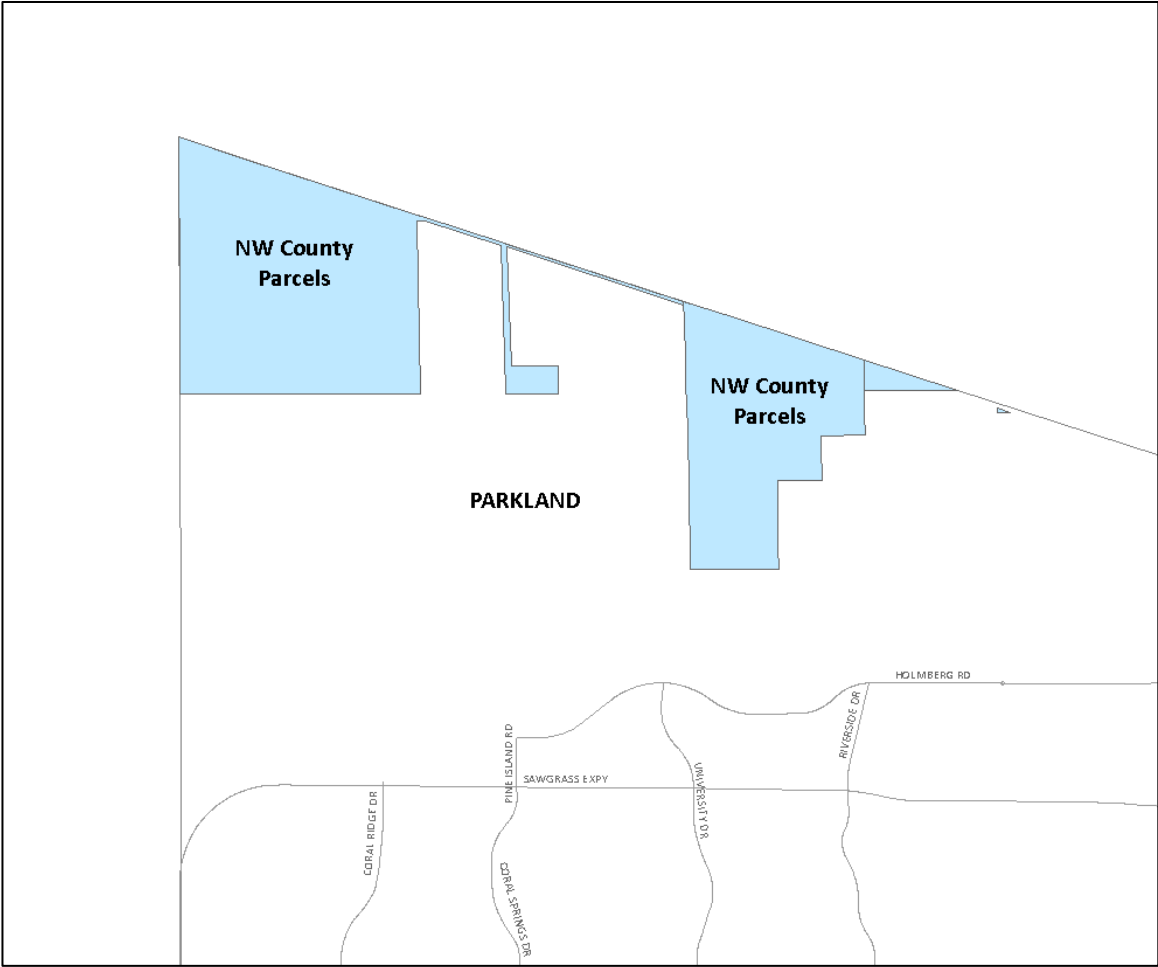

U.S. Congressional District	19
State Senate District	32
State House District	97
Broward Commission District	3

Zip Codes
33067
33076

Voting Precinct
Q040

NEIGHBORHOOD PROFILE

Northwest County Parcels (1)

Land Area	
Acres	1809
Square Miles	2.8

	2000	2010	Change
Population*	n/a	15	n/a
Housing Units*	n/a	5	n/a

Race & Ethnicity (2010)	Persons	Percent
Total Persons	15	
Not-Hispanic:	15	0%
White	0	0%
Black	0	0%
Other Race	0	0%
Two or more Races	0	0%
Hispanic (any race)	15	100.0%

Property Taxes	
<i>Unincorporated Millage Rate (2011)</i>	0.0048577
<i>*Includes fire rescue millage of 0.0025224</i>	
Taxable Value (1) and Estimated Property Tax (2)	
(1)	\$25,000 \$50,000 \$75,000 \$100,000
(2)	\$121.44 \$242.89 \$364.33 \$485.77
<i>*The taxable value is determined by subtracting deductions such as the \$25,000-\$50,000 homestead exemption from the assessed value of the residence.</i>	

Public Schools	Number	Enrollment
Elementary	0	0
Middle	0	0
High	0	0

Notes:
Data Sources:
<i>U.S. Census, 2000 & 2010</i>
<i>American Community Survey (2005-2009)</i>
<i>Supervisor of Elections, 2010</i>
<i>Planning and Redevelopment Division, 2011</i>

Service Providers	
Police	Broward Sheriff's Office
Fire/EMS	Broward County Fire Rescue
Water	No service
Sanitary Sewer	No service
Garbage	No service

NEIGHBORHOOD PROFILE
Sunrise Six

Adjacent Municipalities:
Sunrise



U.S. Congressional District	20
State Senate District	34
State House District	97
Broward Commission District	5

Zip Code
33326

Voting Precinct
M029

NEIGHBORHOOD PROFILE

Sunrise Six (14)

Land Area	
Acres	2
Square Miles	0.003

	2000	2010	Change
Population*	n/a	20	n/a
Housing Units*	n/a	6	n/a

Race & Ethnicity (2010)	Persons	Percent
Total Persons	20	
Not-Hispanic:	11	55.0%
White	11	55.0%
Black	0	0%
Other Race	0	0%
Two or more Races	0	0%
Hispanic (any race)	9	45.0%

Property Taxes				
<i>Unincorporated Millage Rate (2011)</i>			0.0048577	
<small>*Includes fire rescue millage of 0.0025224</small>				
Taxable Value (1) and Estimated Property Tax (2)				
(1)	\$25,000	\$50,000	\$75,000	\$100,000
(2)	\$121.44	\$242.89	\$364.33	\$485.77
<small>*The taxable value is determined by subtracting deductions such as the \$25,000-\$50,000 homestead exemption from the assessed value of the residence.</small>				

Public Schools	Number	Enrollment
Elementary	0	0
Middle	0	0
High	0	0

Notes:
Data Sources:
<i>U.S. Census, 2000 & 2010</i>
<i>American Community Survey (2005-2009)</i>
<i>Supervisor of Elections, 2010</i>
<i>Planning and Redevelopment Division, 2011</i>

Service Providers	
Police	Broward Sheriff's Office
Fire/EMS	Broward County Fire Rescue
Water	Sunrise
Sanitary Sewer	Sunrise
Garbage	Waste Management* (until January 2012)
<small>*Starting in January 2012, All Service Refuse</small>	

Appendix

Appendix A – Description of Data Sources

1. U.S. Census Bureau

This report uses data from the Decennial Censuses, 2000 and 2010. Most unincorporated neighborhoods are classified as a “Census Designated Place” (CDP). Population, race, ethnicity, and housing data were obtained from this source. Detailed information about the Census and the data collected can be found on the Census Bureau’s website at <http://www.census.gov>. More data from the 2010 Decennial Census can be found at <http://factfinder2.census.gov>.

2. American Community Survey (ACS)

The ACS is an annual survey conducted by the U.S. Census Bureau, replacing the “long form” formerly used in the decennial Census. The ACS survey is conducted every year to provide up-to-date information about the social and economic needs of your community. The ACS publishes 1-year, 3-year and 5-year averages. The 2005-2009 averages were used in this report. Additional information is available at the at <http://www.census.gov/acs/www/>.

3. Broward County Supervisor of Elections

The Broward County Supervisor of Elections Office supervises and provides information about the registration of voters and elections. The data on registered voters in this report are from June 2011. This report provides the percentage breakdowns, by party affiliation and by race, for the voter precincts in which the unincorporated neighborhoods are located. Additional information is available at the Broward County Supervisor of Elections web site at <http://www.browardsoe.org>.

4. The School Board of Broward County

The School Board of Broward County provides a list of the County schools and their enrollment as of the 20th day of the school year. Additional information is available at the School Board of Broward County’s web site at <http://www.browardschools.com>.

5. Broward County Planning and Redevelopment Division (PRD)

The Planning and Redevelopment Division of the Environmental Protection and Growth Management Department, provides a variety of demographic and economic data, and GIS layers to County agencies and the public. For more information about PRD, data and maps, visit our website at <http://www.broward.org/PlanningAndRedevelopment>.

Appendix A

6. **Broward County Solid Waste and Recycling Services (WRS)**

Solid Waste and Recycling Services is responsible for providing residential solid waste and recycling collection services to the single family homes in Unincorporated Broward County. Currently, All Service Refuse and Waste Management are contracted for solid waste and recycling collections in the unincorporated areas. Starting in January 2012, Choice Environmental of Broward, Inc will become the exclusive franchisee for the unincorporated neighborhoods of Roosevelt Gardens, Washington Park, Franklin Park, Boulevard Gardens and Broadview Park for the residential and commercial container collection. The Hillsboro Pines and Hillsboro Ranches neighborhoods will be receiving service from the contractor for the City of Coconut Creek. The Sunrise Six residents will be receiving service from the contractor for the City of Sunrise, All Service Refuse. Finally, the unincorporated areas around the airport will be an open market for commercial customers to select their own vendor for solid waste collection services. This will also be the case for other remaining unincorporated areas such as the correctional facility near the Southwest Ranches landfill, the Turnpike rest area in Pompano Beach and a scattering of commercial accounts along HWY 27.

Prepared by the
Environmental Protection and Growth Management Department
Planning and Redevelopment Division
115 South Andrews Avenue, Room 329K
Fort Lauderdale, FL 33301

954-357-6634

<http://www.broward.org/environmentandgrowth>

This publication can be made available in large print, tape cassette, or braille, upon request.

An equal opportunity employer and provider of services.
