



Cruise Operations and Ground Transportation Handbook

2023-2024 Season



Table of Contents

Acronyms	1
Contact List	1
SP Plus Curbside Management Joint Venture	3
Introduction	2
Cruise – Charter Bus Procedures Arriving from Seaports	4
Preliminary Set-up	4
Unloading Provisions.....	4
Buses (Upper Level)	4
Buses (Lower Level)	5
Airline Terminal List.....	7
Ticket Counter Que Overflow Lines	8-11
Cruise-Charter Bus Procedures Departing to Seaports	12
Meet & Greet Personnel	12
Ground Transportation Staging Area.....	17
Ground Transportation Staging Area Map	17-18
Cruise Procedure Departing to the Seaports (Lower Level)	19
Authorized Passenger Loading	19
Ground Transportation Areas (GTAs)	20
Ride Share Locations.....	20
Provisions for All Terminals	21
Authorized Vehicles.....	21
Baggage Truck Loading	21
Ground Transportation Information Booth	22
Cruise Schedules	23-34

Acronyms

AOCC	=	Airport Operations Control Center
ARFF	=	Aircraft Rescue Fire Fighting
ASO	=	Airport Safety Officer
BCAD	=	Broward County Aviation Department
BSO	=	Broward Sheriff's Office
CBP	=	U.S. Customs and Border Protection
FAA	=	Federal Aviation Administration
FIS	=	Federal Inspection Station
FLL	=	Fort Lauderdale-Hollywood International Airport
GTA	=	Ground Transportation Area
PEV	=	Port Everglades
POM	=	Port of Miami
RBS	=	Remote Baggage Screening
TSA	=	Transportation Security Administration
SP Curbside	=	SP Plus Curbside Management Joint Venture

Contact List

Airport Operations Control Center:	(954) 359-1201
BCAD Operations Supervisor:	(954) 359-1201
BSO (non-emergency):	(954) 764-3911
SP Curbside on Duty Supervisor:	(954)-270-9535

Introduction

Welcome to the 2023-2024 Cruise Season at Fort Lauderdale-Hollywood International Airport (FLL). Broward County Aviation Department (BCAD) understands, once again, it will take a total team effort among BCAD, Airlines, Cruise Lines, Meet & Greet Personnel, SP Curbside and the Bus Operators to move the passengers and their baggage between FLL PEV and POM. BCAD has developed this Cruise Operations and Ground Transportation Handbook as a guideline to follow when dropping off and picking up cruise passengers and baggage at the Airport. The procedures outlined in this handbook have been developed and modified throughout the years with input from its users and will continue to be adjusted as operational requirements dictate. Please read and discuss these procedures with your team members. It is important that we all follow these procedures to ensure a successful season.

With your continuing cooperation, we will be able to move passengers to and from the seaports safely and efficiently. Good luck and have a great season!



SP Plus Curbside Management Joint Venture

SP Plus Curbside Management Joint Venture has been engaged by BCAD to provide ground transportation management services at the airport. These services include but are not limited to, the management of the staging lot(s) and Ground Transportation Areas used by charter buses providing service to the seaport. SP Curbside personnel are available to provide curbside assistance to seaport passengers and assist bus operators with expediting the passenger loading process.



Cruise – Charter Bus Procedures Arriving from PEV and POM

Preliminary Set-up

By 8:00AM on cruise days, designated areas (bus lanes) will be cleared of all vehicles by BSO, and SP Curbside will monitor and assist in accordance with the Cruise Operations and Ground Transportation Handbook.

Unloading Provisions

1. Airlines are to have sufficient skycap and wheelchair personnel available.
2. Cruise Lines will provide Customer Service Representatives.
3. SP Curbside will assign staff for unloading coordination.
4. BSO will provide ASO/BSO personnel for traffic control.

Buses (Upper Level)

Cruise activity is prohibited on the upper level.

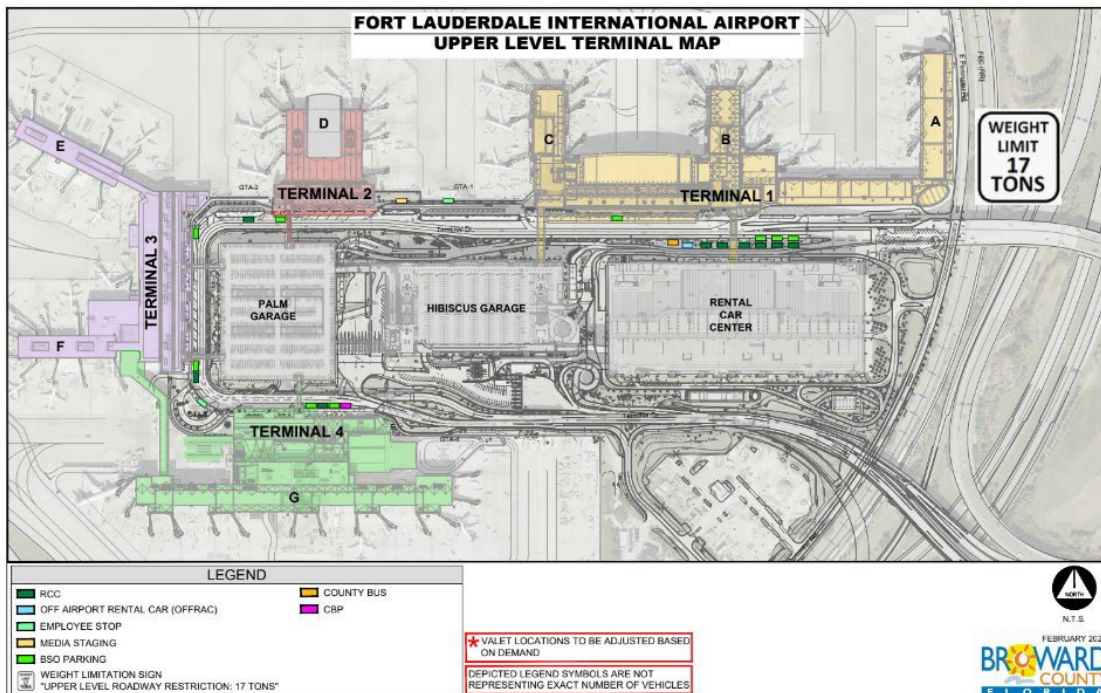

Buses (Lower Level)

1. The first stop, Ground Transportation Area (GTA) GTA-1, is for airlines in Terminal 1 (A, B and C Concourses), the second stop, GTA-2, is for airlines in Terminals 2 and 3 (D, E and F Concourses), the third stop is at the east end of Terminal 4 with coordination approval by SP Curbside GTA-4 for airlines in Terminals 4 (G Concourses).
2. Buses will pull into the bus lanes and park as directed by BCAD, SP Curbside or BSO.
3. Bus operators will have passengers remain on board during the unloading of their baggage.
4. Once the baggage has been unloaded, passengers will be allowed to debark from the buses and the buses will leave immediately.
5. Passengers will identify their baggage and proceed to the respective airline check-in counters.
6. No loading or unloading of passengers or luggage from the left side of the charter bus.
7. When GTAs have reached capacity, SP Curbside will implement the following:
 - SP Curbside will notify BSO at Port Everglades to hold motor coaches
 - Once a hold is placed on the motor coaches has been exhausted, SP Curbside will work with each motor coach company and stage buses in the Northwest Staging lot at FLL
8. When spaces become free within the GTAs, SP Curbside will notify the motor coach company to release motor coaches from the staging lot and to proceed to the specific GTA determined available in the event the GTAs on the arrivals level become congested with charter buses unloading passengers, the following steps will be implemented
 - Charter Bus supervisors will communicate with SP Curbside via cell phone. When a GTA space becomes available, the first bus in line at the staging area will be dispatched.
 - SP Curbside, as normal operation, will ensure that all buses follow the rules and regulations of FLL regarding expediting unloading of luggage first and then passengers, as well as NO DWELLING and NO ANGLED PARKING is allowed at the GTAs.

FORT LAUDERDALE INTERNATIONAL AIRPORT LOWER LEVEL TERMINAL MAP

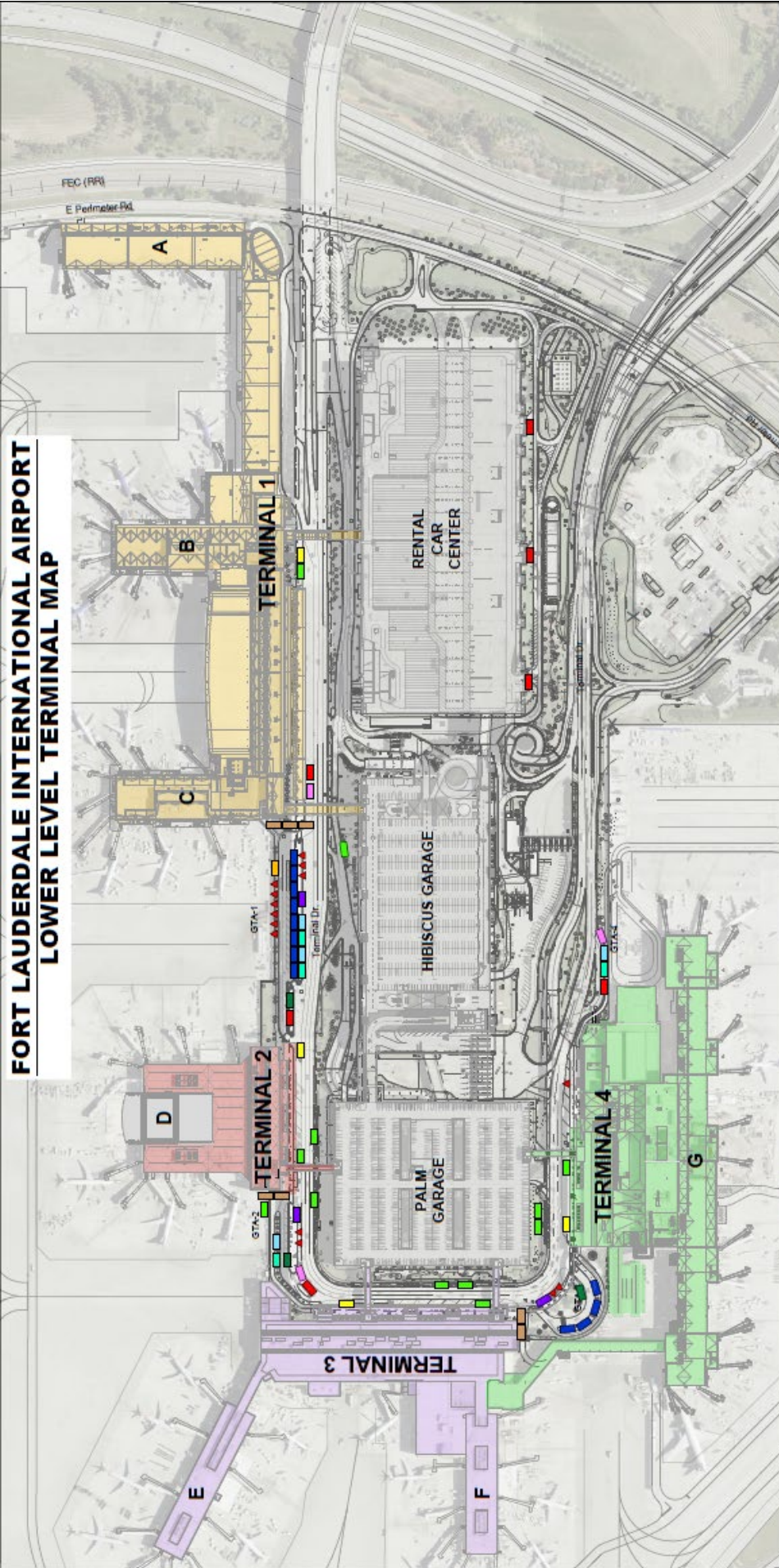

LEGEND

	RCC / COUNTY BUS		LIMO, MINIBUS, SEDAN, VAN
	TAXI		CRUISE BAGGAGE TRUCKS
	OFF AIRPORT PARKING		RIDE SHARING
	TRI-RAIL & BRIGHTLINE		DELIVERY VEHICLE
	CRUISE OPS		Gate 100 & Garages
	LONG-HAUL BUSES		Vehicle must be attended at all times.
			All vehicles are subject to security inspection.
			Deliveries 24/7
			BSO PARKING
			SHUTTLE TO HOTELS

DEPICTED LEGEND SYMBOLS ARE NOT REPRESENTING EXACT NUMBER OF VEHICLES

TERMINAL 1	TERMINAL 2	TERMINAL 3	TERMINAL 4
Concourses A, B, and C	Concourse D	Concourses E and F	Concourse G
Alaska (Departs C)	Air Canada (Departs D)	American (Departs E)	Air Transat (Departs E and G)
Allegiant (Departs C)	Delta (Departs D)	Avelo (Departs E and G)	Avianca (Departs G)
Bahamas Air (Departs A)	WestJet (Departs D)	Azul (Departs E and G)	Caribbean Airlines (Departs G)
Frontier (Departs C)		Flair (Departs E and G)	Copa (Departs G)
Silver (Departs C)		JetBlue (Departs E, F and G)	Spirit (Departs E, F and G)
Southwest (Departs A and B)		Sun Country (Concourse E)	Swoop Airlines (Arrives G)
United (Departs C)		Swoop Airlines (Departure E)	EI AI (Departure G)
Western Air (Departs C)		Bermuda Air (Departure G)	
		Air Transat (Arrives E)	

Ticket Counter Queue Overflow Lines

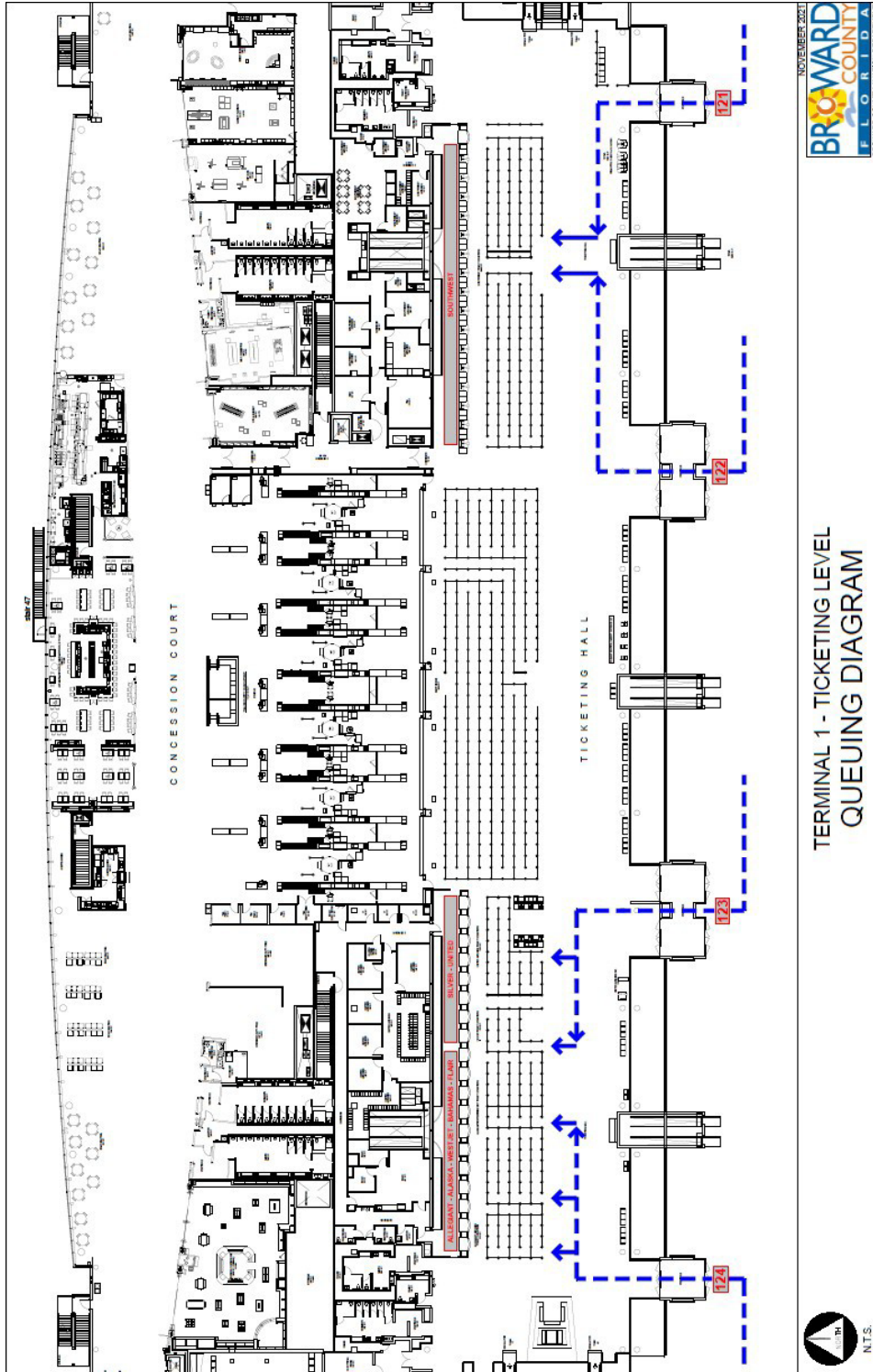

TERMINAL 1 - TICKETING LEVEL
QUEUING DIAGRAM

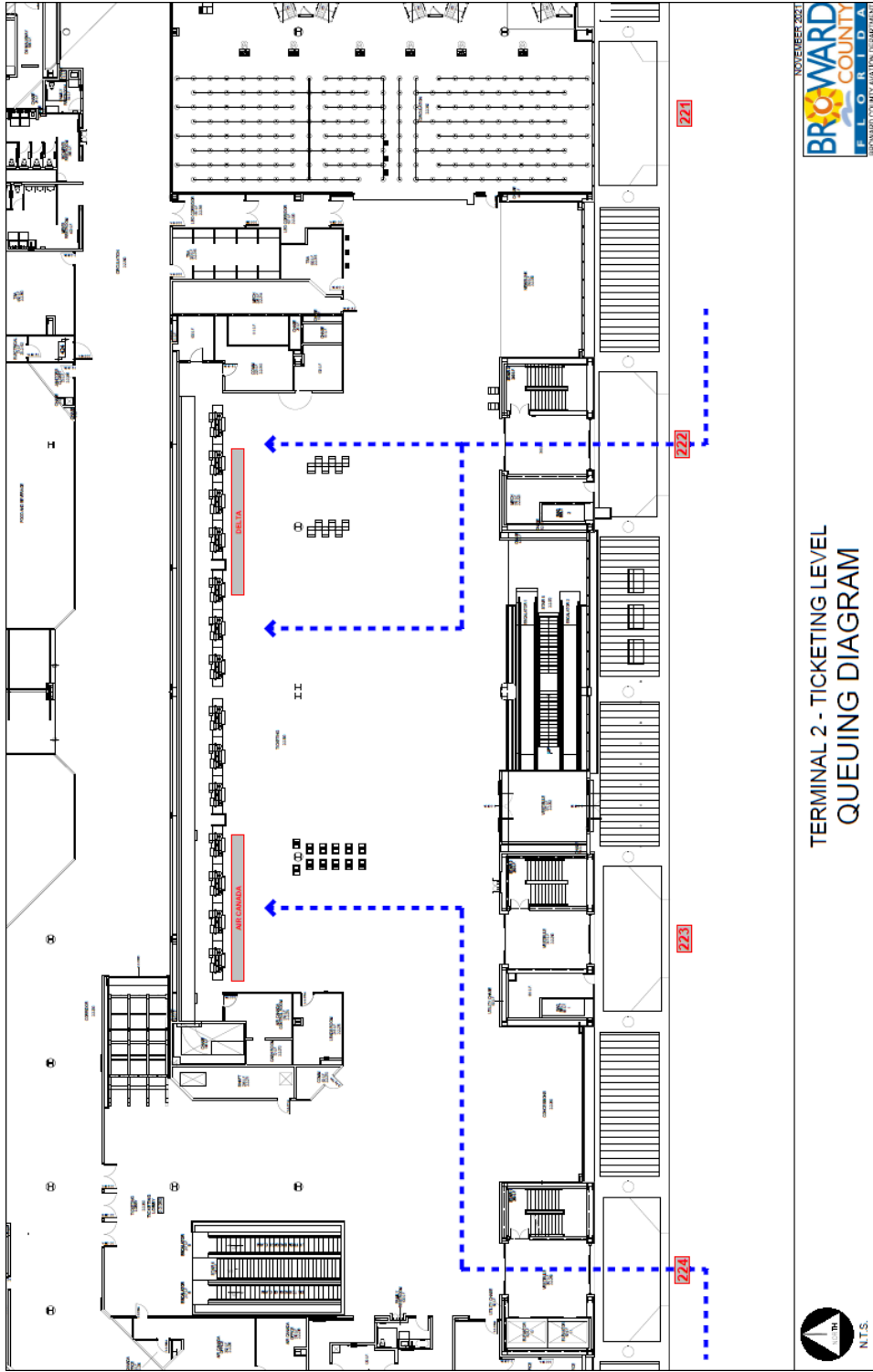

TERMINAL 2 - TICKETING LEVEL
QUEUING DIAGRAM



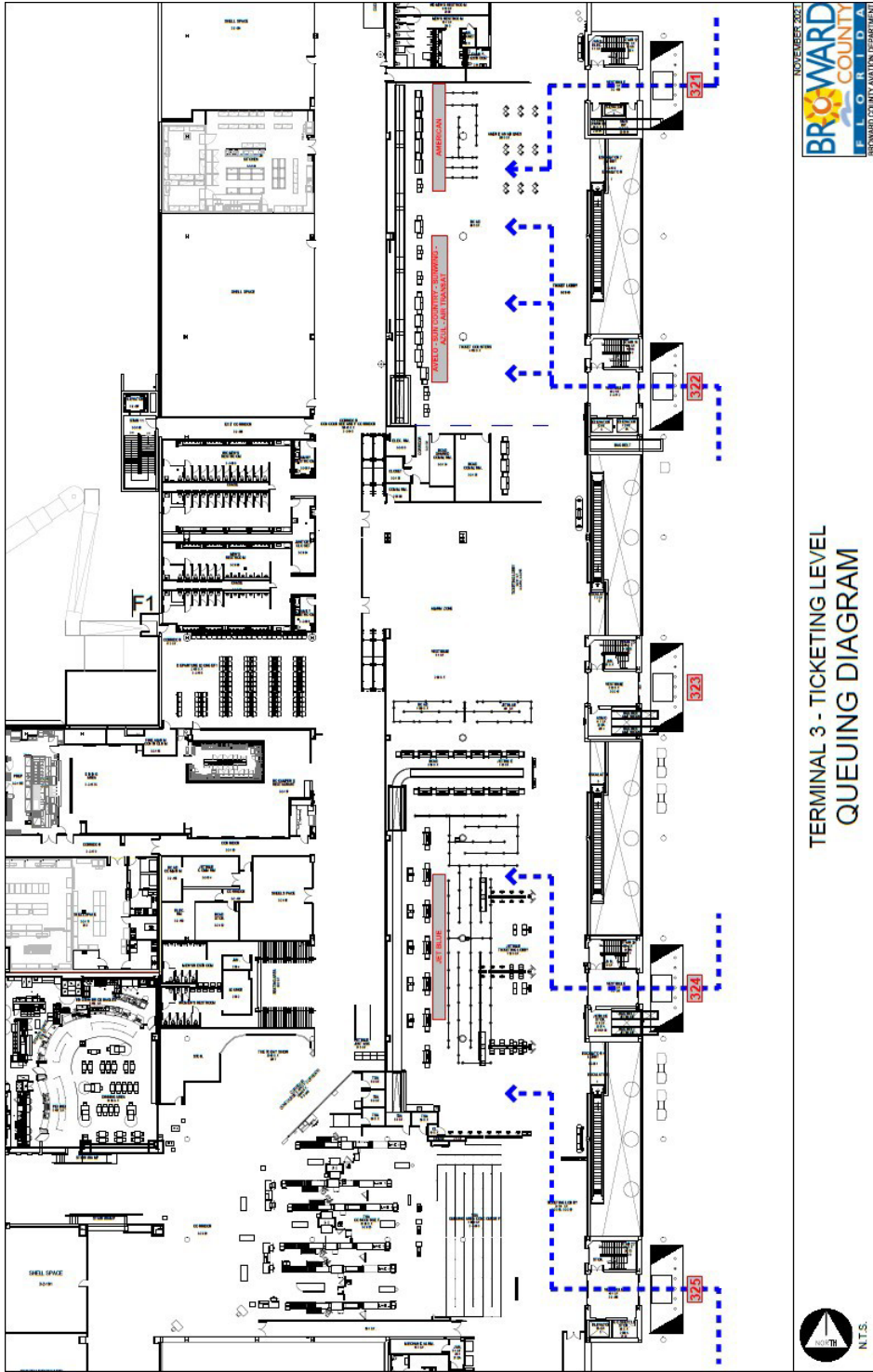

TERMINAL 3 - TICKETING LEVEL
QUEUING DIAGRAM



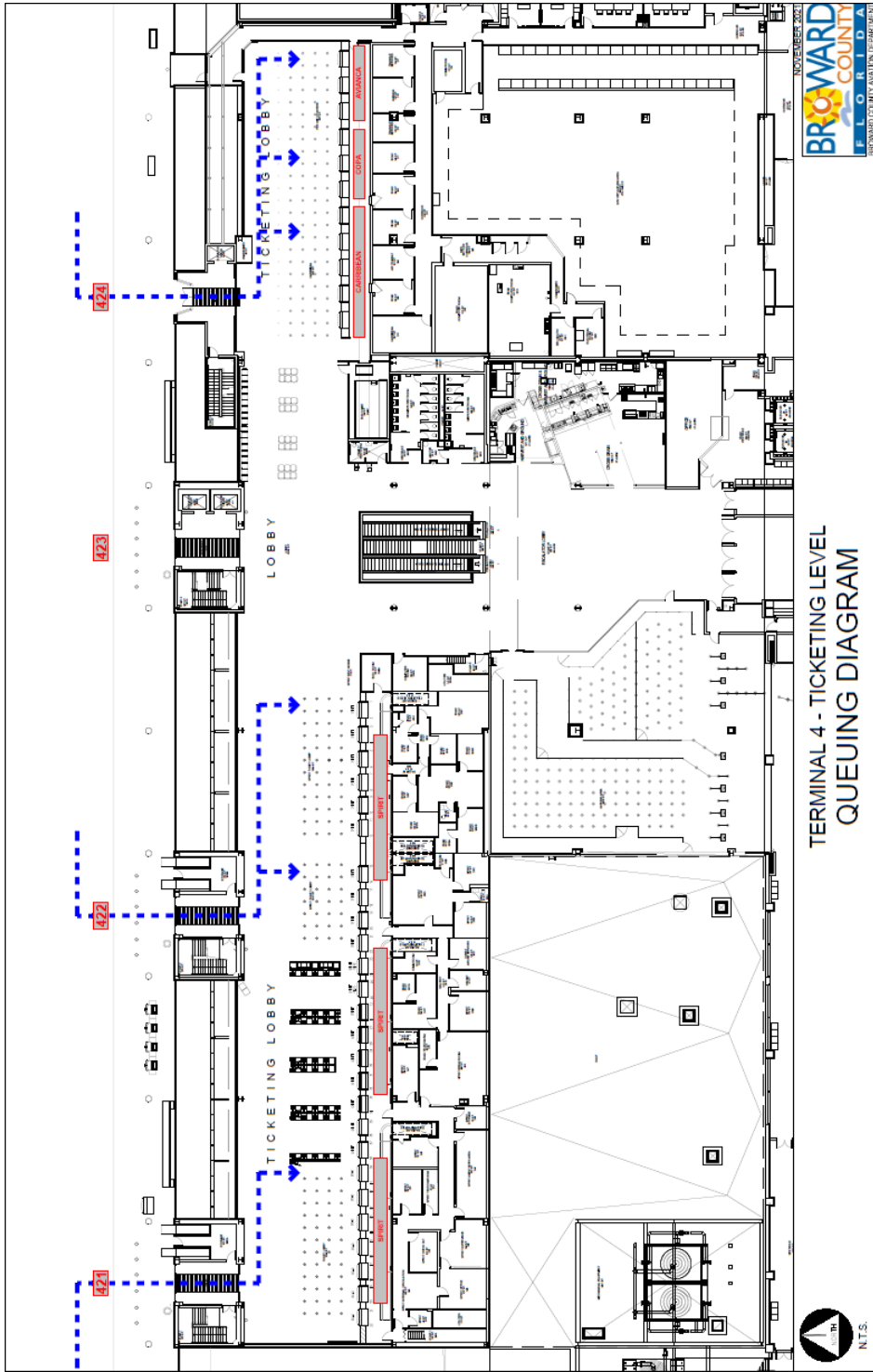

TERMINAL 4 - TICKETING LEVEL
QUEUING DIAGRAM

Cruise-Charter Bus Procedures Departing to Seaports

Meet & Greet Personnel

It will be the function of the “Meet and Greet” personnel to gather their groups, ensure all passengers claim their baggage, and assemble groups in designated areas prior to their departure from the Airport. While waiting for cruise guest, meet and greeters should stay clear from escalator thresholds.

1. BCAD has established the use of mobile cruise podiums in designated assembly areas. Areas shall remain clean and free from paper, coffee cups and other items on and around the area.
2. Each cruise line will have no more than one cruise podium in each terminal baggage claim area.
3. The cruise podiums will be used by cruise line representatives for passenger processing. Cruise lines will be assigned positions to locate their cruise processing podium and assemble groups.

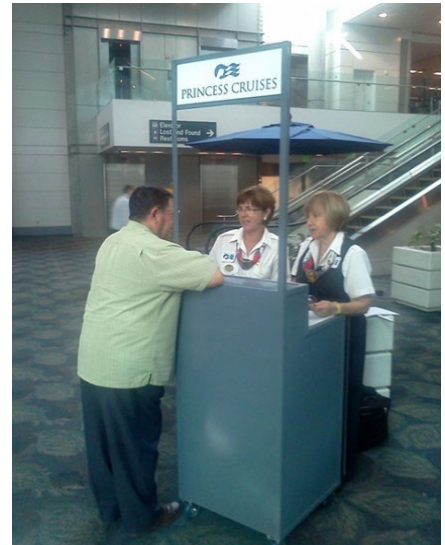

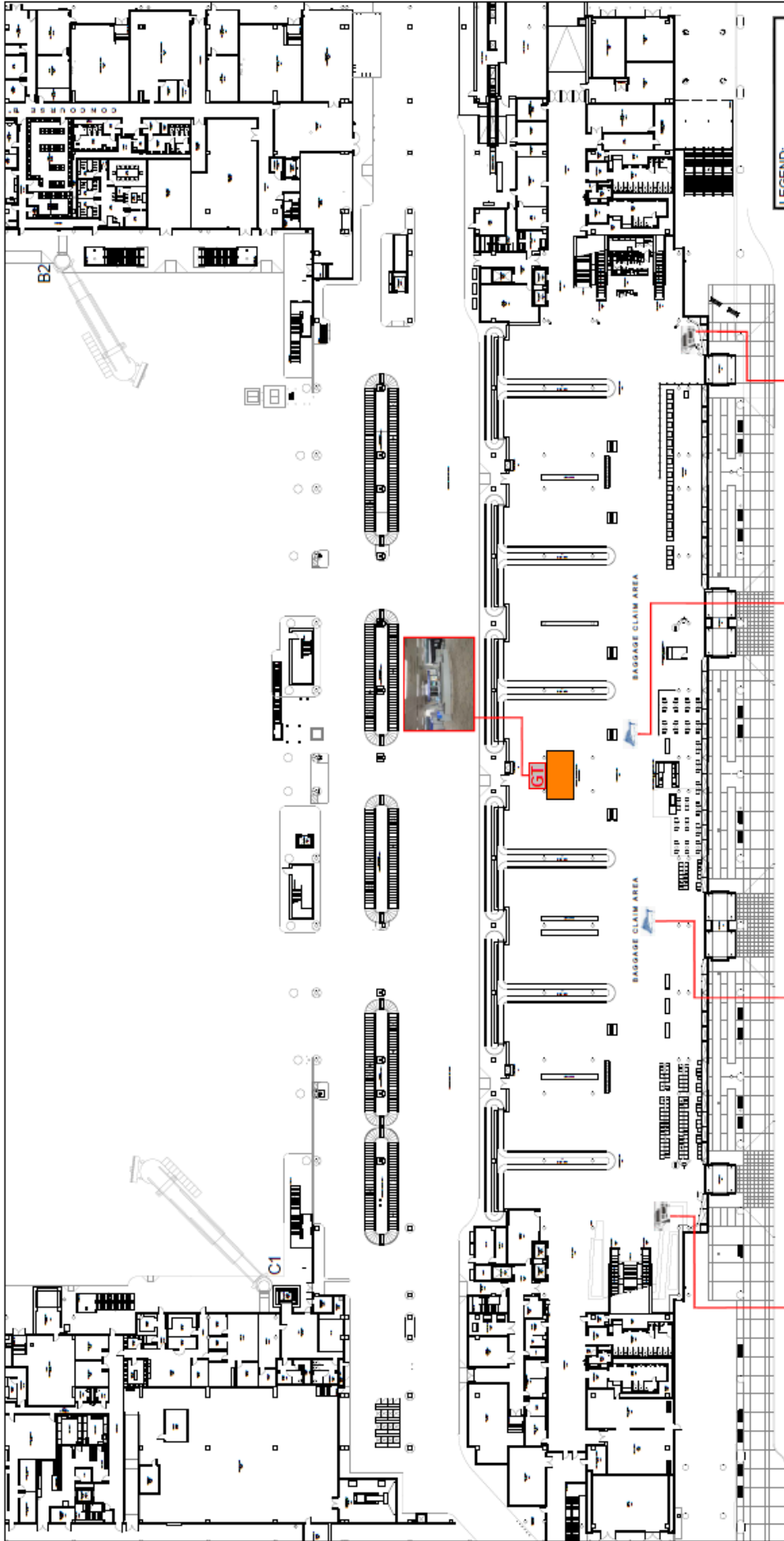

LEGEND:

- CRUISE ASSEMBLY POINTS
- PREARRANGED MEETING POINTS
- POINTS
- GROUND TRANSPORTATION
- BOOTH

OCTOBER 2022

BROWARD COUNTY AVIATION DEPARTMENT

TERMINAL 1 - BAGGAGE CLAIM LEVEL CRUISE / PREARRANGED / GROUND TRANSPORTATION



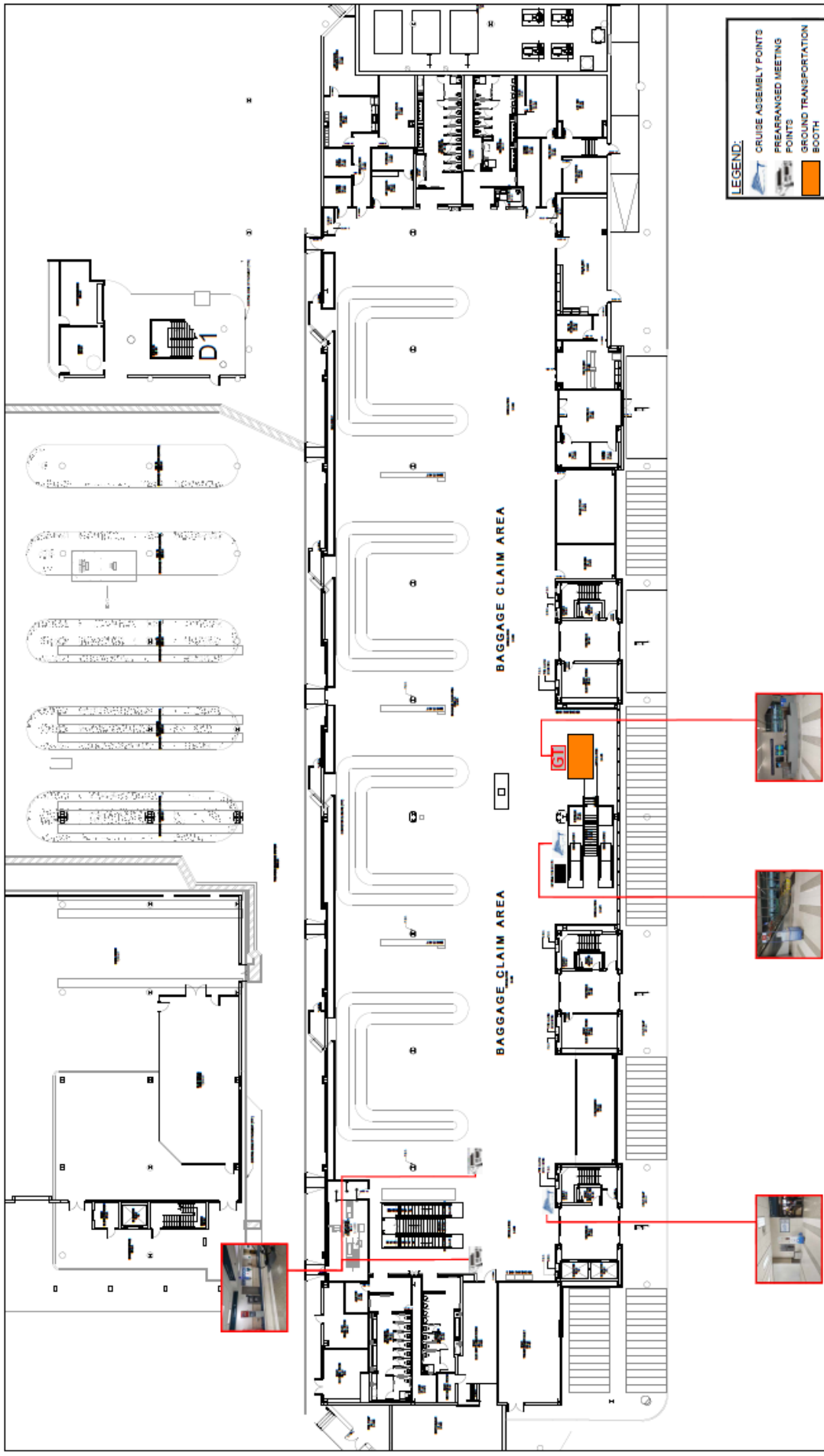

LEGEND:
 CRUISE ASSEMBLY POINTS
 PREARRANGED MEETING POINTS
 GROUND TRANSPORTATION
 BOOTH



TERMINAL 2 - BAGGAGE CLAIM LEVEL
 CRUISE / PREARRANGED / GROUND TRANSPORTATION



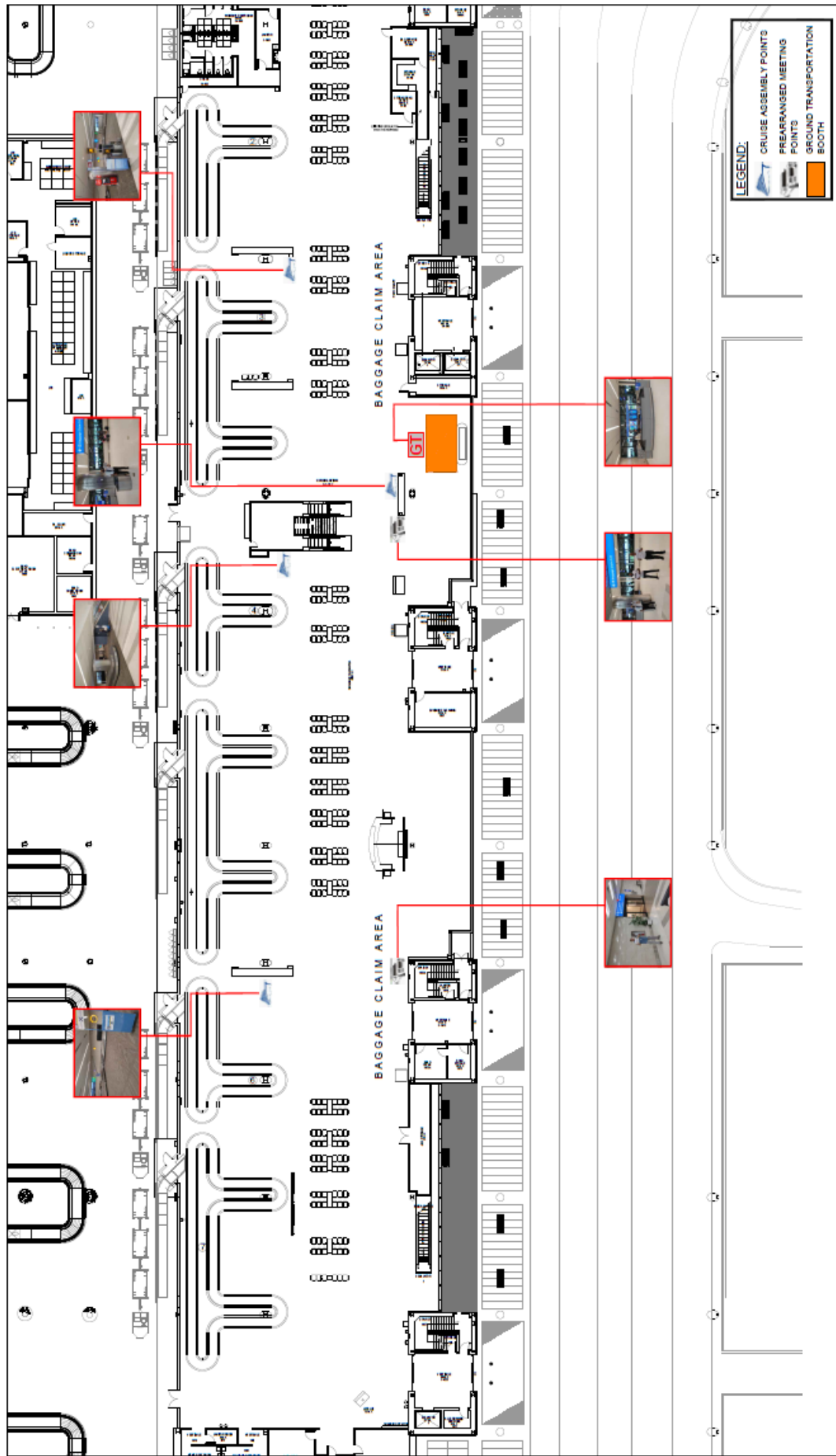

TERMINAL 3 - BAGGAGE CLAIM LEVEL
 CRUISE / PREARRANGED / GROUND TRANSPORTATION

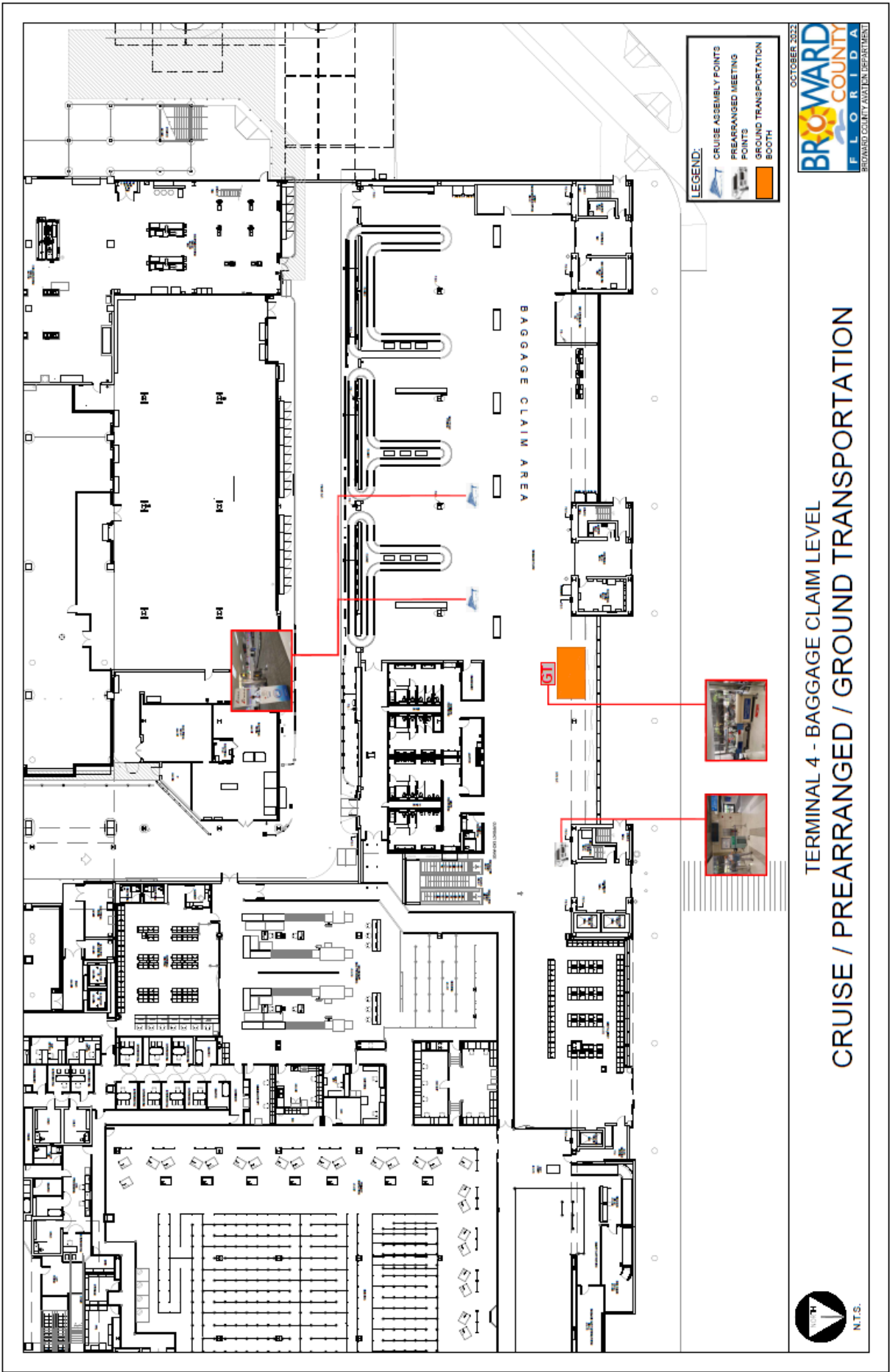

TERMINAL 4 - BAGGAGE CLAIM LEVEL
 CRUISE / PREARRANGED / GROUND TRANSPORTATION



Ground Transportation Staging Area

Buses are prohibited from staging at the Terminals, GTAs or FLL roadways. Buses staging prior to the assembly of the passenger loads must stay in the Staging Lot located at the Northwest quadrant of the Airport Perimeter Road. Buses are to stage only in the designated charter bus area of the lot.

Buses must coordinate (cell phone or radio) with the cruise line "Meet and Greeter" physically located at the Airport Terminals and leave the Staging Lot only when the greeter verifies that all passengers and their baggage are assembled and ready for immediate pick up at the GTAs.

Due to limited space on the lower level GTAs Cruise Buses or Charter Bus Coordinators should also contact SP Curbside Supervisor for clearance to enter the pickup location at the designated lower-level locations at the GTAs.

Ground Transportation Staging Area Map

Motor Coach and Ride Sharing Staging Lot



NW Staging Area Directions

From I-95: Take S.R. 84 East to S.W. 4th Ave, go South (Right Turn) to Perimeter Rd. Make right on Perimeter Rd. & follow roadway to West side of Airport. The Ground Transportation Staging Area will be on the left side near Gate 300 Entrance.

From US1: Take S.R. 84 West to S.W. 4th Ave & follow directions above to Perimeter Rd.

Northwest Staging Lot

1852 W Perimeter Rd, Fort Lauderdale, FL 33315

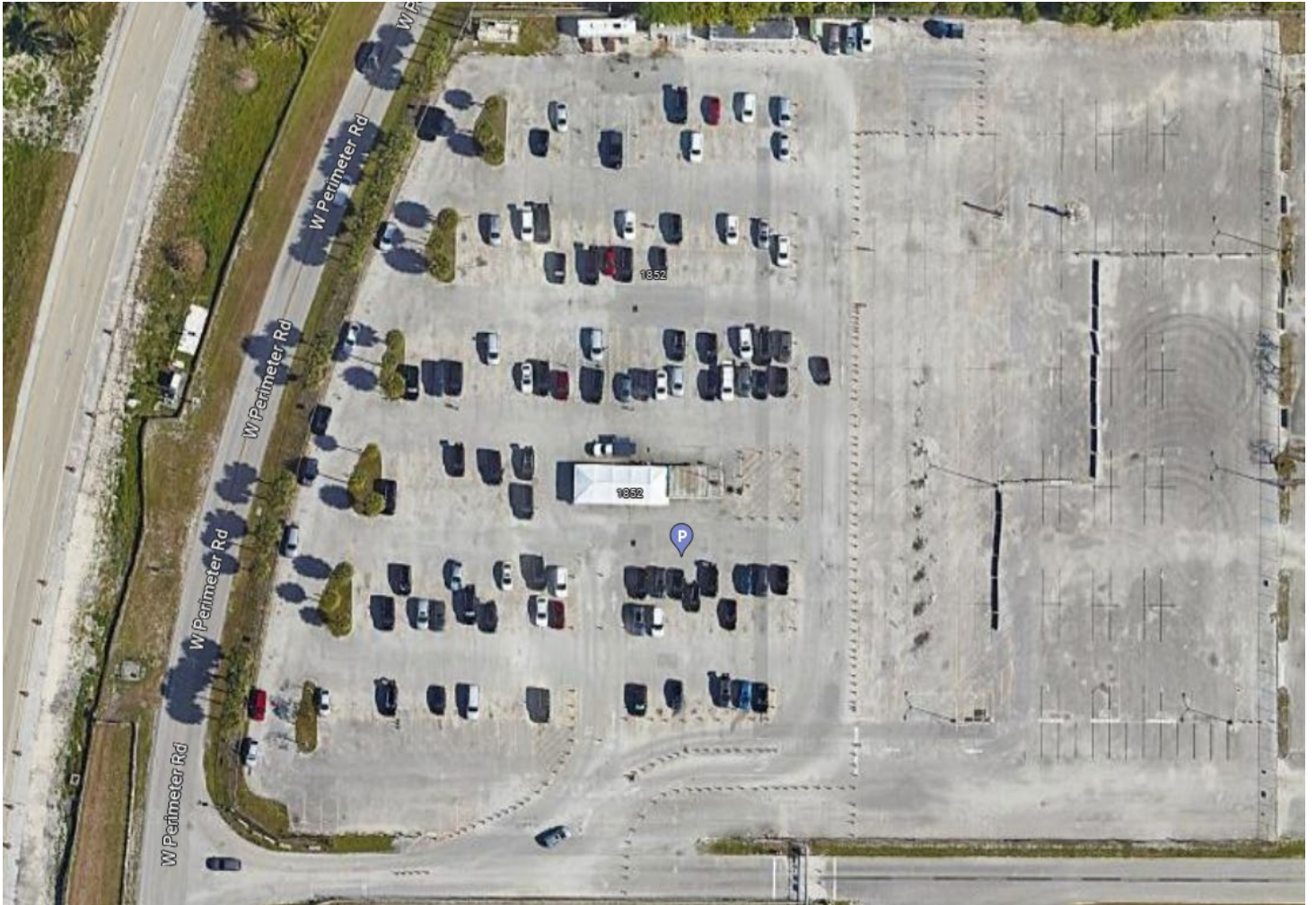

Cruise Procedure Departing to the Seaports (Lower Level)

Do not call buses to GTAs until all passengers and baggage are ready to load.

- The specified assembly areas are designated to not interrupt or interfere with the normal transition of other passengers.
- The following are the primary assembly points:
 - a. Terminal -1- See Page 15
 - b. Terminal -2- See Page 16
 - c. Terminal -3- See Page 17
 - d. Terminal -4- See Page 18
- It is of utmost importance that the "Meet and Greet" personnel ensure that all escalators, doorways, exits, and walkways are not blocked and do not create hazards by piling up baggage or gathering more passengers than an area can accommodate.
- Avoid using Smarte Cartes in the assembly areas.

NOTE:

- All "Meet and Greet" personnel will follow the directions of BSO Officers and BCAD on-site personnel.
- Cruise Line personnel and/or their representatives may not utilize the counters located in the Baggage Claim Areas of the Terminals for business or personal use without a written Agreement with BCAD.

Authorized Passenger Loading

Active Loading is defined as all passengers and baggage in place curbside, being loaded into a vehicle. Absolutely no dwelling is permitted. Unattended vehicles curbside or in any commercial areas are strictly prohibited.

NOTE:

- Broward County Transit (BCT) is located at the Rental Car Center (RCC) Bus way, Zone G
- Buses are not to be at the terminals prior to the full assembly of all passengers and their baggage. All passengers and baggage must be in place before a vehicle is called in. Transportation Dispatchers and/or Cruise Representatives must be on-site to facilitate passenger movement and loading. Baggage should be lined up neatly and out of the way of pedestrian traffic. SP Curbside will monitor and assist in the loading zones to ensure only active loading; no buses will be permitted to dwell.

- Buses will pull into the bus lane curbside in a single file line with enough space between each bus to maneuver into and out of the location easily. This procedure will be monitored by BSO, SP Curbside and BCAD.

Ground Transportation Areas (GTAs)

1. GTA-0 (Lower Level): East of Terminal 1 Staging area for Taxis.
2. GTA-1 (Lower Level): Between Terminal 1 and Terminal 2. Active loading of up to four buses at the outer curb, just west of the Hotel and Off Airport Parking Shuttle Loading Area. Active loading inside the GTA used for a maximum of four (4) buses. Tri Rail located at the west end of Terminal 1.
3. GTA-2 (Lower Level): Between Terminal 2 and Terminal 3. Active loading curbside used for a maximum of two (2) buses or four (4) vans or any combination of buses and vans that will not exceed the allocated space. Tri Rail located at the west end of GTA 2.
4. GTA-3 (Lower Level): Between Terminal 3 and Terminal 4. Active loading curbside used for a maximum of two (2) buses or three (3) vans or any combination of buses and vans that will not exceed the allocated space at any one time.
5. GTA-4 (Lower Level): East of Terminal 4 is for Tri Rail as well as Off Airport Parking and Hotel and Motel Operations.

NOTE: BCAD, SP Curbside, and/or BSO can make adjustments / accommodations to the above mentioned- guidelines as needed.

Ride Share Locations

Ride Share has two (2) pick up locations lower level only:

GTA 1, inside curb, lower level



GTA 3, entire length of the middle of lower level

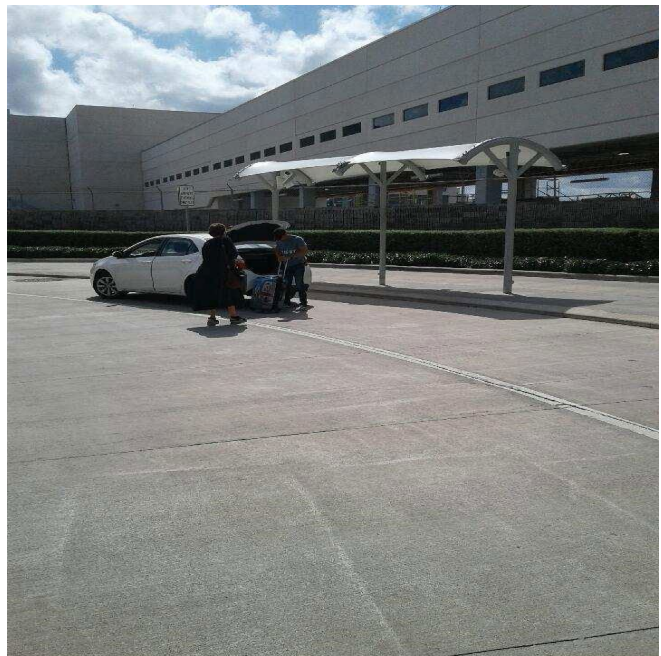

Provisions for All Terminals

1. All bus operators and cruise/chartered tour personnel will follow the directions of the BSO officers, BCAD personnel, and SP Curbside personnel on-site.
2. BSO and BCAD reserve the right to proportionally allocate available loading/unloading space for buses based on the operating configurations (baggage volume and passenger loads) to maximize curb utilization.

Authorized Vehicles

1. All companies and vehicles engaging in transportation must have and display a Ground Transportation Permit. Information regarding Permit/Transponder can be obtained by contacting SP Curbside at (954) 359-5522 or Broward County Consumer Protection Division at (954) 765-1700 during normal business hours (M-F 8:00-4:30), or for additional information visit the Airport website at www.fill.net.
2. No area is "reserved" as exclusive to any bus or cruise company.
3. Vehicles will be required to vacate designated areas when not actively loading or unloading.

Baggage Truck Loading

LANDSIDE DISCRETIONARY PROVISION WITH PRIOR APPROVAL

1. Landside baggage trucking will be at the discretion of SP Curbside, coordinated through BCAD and BSO. Maximum vehicle size will not exceed 20 feet.
2. Prearranged areas for the dedicated baggage vehicles will be assigned for continuous active loading only. Vehicles must be attended by drivers at all times.
3. Current designated locations are as listed below:
 - a. Terminal 1, C-Concourse. Maximum of three (3) baggage trucks at the west-end of Terminal 1, by the utility room.
 - b. Terminal 2, D-Concourse.
 - i. East of Terminal 2, there are two designated spots for baggage trucks.
 - ii. Maximum of two (2) trucks by gate L530. Maximum of two (2) trucks can be loaded west of Terminal-2.
 - c. Terminal 3 South, F-Concourse. There are Two (2) spaces available to the south of gate 520 to load baggage trucks in GTA-3. Gate 520 is for emergency use only and the area must not be blocked. Contact the AOCC at (954)-359-1201.

Ground Transportation Information Booth

The booths are located at the arrival's baggage claim level of each terminal. SP Curbside Customer Service Agents staff the booths and are trained to provide information on all ground transportation options.





MULTI-DAY CRUISE SCHEDULE - 2023/2024 SEASON WITH GUEST CAPACITY						
OCT. 2023		Port Everglades		Port of Miami		
DATE	DAY	# OF SHIPS PEV	SHIP PAX CAPACITY	# OF SHIPS POM	SHIP PAX CAPACITY	TOTAL PAX CAPACITY
1	SUN	2	836	3	18,624	19,460
2	MON	1	540	3	11,852	12,392
	TUE	1	540	1	2,860	3,400
	WED	1	540	1	2,456	2,996
5	THU	1	540	3	11,139	11,679
6	FRI	1	540	1	3,730	4,270
7	SAT	3	5,812	5	26,201	32,013
8	SUN	2	3,426	2	8,122	11,548
9	MON	1	540	5	8,122	8,662
	TUE	3	5,374	0	-	5,374
	WED	2	1,470	0	-	1,470
12	THU	1	540	2	7,311	7,851
13	FRI	1	540	3	10,418	10,958
14	SAT	3	7,266	3	7,990	15,256
15	SUN	1	540	3	18,625	19,165
16	MON	1	540	3	11,852	12,392
	TUE	1	540	1	5,145	5,685
	WED	1	540	1	2,860	3,400
19	THU	1	540	0	-	540
20	FRI	1	540	3	11,139	11,679
21	SAT	3	6,296	1	3,730	10,026
22	SUN	3	6,094	6	28,901	34,995
23	MON	1	540	3	10,712	11,252
	TUE	3	5,030	0	-	5,030
	WED	1	540	1	2,405	2,945
26	THU	1	540	3	6,728	7,268
27	FRI	1	540	4	13,855	14,395
28	SAT	5	11,286	2	9,336	20,622
29	SUN	1	540	3	18,625	19,165
	MON	2	3,458	4	13,266	16,724
	TUE	3	7,480	1	2,873	10,353
GRAND TOTAL		53	74,088	71	278,877	352,965

DEV = Port Everglades

DOM = Port of Miami

*Port of Miami showing ship capacity taken from <https://cruisedig.com/ports/miami-florida/arrivals>



MULTI-DAY CRUISE SCHEDULE - 2023/2024 SEASON WITH GUEST CAPACITY						
NOV. 2023		Port Everglades		Port of Miami		
DATE	DAY	# OF SHIPS	SHIP PAX	# OF SHIPS	SHIP PAX	TOTAL PAX
		PEV	CAPACITY	POM	CAPACITY	CAPACITY
1	WED	1	540	1	2,860	3,400
2	THU	3	6,312	3	8,310	14,622
3	FRI	2	3,208	4	10,135	13,343
4	SAT	3	6,296	6	23,938	30,234
5	SUN	3	6,568	5	20,477	27,045
6	MON	5	11,568	5	15,812	27,380
7	TUE	1	540	1	540	1,080
8	WED	3	3,904	4	15,284	19,188
9	THU	2	4,380	1	2,590	6,970
	FRI	2	4,338	3	10,982	15,320
11	SAT	4	9,522	5	23,507	33,029
12	SUN	5	14,754	5	20,705	35,459
13	MON	4	8,528	5	14,988	23,516
14	TUE	1	540	1	2,393	2,933
15	WED	3	5,596	4	12,376	17,972
16	THU	2	3,426	0	-	3,426
17	FRI	2	4,338	5	11,832	16,170
18	SAT	5	12,996	6	24,105	37,101
19	SUN	5	14,048	8	34,517	48,565
20	MON	7	16,456	2	7,558	24,014
21	TUE	3	6,686	1	540	7,226
22	WED	3	7,060	1	5,836	12,896
23	THU	1	540	2	6,320	6,860
24	FRI	3	7,506	5	16,392	23,898
	SAT	8	21,692	6	20,446	42,138
26	SUN	5	14,458	6	29,448	43,906
27	MON	3	7,256	7	21,020	28,276
28	TUE	1	540	2	3,676	4,216
29	WED	5	8,290	1	2,860	11,150
30	THU	7	13,528	1	4,356	17,884
GRAND TOTAL		102	225,414	106	373,803	599,217
		PEV = Port Everglades		POM = Port of Miami		
*Port of Miami showing ship capacity taken from https://cruisedig.com/ports/miami-florida/arrivals						



MULTI-DAY CRUISE SCHEDULE - 2023/2024 SEASON WITH GUEST CAPACITY						
DEC. 2023		Port Everglades		Port of Miami		
DATE	DAY	# OF SHIPS PEV	SHIP PAX CAPACITY	# OF SHIPS POM	SHIP PAX CAPACITY	TOTAL PAX CAPACITY
1	FRI	5	10,858	7	19,222	30,080
2	SAT	5	14,552	7	21,518	36,070
3	SUN	6	16,676	6	26,827	43,503
4	MON	4	9,724	6	21,227	30,951
5	TUE	1	540	2	3,120	3,660
6	WED	1	540	2	6,343	6,883
7	THU	1	540	2	6,320	6,860
8	FRI	3	7,998	5	17,937	25,935
9	SAT	8	21,880	4	17,822	39,702
10	SUN	6	18,210	6	27,672	45,882
11	MON	4	8,194	8	22,264	30,458
12	TUE	2	1,242	1	779	2,021
13	WED	2	838	3	8,283	9,121
14	THU	3	5,926	2	8,558	14,484
	FRI	3	7,006	4	15,077	22,083
16	SAT	5	14,552	6	23,745	38,297
17	SUN	7	19,592	8	32,778	52,370
18	MON	5	13,384	7	20,768	34,152
19	TUE	3	4,858	1	540	5,398
20	WED	5	6,956	0	-	6,956
21	THU	2	2,754	3	8,725	11,479
22	FRI	7	15,770	7	21,170	36,940
23	SAT	9	22,622	5	23,683	46,305
24	SUN	4	12,204	3	15,782	27,986
25	MON	1	1,040	4	12,774	13,814
26	TUE	2	4,338	2	5,253	9,591
27	WED	6	9,138	3	13,099	22,237
28	THU	3	6,700	6	20,775	27,475
29	FRI	5	12,778	4	10,274	23,052
30	SAT	7	20,778	7	25,305	46,083
31	SUN	3	7,980	5	25,643	33,623
GRAND TOTAL		128	300,168	136	483,283	783,451
		PEV = Port Everglades		POM = Port of Miami		

*Port of Miami showing ship capacity taken from <https://cruisedig.com/ports/miami-florida/arrivals>



MULTI-DAY CRUISE SCHEDULE - 2023/2024 SEASON WITH GUEST CAPACITY						
JAN. 2024		Port Everglades		Port of Miami		
DATE	DAY	# OF SHIPS PEV	SHIP PAX CAPACITY	# OF SHIPS POM	SHIP PAX CAPACITY	TOTAL PAX CAPACITY
1	MON	1	540	4	10,670	11,210
2	TUE	5	12,984	1	803	13,787
3	WED	4	7,446	4	11,062	18,508
4	THU	4	4,914	4	11,062	15,976
	FRI	5	8,304	7	18,664	26,968
	SAT	6	16,100	5	18,588	34,688
7	SUN	7	21,286	8	38,135	59,421
8	MON	4	10,484	5	17,459	27,943
9	TUE	2	3,624	1	1,200	4,824
10	WED	1	540	2	8,696	9,236
11	THU	2	3,426	2	7,229	10,655
	FRI	3	6,838	4	15,077	21,915
	SAT	6	16,656	6	22,358	39,014
14	SUN	7	19,342	7	31,975	51,317
15	MON	3	7,224	4	15,495	22,719
16	TUE	2	2,634	1	2,873	5,507
17	WED	3	6,700	1	5,145	11,845
18	THU	2	3,426	3	7,574	11,000
	FRI	5	12,086	6	16,399	28,485
	SAT	7	19,018	4	17,207	36,225
21	SUN	6	17,626	6	29,030	46,656
22	MON	4	9,511	5	17,742	27,253
23	TUE	1	540	1	5,386	5,926
24	WED	2	2,644	2	5,253	7,897
25	THU	2	3,426	5	14,824	18,250
	FRI	4	9,506	6	20,355	29,861
	SAT	7	21,098	5	21,798	42,896
28	SUN	6	16,674	7	34,823	51,497
29	MON	5	13,568	3	11,914	25,482
30	TUE	1	540	2	8,259	8,799
31	WED	2	3,040	2	2,400	5,440
GRAND TOTAL		119	281,745	123	449,455	731,200

PEV = Port Everglades

POM = Port of Miami

3

*Port of Miami showing ship capacity taken from <https://cruisedig.com/ports/miami-florida/arrivals>



MULTI-DAY CRUISE SCHEDULE - 2023/2024 SEASON WITH GUEST CAPACITY						
FEB. 2024		Port Everglades		Port of Miami		
DATE	DAY	# OF SHIPS	SHIP PAX	# OF SHIPS	SHIP PAX	TOTAL PAX
		PEV	CAPACITY	POM	CAPACITY	CAPACITY
1	THU	1	540	3	10,522	11,062
2	FRI	2	4,338	4	14,959	19,297
3	SAT	8	21,122	4	22,549	43,671
4	SUN	6	20,294	8	32,706	53,000
5	MON	5	13,338	6	22,171	35,509
6	TUE	2	4,200	0	-	4,200
7	WED	1	540	1	2,860	3,400
8	THU	3	6,510	2	6,946	13,456
9	FRI	4	10,098	4	12,325	22,423
10	SAT	5	14,552	5	23,638	38,190
11	SUN	6	16,674	7	30,161	46,835
12	MON	3	7,224	3	11,914	19,138
13	TUE	1	540	2	7,218	7,758
14	WED	3	5,114	1	2,590	7,704
15	THU	2	3,426	7	19,148	22,574
16	FRI	5	11,262	4	22,549	33,811
17	SAT	8	19,614	8	31,430	51,044
18	SUN	7	20,710	7	21,218	41,928
19	MON	3	7,598	7	20,948	28,546
20	TUE	1	540	0	-	540
21	WED	2	3,632	1	2,860	6,492
22	THU	2	3,426	3	13,383	16,809
23	FRI	4	10,443	5	17,950	28,393
24	SAT	7	19,542	5	25,385	44,927
25	SUN	7	19,342	7	31,975	51,317
26	MON	5	13,770	6	24,996	38,766
27	TUE	1	540	1	5,145	5,685
28	WED	3	6,124	1	1,200	7,324
29	THU	1	540	1	2,590	3,130
GRAND TOTAL		108	265,593	113	441,336	706,929
		DEV = Port Everglades		DOM = Port of Miami		

*Port of Miami showing ship capacity taken from <https://cruisedig.com/ports/miami-florida/arrivals>



MULTI-DAY CRUISE SCHEDULE - 2023/2024 SEASON WITH GUEST CAPACITY						
MARCH, 2024		Port Everglades		Port of Miami		
DATE	DAY	# OF SHIPS PEV	SHIP PAX CAPACITY	# OF SHIPS POM	SHIP PAX CAPACITY	TOTAL PAX CAPACITY
1	FRI	3	8,098	7	23,947	32,045
2	SAT	7	19,518	5	27,169	46,687
3	SUN	6	18,126	7	33,232	51,358
4	MON	3	7,724	4	13,729	21,453
5	TUE	1	1,040	1	3,727	4,767
6	WED	3	6,236	2	5,253	11,489
7	THU	3	7,586	2	5,159	12,745
8	FRI	4	10,006	7	21,746	31,752
9	SAT	6	18,136	9	34,105	52,241
10	SUN	6	17,174	6	29,582	46,756
11	MON	4	10,984	4	15,495	26,479
12	TUE	1	1,040	1	2,873	3,913
13	WED	2	3,540	1	2,873	6,413
14	THU	2	3,926	2	6,320	10,246
	FRI	3	5,566	2	7,401	12,967
16	SAT	7	16,476	2	5,598	22,074
17	SUN	8	24,436	7	29,569	54,005
18	MON	3	5,768	6	29,030	34,798
19	TUE	1	1,040	6	20,135	21,175
20	WED	1	1,040	1	2,860	3,900
21	THU	2	1,926	4	14,021	15,947
22	FRI	4	10,598	5	17,950	28,548
23	SAT	6	17,362	6	29,115	46,477
24	SUN	6	17,174	8	32,515	49,689
25	MON	3	7,724	5	18,368	26,092
26	TUE	1	1,040	1	2,873	3,913
27	WED	4	9,304	3	2,315	11,619
28	THU	4	10,038	2	6,320	16,358
29	FRI	6	15,490	5	17,059	32,549
30	SAT	6	18,126	6	30,229	48,355
31	SUN	4	10,984	8	34,061	45,045
GRAND TOTAL		120	307,226	135	524,629	831,855

DEV = Port Everglades

DOM = Port of Miami

*Port of Miami showing ship capacity taken from <https://cruisedig.com/ports/miami-florida/arrivals>



MULTI-DAY CRUISE SCHEDULE - 2023/2024 SEASON WITH GUEST CAPACITY						
APRIL 2024		Port Everglades		Port of Miami		
DATE	DAY	# OF SHIPS	SHIP PAX	# OF SHIPS	SHIP PAX	TOTAL PAX
		PEV	CAPACITY	POM	CAPACITY	CAPACITY
1	MON	4	10,484	5	17,459	27,943
2	TUE	2	1,470	0	-	1,470
3	WED	1	540	1	2,860	3,400
4	THU	2	3,426	1	4,356	7,782
	FRI	6	14,576	6	19,397	33,973
6	SAT	6	16,656	7	31,705	48,361
7	SUN	7	19,324	6	29,582	48,906
8	MON	4	9,724	4	15,495	25,219
9	TUE	1	540	0	-	540
10	WED	2	918	1	2,873	3,791
11	THU	2	3,426	2	6,320	9,746
12	FRI	4	10,098	4	13,999	24,097
13	SAT	7	18,938	4	22,549	41,487
14	SUN	4	12,460	6	24,765	37,225
15	MON	3	6,838	5	17,459	24,297
16	TUE	2	1,268	1	3,590	4,858
17	WED	1	540	1	2,860	3,400
18	THU	2	3,426	3	11,431	14,857
19	FRI	3	6,838	4	15,077	21,915
20	SAT	7	20,868	5	24,495	45,363
21	SUN	4	9,038	6	29,498	38,536
22	MON	5	12,984	5	18,085	31,069
23	TUE	1	540	0	-	540
24	WED	1	540	0	-	540
	THU	2	2,754	2	3,730	6,484
26	FRI	5	10,559	4	13,999	24,558
27	SAT	5	13,520	4	22,549	36,069
28	SUN	2	6,058	4	19,523	25,581
29	MON	2	3,426	3	11,852	15,278
30	TUE	1	3,632	0	-	3,632
GRAND TOTAL		98	225,409	94	385,508	610,917

PEV = Port Everglades

POM = Port of Miami

*Port of Miami showing ship capacity taken from <https://cruisedig.com/ports/miami-florida/arrivals>



MULTI-DAY CRUISE SCHEDULE - 2023/2024 SEASON WITH GUEST CAPACITY						
MAY. 2024		Port Everglades		Port of Miami		
DATE	DAY	# OF SHIPS PEV	SHIP PAX CAPACITY	# OF SHIPS POM	SHIP PAX CAPACITY	TOTAL PAX CAPACITY
1	WED	3	6,838	1	2,860	9,698
2	THU	2	3,458	1	2,405	5,863
3	FRI	2	3,426	3	11,139	14,565
4	SAT	4	12,860	5	25,991	38,851
5	SUN	3	6,300	5	21,138	27,438
6	MON	2	3,426	3	11,139	14,565
7	TUE	1	540	1	5,386	5,926
8	WED	1	540	0	-	540
9	THU	2	2,290	2	8,086	10,376
10	FRI	4	12,036	4	13,999	26,035
11	SAT	3	6,116	3	18,193	24,309
12	SUN	2	3,800	3	15,585	19,385
13	MON	4	10,694	5	16,724	27,418
14	TUE	1	540	1	2,405	2,945
	WED	1	540	1	2,860	3,400
16	THU	3	5,176	0	-	5,176
17	FRI	3	7,460	4	11,918	19,378
18	SAT	1	540	5	27,901	28,441
19	SUN	4	8,268	4	16,823	25,091
20	MON	1	540	3	11,139	11,679
21	TUE	1	540	0	-	540
22	WED	1	540	0	-	540
23	THU	4	7,390	3	10,491	17,881
24	FRI	2	4,200	3	10,982	15,182
25	SAT	2	3,800	3	18,193	21,993
26	SUN	3	5,176	3	15,585	20,761
27	MON	1	540	5	19,225	19,765
28	TUE	1	540	1	2,405	2,945
29	WED	2	3,632	1	2,860	6,492
	THU	2	3,426	0	-	3,426
31	FRI			3	11,139	11,139
GRAND TOTAL		66	125,172	75	316,571	441,743

PEV = Port Everglades

POM = Port of Miami

*Port of Miami showing ship capacity taken from <https://cruisedig.com/ports/miami-florida/arrivals>



MULTI-DAY CRUISE SCHEDULE - 2023/2024 SEASON WITH GUEST CAPACITY						
JUNE. 2024		Port Everglades		Port of Miami		
DATE	DAY	# OF SHIPS	SHIP PAX	# OF SHIPS	SHIP PAX	TOTAL PAX
		PEV	CAPACITY	POM	CAPACITY	CAPACITY
1	SAT	4	9,210	5	25,991	35,201
2	SUN	1	540	4	18,733	19,273
3	MON	2	3,426	3	11,139	14,565
4	TUE	1	540	0	-	540
5	WED	1	540	0	-	540
	THU	2	2,290	3	10,491	12,781
	FRI	2	3,426	4	13,999	17,425
8	SAT	2	4,200	5	20,701	24,901
9	SUN	4	8,642	3	15,585	24,227
10	MON	2	3,426	4	16,208	19,634
11	TUE	1	540	0	-	540
12	WED	1	540	1	2,860	3,400
	THU	1	540	0	-	540
	FRI	3	5,176	3	11,139	16,315
15	SAT	3	7,460	7	33,323	40,783
16	SUN	1	540	4	16,823	17,363
17	MON	2	3,426	3	11,139	14,565
18	TUE	1	540	0	-	540
19	WED	3	5,382	0	-	5,382
	THU	1	540	2	8,086	8,626
	FRI	2	3,426	3	10,982	14,408
22	SAT	3	5,950	3	18,193	24,143
23	SUN	2	3,800	3	15,585	19,385
24	MON	2	3,426	6	21,630	25,056
25	TUE	1	540	0	-	540
26	WED	1	540	1	2,860	3,400
	THU	2	2,290	0	-	2,290
	FRI	2	3,426	3	11,139	14,565
29	SAT	3	7,460	5	25,991	33,451
30	SUN	1	540	4	18,733	19,273
GRAND TOTAL		57	92,322	79	341,330	433,652
		PEV = Port Everglades		POM = Port of Miami		

*Port of Miami showing ship capacity taken from <https://cruisedig.com/ports/miami-florida/arrivals>



MULTI-DAY CRUISE SCHEDULE - 2023/2024 SEASON WITH GUEST CAPACITY						
JULY, 2024		Port Everglades		Port of Miami		
DATE	DAY	# OF SHIPS PEV	SHIP PAX CAPACITY	# OF SHIPS POM	SHIP PAX CAPACITY	TOTAL PAX CAPACITY
1	MON	3	5,176	2	8,122	13,298
2	TUE	1	540	1	2,405	2,945
	WED	1	540	2	8,086	
	THU	1	540	4	13,999	
5	FRI	2	3,426	3	18,193	21,619
6	SAT	3	5,950	4	17,990	23,940
7	SUN	2	3,800	5	19,225	23,025
8	MON	2	3,426	1	2,860	6,286
9	TUE	1	540	0	-	540
	WED	1	540	1	2,860	
	THU	2	2,290	0	-	
12	FRI	1	540	3	11,139	11,679
13	SAT	4	10,346	5	27,901	38,247
14	SUN	1	540	4	16,823	17,363
15	MON	3	6,072	2	8,122	14,194
16	TUE	1	540	1	2,405	2,945
	WED	1	540	0	-	
	THU	1	540	2	8,086	
19	FRI	1	540	3	9,458	9,998
20	SAT	3	5,950	4	21,210	27,160
21	SUN	5	10,468	3	15,585	26,053
22	MON	1	540	4	14,684	15,224
23	TUE	1	540	0	-	540
	WED	1	540	1	2,860	
	THU	2	2,290	1	2,405	
26	FRI	2	3,426	2	6,598	10,024
27	SAT	3	7,460	5	25,991	33,451
28	SUN	2	4,322	4	18,733	23,055
29	MON	3	5,176	3	9,003	14,179
30	TUE	1	540	0	-	540
	WED	1	540	0	-	
GRAND TOTAL		57	88,218	70	294,743	382,961
		PEV = Port Everglades		POM = Port of Miami		

*Port of Miami showing ship capacity taken from <https://cruisedig.com/ports/miami-florida/arrivals>



MULTI-DAY CRUISE SCHEDULE - 2023/2024 SEASON WITH GUEST CAPACITY						
AUG. 2024		Port Everglades		Port of Miami		
DATE	DAY	# OF SHIPS PEV	SHIP PAX CAPACITY	# OF SHIPS POM	SHIP PAX CAPACITY	TOTAL PAX CAPACITY
1	THU	1	540	2	8,086	8,626
2	FRI	2	3,426	5	18,177	21,603
3	SAT	3	5,950	4	20,598	26,548
4	SUN	3	7,582	4	18,602	26,184
5	MON	2	3,426	4	14,072	17,498
6	TUE	1	540	0	-	540
7	WED	1	540	1	2,860	3,400
8	THU	2	2,290	4	15,317	17,607
9	FRI	2	3,426	5	27,901	31,327
10	SAT	3	7,460	4	16,823	24,283
11	SUN	2	4,322	4	16,823	21,145
12	MON	3	5,176	3	9,003	14,179
13	TUE	1	540	0	-	540
14	WED	1	540	1	5,836	6,376
	THU	1	540	2	8,086	8,626
16	FRI	2	3,426	4	14,603	18,029
17	SAT	2	2,290	3	18,193	20,483
18	SUN	3	7,582	3	15,585	23,167
19	MON	2	3,426	3	11,667	15,093
20	TUE	1	540	0	-	540
21	WED	1	540	2	5,265	5,805
22	THU	2	2,290	0	-	2,290
23	FRI	2	3,426	2	6,598	10,024
24	SAT	2	3,800	5	25,991	29,791
25	SUN	2	4,322	3	13,914	18,236
26	MON	3	5,176	2	6,598	11,774
27	TUE	1	540	0	-	540
28	WED	1	540	0	-	540
29	THU	1	540	2	8,086	8,626
	FRI	3	5,176	4	11,863	17,039
31	SAT	1	540	3	18,193	18,733
GRAND TOTAL		57	90,452	79	338,740	429,192

PEV = Port Everglades POM = Port of Miami

*Port of Miami showing ship capacity taken from <https://cruisedig.com/ports/miami-florida/arrivals>



MULTI-DAY CRUISE SCHEDULE - 2023/2024 SEASON WITH GUEST CAPACITY						
SEP. 2024		Port Everglades		Port of Miami		
DATE	DAY	# OF SHIPS	SHIP PAX	# OF SHIPS	SHIP PAX	TOTAL PAX
		PEV	CAPACITY	POM	CAPACITY	CAPACITY
	SUN	3	7,582	5	16,455	24,037
2	MON	3	5,176	3	13,200	18,376
3	TUE	1	540	2	12,215	12,755
4	WED	1	540	4	14,308	14,848
5	THU	1	540	0	-	540
6	FRI	3	5,176	1	2,860	8,036
	SAT	2	3,800	0	-	3,800
	SUN	2	4,322	4	13,595	17,917
9	MON	4	5,916	3	16,478	22,394
10	TUE	1	540	3	13,453	13,993
11	WED	1	540	3	10,578	11,118
12	THU	1	540	0	-	540
13	FRI	3	5,176	1	5,836	11,012
	SAT	1	540	1	3,730	4,270
	SUN	3	7,582	5	16,455	24,037
16	MON	3	5,176	3	13,200	18,376
17	TUE	1	540	2	12,215	12,755
18	WED	1	540	4	14,308	14,848
19	THU	1	540	0	-	540
20	FRI	3	5,176	1	2,860	8,036
	SAT	2	3,800	0	-	3,800
	SUN	2	4,322	4	13,595	17,917
23	MON	3	5,176	2	10,140	15,316
24	TUE	1	540	4	19,791	20,331
25	WED	1	540	3	10,578	11,118
26	THU	1	540	0	-	540
27	FRI	4	5,916	0	-	5,916
	SAT	1	540	2	8,271	8,811
	SUN	3	7,582	3	9,458	17,040
30	MON	3	5,176	3	9,246	14,422
GRAND TOTAL		46	53,740	70	277,449	330,825

PEV = Port Everglades

POM = Port of Miami

*Port of Miami showing ship capacity taken from <https://cruisedig.com/ports/miami-florida/arrivals>