

## TERMINAL ONE T1

**A** *Centro de Formação*  
SARAH MORRIS  
Ceramic Tile, 2017 [Concourse A](#)

**B** *Chasing Armadillos*  
SUSAN HARLAN  
Tapestry, 1989 [Baggage Claim](#)

**C** *Cloudscape*  
VOLKAN ALKANOGLU  
Sculptural Play Area, 2017 [Concourse A](#)

**D** *Idea Horizon*  
LIAM GILLICK  
Glass Curtain Wall Design, 2003 [Exterior Glass Wall](#)

**E** *Gateway to the South*  
ELIZABETH A. BUSCH  
Tapestry, 1990 [Baggage Claim](#)

**F** *River of Grass*  
CAROLYN BRAAKSMA  
Terrazzo Floor Design, 2003 [East Mezzanine](#)

**G** *Stone and Glass Gardens*  
ALICE ADAMS  
Sculptural Environment, 2003 [Ticketing and Baggage Claim](#)

**H** *Sunrise to Sunset*  
GORDON HUETHER  
Art Glass, 2017 [International Arrivals, Meet and Greet Area](#)

**I** *Vendor with Walkman*  
DUANE HANSON  
Bronze with Accessories, 1990 [Baggage Claim](#)

**J** *Wavescape*  
PAUL DEMARINIS  
Sound Art, 2003 [Pedestrian Bridge to Hibiscus Garage](#)

**K** *Wavelength*  
EMILY WHITE  
Painted Aluminum, 2017 [Concourse A](#)

## TERMINAL TWO T2

**L** *Lay of the Land*  
PAM BEYETTE  
Mosaic Tile & Terrazzo Floor Designs, 2010  
[Entry Vestibules, Exterior](#)

*Musical Warning Beacons / Talking Vestibules*  
JIM GREEN  
Sound Art, 2003 [Entry Vestibules, Baggage Claim](#)

**M** *Florida Envelope Series*  
MILES BATT  
Acrylic Painting (series), 1991 [Departures Level \(Coming Soon\)](#)

**N** *SkyWaves*  
LAURIE LUNDQUIST  
Bridge Design, 2017 [Pedestrian Bridge to Palm Garage](#)

*En Plane Air*  
Youth Art Exhibition [Departures Level](#)

## RENTAL CAR CENTER R

**O** *Luminous Portals*  
JAMES CARPENTER  
LED Light Portals, 2005 [Entry Vestibules](#)

**P** *Mangrove Islands*  
THOMAS H. SAYRE  
Terrazzo Floor Design, 2005 [Levels 2, 3 and 4](#)

## HIBISCUS GARAGE H

**Q** *Light Cylinders*  
JODY PINTO  
Fiberglass, 2001 [Escalator Enclosures](#)

## NORTH RUNWAY

**R** *In Flight*  
PETER AGARDY  
Painted Mural, 2019 [Runway Jetblast Deflector](#)

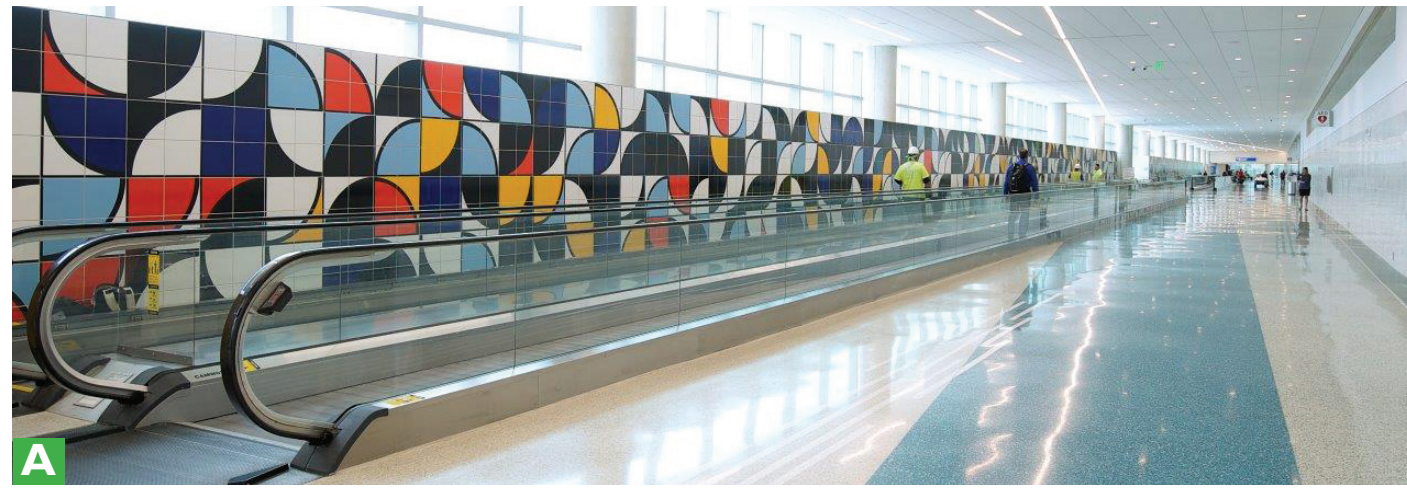

**A**



**B**



**C**



**D**



**F**



**E**



**G**

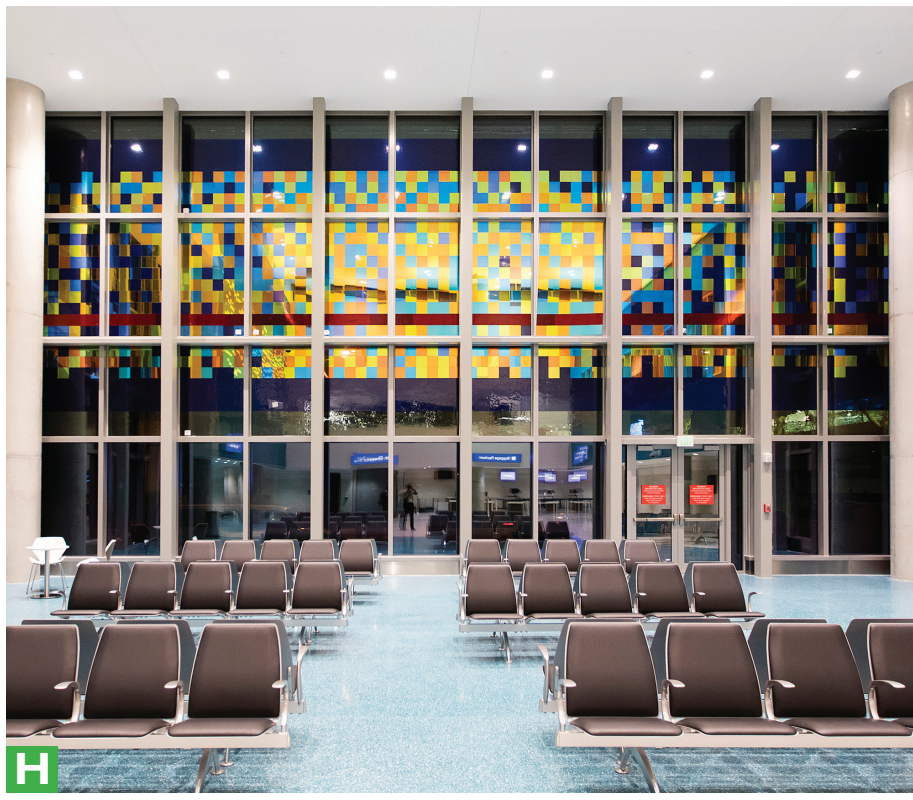

**H**



**I**



**K**



**J**



**L**



**O**



**Q**

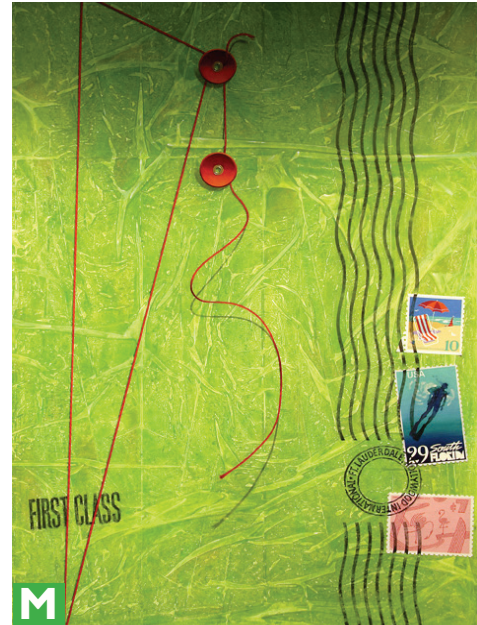

**M**



**N**



**P**



**R**



**BROWARD COUNTY PUBLIC ART & DESIGN**

**FORT LAUDERDALE - HOLLYWOOD INTERNATIONAL AIRPORT'S PUBLIC ART**

Public art by local, national and internationally acclaimed artists is on display throughout Broward County's Fort Lauderdale-Hollywood International Airport (FLL), which has participated in Broward County's Public Art & Design Program since the adoption of the Public Art Ordinance in 1976.

Inside FLL's terminals are paintings, sculptures, quilts, mosaic and terrazzo floors, sound art, photography and an art exhibition program showcasing artworks by Broward-based youth and airport employees. Three of these artworks were recognized by the Americans for the Arts Public Art Network's Year in Review that highlights the best examples of public art in the country.

The collection's captivating artworks creatively reflect the spirit and energy of South Florida and its commitment to the cultural arts.

Whether you are in Broward County for business or pleasure, we hope that you will discover and enjoy FLL's public art collection with the help of this brochure and let it serve as your guided tour!

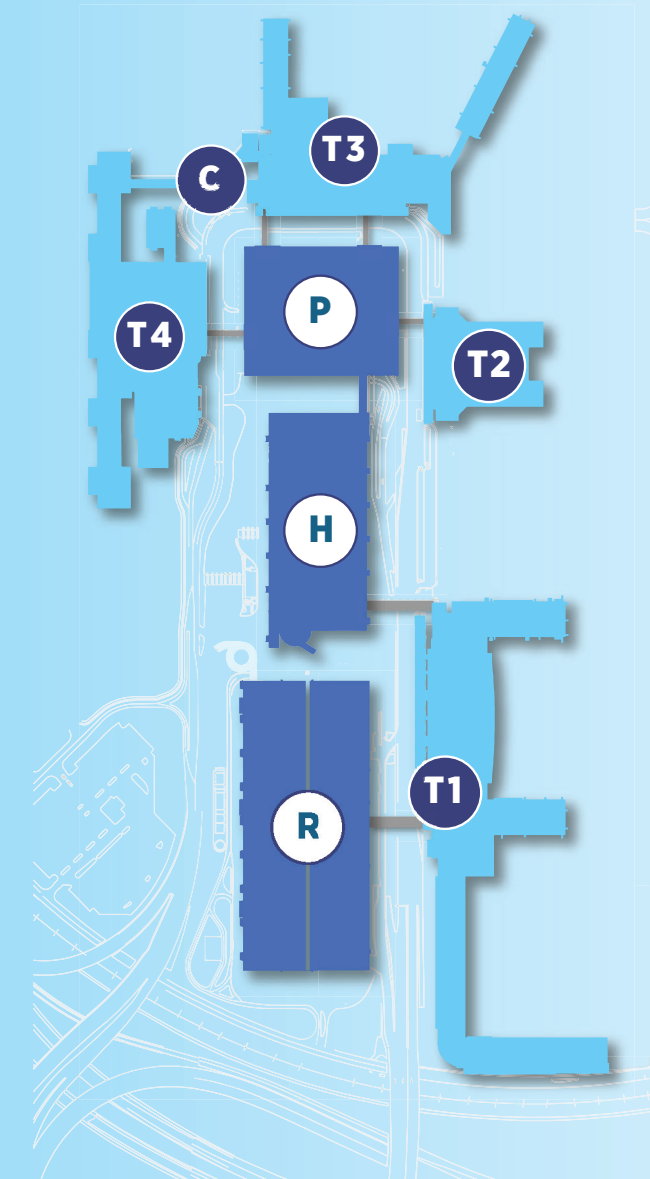

**TERMINAL THREE T3**

**A Lay of the Land**  
PAM BEYETTE  
Mosaic Tile & Terrazzo Floor Design, 2010 ☺ Entry Vestibules, Exterior

**Musical Warning Beacons/Talking Vestibules**  
JIM GREEN  
Sound Art, 2003 ☺ Entry Vestibules, Baggage Claim

**B Please Lose my Suitcase Full of Blues**  
CORK MARCHESCHI  
Neon Sculpture, 1994 ☺ Baggage Claim

**C Rainbow's End**  
DAVID GRIGGS & SCOTT PARSONS  
Terrazzo Floor Design, 2016 ☺ Departures Level

**D SkyWaves**  
LAURIE LUNDQUIST  
Bridge Design, 2017 ☺ Pedestrian Bridge to Palm Garage

**TERMINAL FOUR T4**

**E Florida Current**  
KEITH SONNIER  
Neon and Metal Sculpture, 2001 ☺ Baggage Claim

**A Lay of the Land**  
PAM BEYETTE  
Mosaic Tile & Terrazzo Floor Design, 2010 ☺ Entry Vestibules, Exterior

**Musical Warning Beacons/Talking Vestibules**  
JIM GREEN  
Sound Art, 2003 ☺ Entry Vestibules, Baggage Claim

**F The Importance of Being a Bubble**  
WILLIAM CRUTCHFIELD  
Painted Wall Relief, 1989 ☺ Ticketing

**G The Seasons**  
NORMAN LALIBERTE  
Tapestry, 1990 ☺ Ticketing

**D SkyWaves**  
LAURIE LUNDQUIST  
Bridge Design, 2017 ☺ Pedestrian Bridge to Palm Garage

**GREENBELT**

**H Fort Lauderdale Airport Sculpture**  
DAVID LEE BROWN  
Stainless Steel Sculpture, 1989 ☺ Entrance to Greenbelt Park

**TERMINALS 3/4 CONNECTOR C**

**I Gateways**  
ROBERT HUFF  
Acrylic, Pencil and Oil Painting, 1991

**Conservation Area #2-1**  
CLYDE BUTCHER  
Black/White Photography, 2005

**North Fork New River**  
CLYDE BUTCHER  
Black/White Photography, 2005

**J Shell Key 2**  
CLYDE BUTCHER  
Black/White Photography, 2005

**K I Bet You Didn't Know**  
Employee Art Exhibition

**Airfield Studies: Horizon, Material**  
DAWN ROE  
HD Video Kiosk, 2015

**L Airfield Studies: Movement I, Movement II**  
DAWN ROE  
HD Video Kiosk, 2015

**M Atlantic Swell**  
BRAD GOLDBERG  
Terrazzo Floor Design, 2019

**N Mosaic**  
CAMERON MCNALL / ELECTROLAND  
LED Installation, 2020

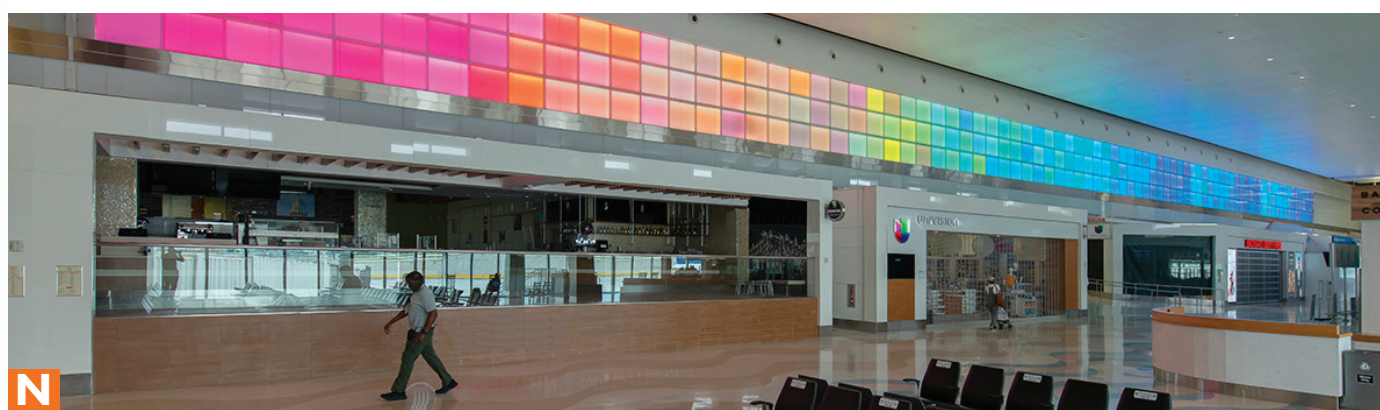
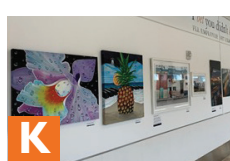
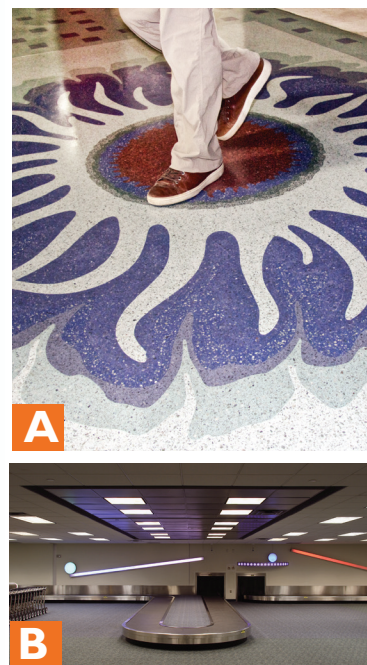

An equal opportunity employer and provider of services. \$422.50 or \$065.00 per copy, to promote the 500 copies of this public document were promulgated at a cost of Broward County Cultural Division Public Art and Design Program.

@BrowardArts



954-557-7457

Broward.org/Arts



Broward.org/Arts/PublicArt

For more information about public art at the Airport and throughout Broward County, visit Broward.org/PublicArt.

Broward County Aviation Department.

Art & Design Program, in partnership with the Broward County Cultural Division through its Public

FLL's public art collection is managed by the

public art of any Broward County agency.

artworks, FLL has the highest concentration of

Broward County taxpayer dollars. With over 60

funded by service and passenger fees, not by

its operation, capital projects, and public art are

FLL operates as an enterprise fund, meaning that

MAP & GUIDE

PUBLIC ART at FLL

