



# **Floodplain Management Plan 2016 Annual Progress Report**

**Broward County Municipal Services District (Unincorporated)  
NFIP Community Number 125093**

**August 2016**

## **Introduction**

Broward Municipal Services District (unincorporated Broward County) participates in the Federal Emergency Management Agency (FEMA) Community Rating System (CRS) program. CRS is a voluntary incentive program that recognizes and encourages community floodplain management activities that exceed the minimum National Flood Insurance Program requirements. Broward County's participation in the CRS program requires an annual recertification of the activities that presently result in a 15% reduction in flood insurance policy premiums for properties in the unincorporated area. This report was prepared in accordance with the annual recertification requirements of the CRS.

## **Floodplain Management Plan**

The Broward County Enhanced Local Mitigation Strategy (ELMS) serves as the basis for the Broward Municipal Services District floodplain management plan. The ELMS was jointly developed by the County, municipalities and community stakeholders to reduce and/or eliminate risks associated with natural and man-made hazards. The ELMS was adopted by the Broward County Board of County Commissioners on February 5, 2013. Copies of the ELMS are available for review at the Broward Emergency Management Agency, 201 NW 84 Avenue, Plantation, Florida 33324 and the Broward.org/Emergency website (<http://www.broward.org/Emergency/Business/Documents/Broward%20County%20Enhanced%20LMS%20FINAL%20November%202012%20FINAL.pdf>). Appendix C of the ELMS contains a Mitigation Project List (MPL) that includes current and completed projects intended to mitigate local flood hazards within the unincorporated areas. The MPL list is updated annually and forwarded to the State every January. The most recent MPL was discussed at the LMS Quarterly Working Group meetings held on September 17, 2015, December 17, 2015, March 17, 2016 and June 29, 2016. Public notification of the quarterly meetings is published in accordance with Sunshine Laws to encourage public participation.

## **Flood Hazard Update**

There were no flood events or flooding impacts within the repetitive loss or other Broward Municipal Services District areas during the past year. Approximately 1,100 unincorporated area parcels, or 23% of parcels, are located within the special flood hazard area shown in the August 18, 2014, FEMA Flood Insurance Rate Maps (FIRM) for Broward County.

FEMA continued a multi-year coastal mapping study in Broward County that started in June 2014 by holding a Technical Update Meeting for Broward County on May 11, 2016. The study focuses on flooding conditions in coastal areas, including impacts from wave action and storm surge. When the study is completed in 2017, the results will be used by FEMA to update the current 2014 FIRM. Under the coastal study, FEMA expects to update the FIRM in the Boulevard Gardens, Franklin Park, Roosevelt Gardens, and Washington Park neighborhoods. The updated FIRM is expected by 2019.

## Progress of Broward Municipal Services District Floodplain Management Projects

The Hillsboro Pines, Hillsboro Ranches, Roosevelt Gardens, Washington Park, Franklin Park, Boulevard Gardens, and Broadview Park neighborhoods are located within Broward Municipal Services District (Exhibit 1). The unincorporated area floodplain management projects are:

- Hillsboro Pines Neighborhood Project
- North Central County Neighborhood Project
- Central County Neighborhood Project
- Broadview Park Neighborhood Project

### Hillsboro Pines Neighborhood Project

The Hillsboro Pines Neighborhood Project includes 173 homes on 132 acres and is bounded by the Hillsboro Canal to the north, Lyons Road to the east, NW 71 Place to the south and State Road 7 to the West. Improvements planned for this neighborhood include storm water drainage, roadways, landscaping improvements and related work. Construction began in June 2016 and is anticipated to be completed in June 2017. **COMMISSION DISTRICT 2**

Project Status: Construction Phase 30% Complete

Project Contact: Pat MacGregor, Broward County Water and Wastewater Services

#### Project Location Map



## North Central County Neighborhood Project

The North Central County Neighborhood Project (NCCNIP) includes roadway and sidewalk improvements, reconstruction of roadside swales, installation of an upgraded storm water piping network and new exfiltration trenches within the Roosevelt Gardens neighborhood. Construction began in late 2003 and was completed in 2012. **COMMISSION DISTRICT 9**

Project Status: Completed

Project Contact: Pat MacGregor, Broward County Water and Wastewater Services

### Project Location Map

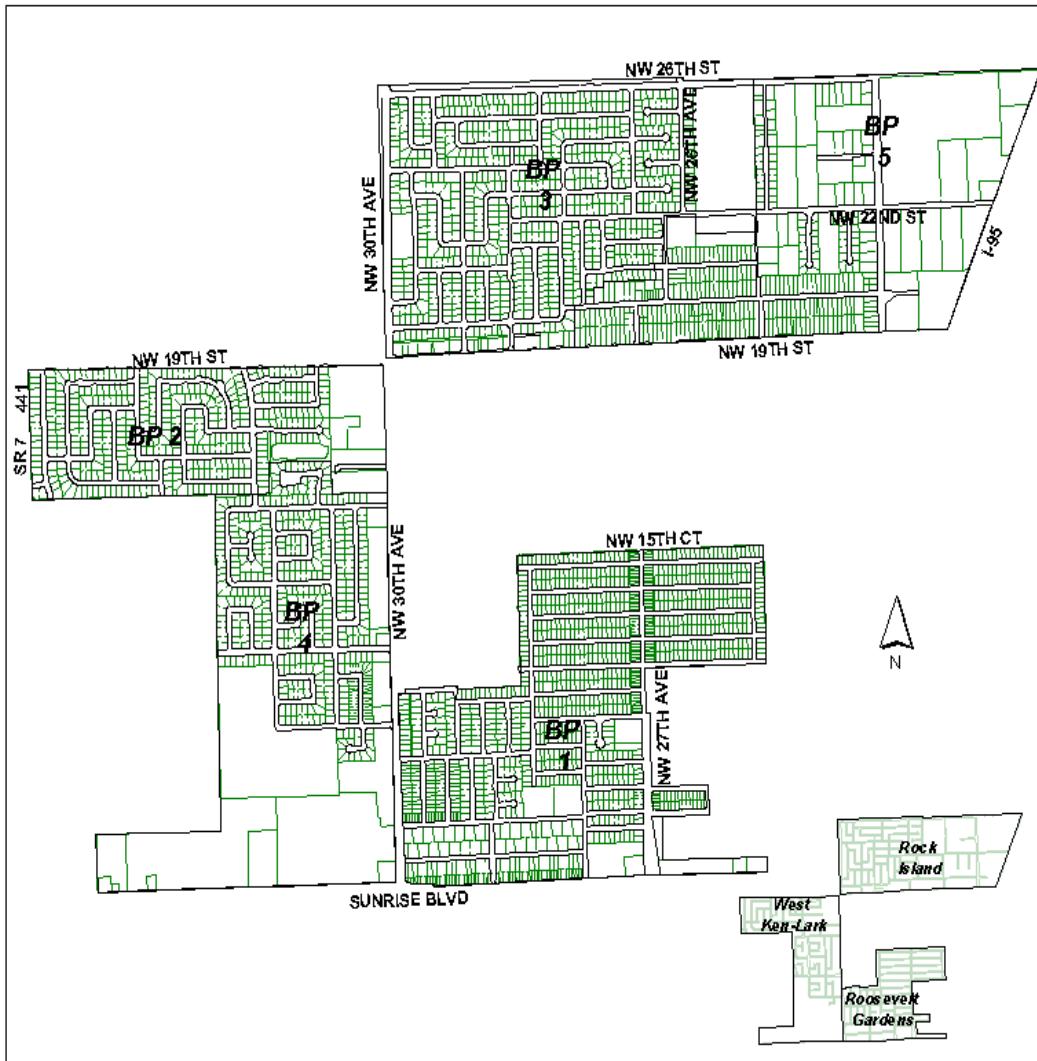

## Central County Neighborhood Project

The Central County Neighborhood Project (CCNP) includes improvements within the Franklin Park, Washington Park and Boulevard Gardens neighborhoods. The work consists of roadway and sidewalk improvements, reconstruction of roadside swales, installation of an upgraded storm water piping network and new exfiltration trenches. Construction began in 1999 and was completed in 2012.

### COMMISSION DISTRICT 9

Project Status: Completed

Project Contact: Pat MacGregor, Broward County Water and Wastewater Services

### Project Location Map

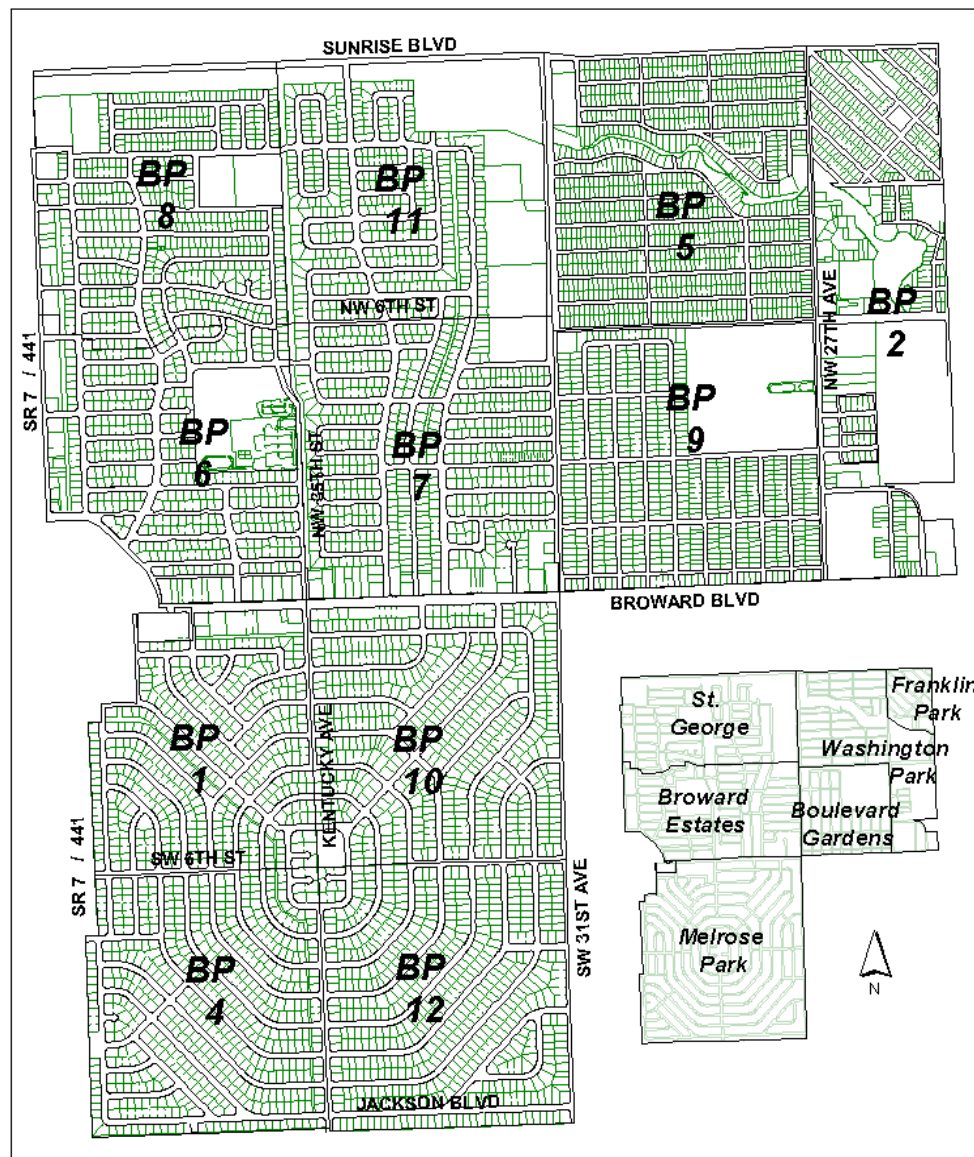

## Broadview Park Neighborhood Project

The Broadview Park Neighborhood Project includes approximately 700 acres, 1461 single family homes, 775 multi-family and mobile home units and 6800 residents. The work includes roadway and sidewalk improvements, reconstruction of roadside swales, installation of an upgraded storm water piping network and new exfiltration trenches. The project began in 2009 and was completed in 2012.

### COMMISSION DISTRICT 7

Project Status: Completed

Project Contact: Pat MacGregor, Broward County Water and Wastewater Services

### Project Location Map

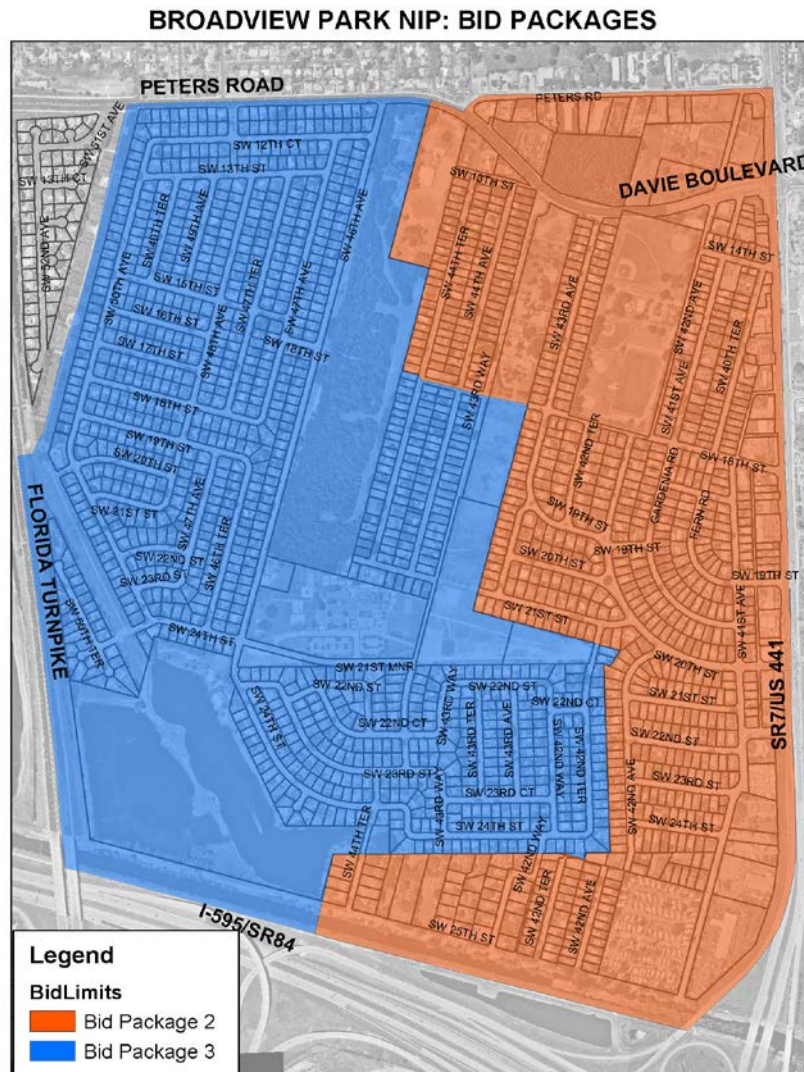

### **Summary**

Significant floodplain improvements have been achieved within the Broward Municipal Services District areas over the last six years. Storm water management system upgrades were completed in the Roosevelt Gardens, Franklin Park, Washington Park, Boulevard Gardens and Broadview Park neighborhoods. Similar improvements are anticipated to be completed within the Hillsboro Pines neighborhood in mid 2017. Upon completion of the floodplain improvement projects, the County will transition to maintenance and monitoring of the recently upgraded storm water management facilities.

The Broward County Emergency Management Division, Public Works Department and Environmental Licensing and Building Permitting Division will continue to use the ELMS to coordinate floodplain management activities within the Broward Municipal Services District.

